

**TOSHIBA**

# **SERVICE PARTS LIST**

**Job Separator**

**MJ-5014**

© 2016 TOSHIBA TEC CORPORATION All rights reserved

Under the copyright laws, this manual cannot be reproduced in any form without prior written permission of TOSHIBA TEC CORPORATION. No patent liability is assumed, however, with respect to the use of the information contained herein.

# CONTENTS

ASM-JSP .....	1
---------------	---



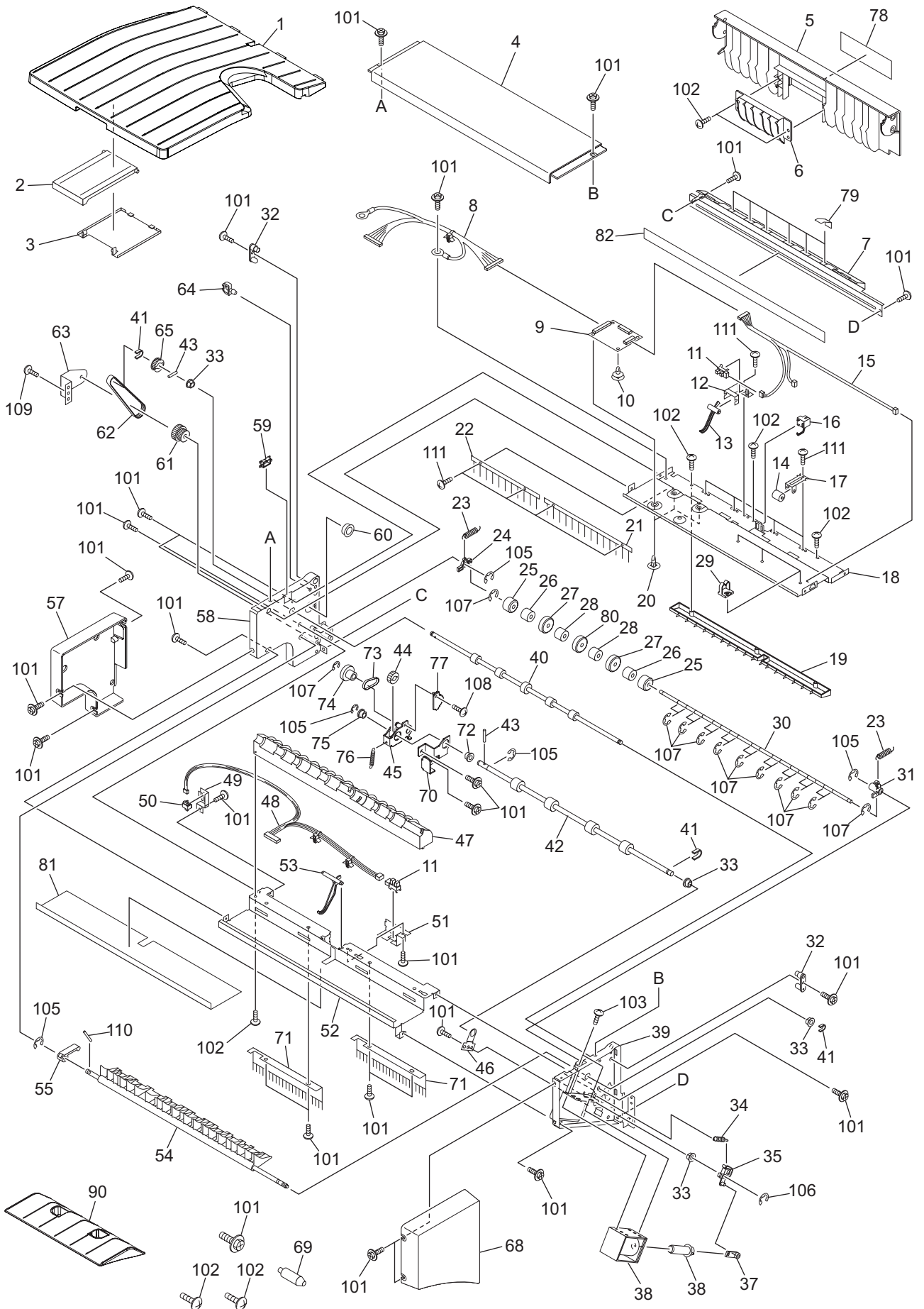

ITEM No.	PART No.	PART NAME	Q'TY / PAGE	Q'TY / PACK	REMARKS
1	6LA75679300	TRAY-JSP-B	1	1/PP	
2	41317150000	TRAY-SUB-JSP	1	1/PP	
3	6LA75680300	HLD-STOP-SUB_B	1	1/P	
4	6LA75686200	COV-TOP-JSP_B	1	1/PP	
5	6LA75685200	COV-RIGHT-OPEN_B	1	1/PP	
6	6LA75681200	GUIDE-COV-OPEN_B	1	1/P	
7	6LA75693200	ASYS-GUIDE-ENT-JSP3	1	1/PP	
8	6LA71363000	HRNS-JSP-RELAY-578	1	1/P	
9	6LA69885000	PWA-F-JSP-578	1	1/C	
11	C0-10813000	GP1A73ARJ00F	2	1/P	
12	6LA75640000	BRKT-SENS-FUL-U	1	1/P	
13	6LA75638000	ACT-FUL-U-N	1	1/P	
14	6LE69865000	ROL-IDL-ADU	4	5/P	
15	6LA71447000	HRNS-JSP-UP-578	1	1/P	
16	6LE09239000	SNSR-FED-390	1	1/P	
17	41317030000	SPL015-ROL-EX-U	4	1/P	
18	6LA75629000	STAY-UP-JSP	1	1/D	
19	41317045000	GUIDE-PAPER-U	1	1/P	
20	F0-00225000	KGLS-5RTV0	3	5/P	
21	41317036000	BRUSH-JSP-FRONT	1	1/KP	
22	41317037000	BRUSH-JSP-REAR	1	1/KP	
23	6LA75687000	SPG-E-4R9XR4X12R2	2	5/P	
24	41317170000	ARM-IDLE-R-JSP	1	1/P	
25	41306148000	ROLLER-EXIT	2	1/P	
26	41317124000	ROL-IDLE-140	2	1/P	
27	41317072000	ROL-COL-185	2	1/P	
28	41317176000	ROL-IDLE-145	2	1/P	
29	F0-00242000	MN-2	3	5/P	
30	41317122000	SHAFT-ROL-IDLE	1	1/P	
31	41317148000	ARM-IDLE-F-JSP	1	1/P	
32	41317015000	HINGE-COV-JAM	2	1/P	
33	4407734980	BUSH-6-GCB	4	5/P	
34	41317087000	SPE040-032-0127	1	5/P	
35	41317131000	LVR-SOL-JSP	1	1/P	
37	41317060000	ARM-SOL-JSP	1	1/P	
38	6LA75688000	SOL-GATE-524	1	1/D	
39	6LA75625000	ASYS-FRAME-FRONT-2	1	1/P	
40	41317121000	K-ROL-JSP-EX1	1	1/KP	
41	4407972860	STOP-RING-6-5	4	5/P	
42	6LA75650000	ASYS-ROL-JSP-EX3	1	1/KP	
43	X0-00979000	P/PRL/AH7-2X8-SS	2	10/P	
44	4400884670	PLY-20-ROL	1	1/P	
45	6LA75645000	ASYS-BRKT-RMV-JSP	1	1/P	
46	6LA75663000	BRKT-BUSH-F	1	1/P	
47	6LK70304000	ASYS-GUIDE-PAPER-L	1	1/PP	
48	6LA71361000	HRNS-JSP-COV-578	1	1/P	
49	6LA75630000	BRKT-SW-JAM-COV	1	1/P	
50	4402859600	SP-CS3A-B2BA	1	1/D	
51	6LA75660000	BRKT-SENS-FUL-L	1	1/P	
52	6LA75659000	STAY-LOW-JSP	1	1/D	
53	41317042000	ACT-FUL-L	1	1/P	
54	6LA75657000	FLP-C-ROL-JSP	1	1/PP	
55	41317127000	LINK-GATE-JSP	1	1/P	
57	6LA75677200	COV-REAR-JSP_B	1	1/P	
58	6LA75622000	ASYS-FRAME-REAR	1	1/P	
59	F0-01248000	ESC-0912	1	10/P	
60	F0-00862000	TB-1116	1	5/P	
61	41317014000	GR/PLY-JSP	1	1/P	
62	41317054000	BLT/T-240-2GT-5	1	1/P	
63	6LA75644000	BRKT-GEAR-REAR	1	1/P	
64	F0-00043000	UAMS-05SN-W	1	5/P	
65	41317051000	PLY/T-2GT020-6F	1	1/P	
68	6LA75676200	COV-FRONT-JSP_B	1	1/P	









**TOSHIBA**

**TOSHIBA TEC CORPORATION**

1-11-1, OSAKI, SHINAGAWA-KU, TOKYO, 141-8562, JAPAN