

PSU FUSE Table

Symbol	Designation	Rating
CP01	DOMINA	15A 250VAC/250Vdc
FU01	DOMINA	15A 250Vdc
EQ0A0RN	TS 361 250Vdc	
FU02	ALL	12A 250Vdc
FU01	DOMINA	15A 250Vdc
EQ0A0RN	TS 361 250Vdc	
FU01	ALL	15A 250Vdc
FU02	ALL	15A 250Vdc
FU03	ALL	15A 250Vdc

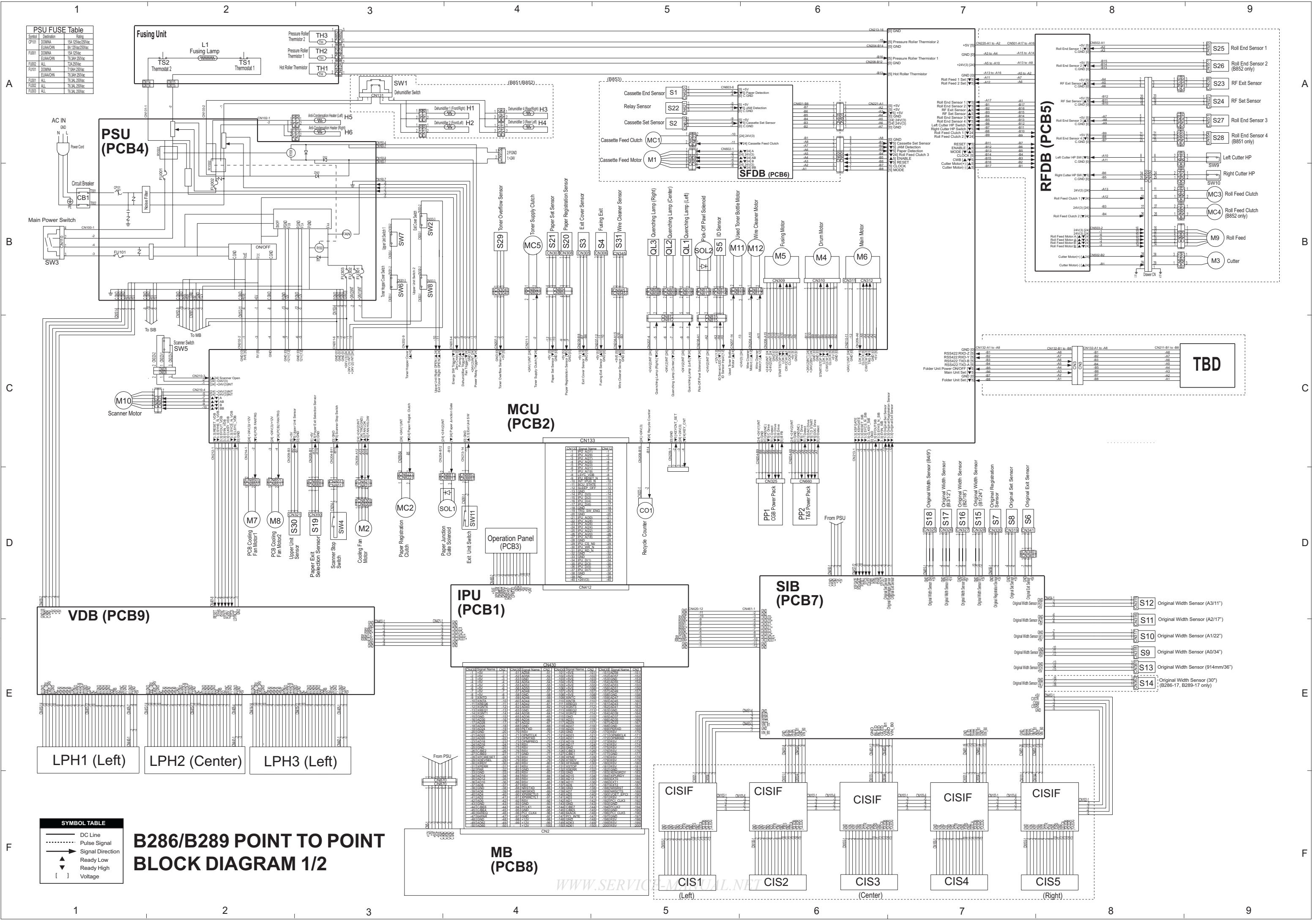

SYMBOL TABLE

- DC Line
- Pulse Signal
- Signal Direction
- ▲ Ready Low
- ▼ Ready High
- [] Voltage

B286/B289 POINT TO POINT BLOCK DIAGRAM 1/2

A

B

C

D

E

F

A

B

C

D

E

F

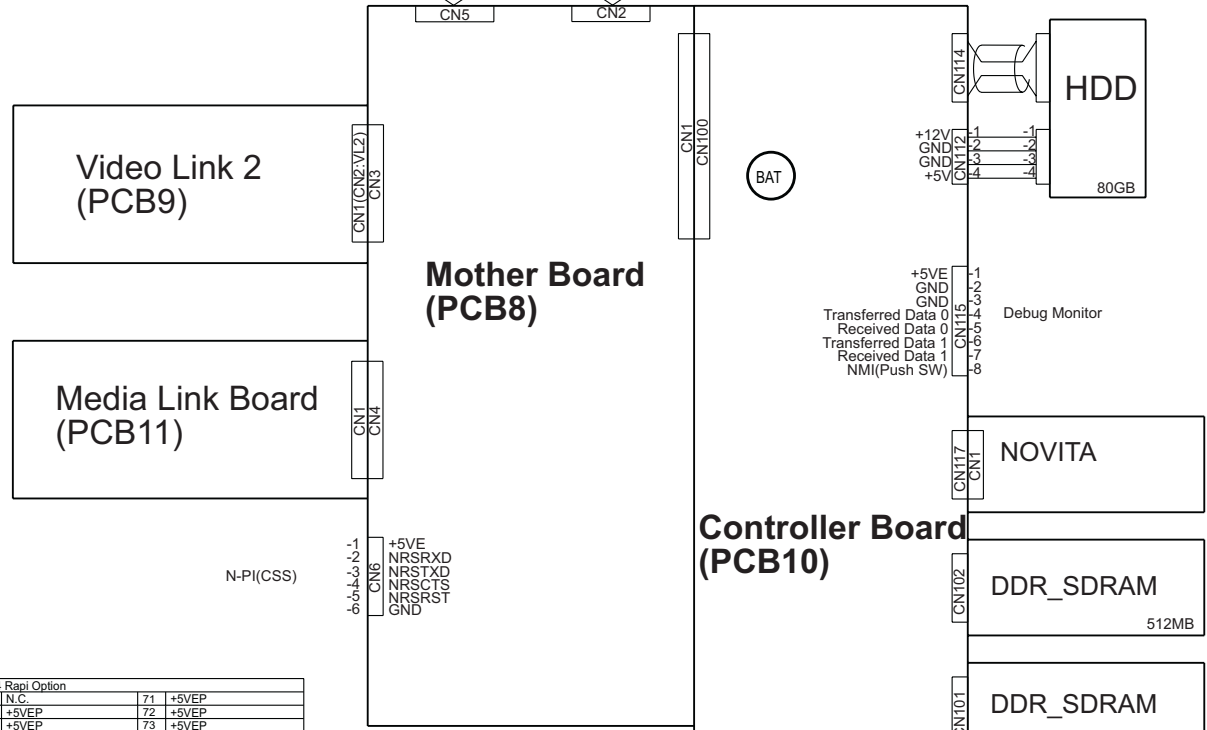
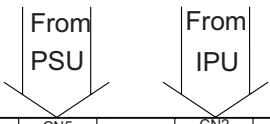

CN101, CN102 DDR_SDRAM		CN1-CN100 MB-CTL	
1 +1.25VEP_VREF	51 GND	101 A9	151 DO42
2 +1.25VEP_VREF	52 GND	102 A8	152 DO43
3 GND	53 DO19	103 GND	153 DO44
4 GND	54 DO23	104 GND	154 DO47
5 DQ0	55 DO24	105 A7	155 +2.5VEP
6 DQ4	56 DO28	106 A6	156 +2.5VEP
7 DQ1	57 +2.5VEP	107 A5	157 +2.5VEP
8 DQ5	58 +2.5VEP	108 A4	158 CLK4_N
9 +2.5VEP	59 DO25	109 A3	159 GND
10 +2.5VEP	60 DO29	110 A2	160 CLK4
11 DQS0	61 DQS3	111 A1	161 GND
12 DQM0	62 DQM3	112 A0	162 GND
13 DQ2	63 GND	113 +2.5VEP	163 DO48
14 DQ6	64 GND	114 +2.5VEP	164 DO49
15 GND	65 DO26	115 A10	165 DO49
16 GND	66 DO30	116 A14	166 DO53
17 DQ3	67 DO27	117 A13	167 +2.5VEP
18 DQ7	68 DQ31	118 RAS_N	168 +2.5VEP
19 DQ8	69 +2.5VEP	119 WE_N	169 DQ56
20 DQ12	70 +2.5VEP	120 CAS_N	170 DQM6
21 +2.5VEP	71 N.C.	121 CS2_N	171 DO50
22 +2.5VEP	72 N.C.	122 CS3_N	172 DO54
23 DQ8	73 N.C.	123 N.C.	173 GND
24 DQ13	74 N.C.	124 N.C.	174 GND
25 DQS1	75 GND	125 GND	175 DQ51
26 DQM1	76 GND	126 GND	176 DO55
27 GND	77 N.C.	127 DO32	177 DO56
28 GND	78 N.C.	128 DO36	178 DO60
29 DQ10	79 N.C.	129 DO33	179 +2.5VEP
30 DQ14	80 N.C.	130 DQ37	180 +2.5VEP
31 DQ11	81 +2.5VEP	131 +2.5VEP	181 DO57
32 DQ15	82 +2.5VEP	132 +2.5VEP	182 DO61
33 +2.5VEP	83 N.C.	133 DQ54	183 DO57
34 +2.5VEP	84 N.C.	134 DQM4	184 DO57
35 CLK3	85 N.C.	135 DO34	185 GND
36 +2.5VEP	86 N.C.	136 DQ38	186 GND
37 CLK3_N	87 GND	137 GND	187 DO58
38 GND	88 GND	138 GND	188 DO62
39 GND	89 N.C.	139 DQ35	189 DO59
40 GND	90 GND	140 DQ39	190 DO63
41 DQ16	91 N.C.	141 DQ40	191 +2.5VEP
42 DQ20	92 +2.5VEP	142 DQ44	192 +2.5VEP
43 DQ17	93 +2.5VEP	143 +2.5VEP	193 I2CC
44 DQ21	94 +2.5VEP	144 +2.5VEP	194 +2.5VEP
45 +2.5VEP	95 CKE1	145 DQ41	195 I2CC
46 +2.5VEP	96 CKE0	146 DO45	196 GND
47 DQS2	97 N.C.	147 DQS5	197 +2.5VEP
48 DQM2	98 N.C.	148 DQM5	198 GND
49 DQ18	99 A12	149 GND	199 N.C.
50 DQ22	100 A11	150 GND	200 N.C.

CN1-CN100 MB-CTL		CN109 to 110 Board Slot	
1 +5V	51 AD56	101 +5VE	151 AD59
2 +5V	52 AD56	102 +5VE	152 AD57
3 +5V	53 GND	103 +5VE	153 GND
4 +5V	54 AD54	104 +5VE	154 AD55
5 +5V	55 AD52	105 +5VE	155 AD53
6 +5V	56 AD50	106 +5VE	156 AD51
7 +5V	57 AD48	107 +5VE	157 AD49
8 +5V	58 GND	108 +5VE	158 GND
9 XINTD	59 AD46	109 XINTC	159 AD47
10 XINTA	60 AD44	110 XINTB	160 AD45
11 XRE06	61 AD42	111 XRE03	161 AD43
12 XGNT6	62 AD40	112 XGNT3	162 AD41
13 XRE01	63 GND	113 XRE02	163 GND
14 XGNT1	64 AD38	114 XGNT2	164 AD39
15 GND	65 AD36	115 GND	165 AD37
16 AD30	66 AD34	116 AD31	166 AD35
17 AD28	67 AD32	117 AD29	167 AD33
18 AD26	68 GND	118 AD27	168 GND
19 AD24	69 PEXD	119 AD25	169 PERXD
20 GND	70 RSV	120 GND	170 RSV
21 AD22	71 OPMTCLK	121 AD23	171 OPMRCLK
22 AD20	72 OPMTXD	122 AD21	172 OPMRXD
23 AD18	73 OPMPREQ	123 AD19	173 RSV
24 AD16	74 RSV	124 AD17	174 RSV
25 GND	75 RSV	125 GND	175 RSV
26 C/BE2	76 RSV	126 C/BE3	176 RSV
27 C/BE0	77 GND	127 C/BE1	177 GND
28 XPC/RESET	78 RSV	128 XPME	178 RSV
29 XDEVSEL	79 RSV	129 XTRDY	179 RSV
30 XIRDY	80 RSV	130 XFRAME	180 RSV
31 XPERR	81 RSV	131 XSTOP	181 RSV
32 GND	82 GND	132 XSERR	182 GND
33 GND	83 RSV	133 GND	183 XENGRDY
34 AD14	84 RSV	134 AD15	184 XIPURDY
35 AD12	85 RSV	135 AD13	185 EXT0
36 AD10	86 RSV	136 AD11	186 EXT1
37 AD8	87 RSV	137 AD9	187 EXT2
38 GND	88 NRSTXD	138 GND	188 NRSRST
39 AD6	89 NRSRXD	139 AD7	189 NRSCSTS
40 AD4	90 XPWRCLK0	140 AD5	190 VOET_EPCI
41 AD2	91 XPWRCLK1	141 AD3	191 RSV
42 AD0	92 RSV	142 AD1	192 PCI_CLK3
43 GND	93 GND	143 GND	193 GND
44 C/BE6	94 PCLK1	144 C/BE7	194 PCLK2
45 C/BE4	95 GND	145 C/BE5	195 GND
46 64REQ	96 PCI_CLK4	146 64ACK	196 PCI_CLK5
47 64PAR	97 GND	147 PCI_INTE	197 GND
48 GND	98 +12V	148 GND	198 +12V
49 AD62	99 +12V	149 AD63	199 +12V
50 AD60	100 +12V	150 AD61	200 +12V

CN3 Rapo Option	
1 N.C.	71 +5VEP
2 +5VEP	72 +5VEP
3 +5VEP	73 +5VEP
4 GND	74 GND
5 RSV	75 RSV
6 RSV	76 RSV
7 RSV	77 RSV
8 PCI REQ2	78 IDSEL2
9 PCI GN72	79 RSV
10 GND	80 GND
11 PCI INTB	81 RSV
12 XPME	82 RSV
13 GND	83 GND
14 PCI CLK2	84 RSV
15 GND	85 GND
16 RSV	86 PCI RSTB
17 RSV	87 (PCI GN7B)
18 PCI AD30	88 PCI AD31
19 PCI AD28	89 PCI AD29
20 GND	90 GND
21 PCI AD26	91 PCI AD27
22 PCI AD24	92 PCI AD25
23 RSV	93 PCI CBE3
24 PCI AD22	94 PCI AD23
25 GND	95 GND
26 PCI AD20	96 PCI AD21
27 PCI AD18	97 PCI AD19
28 PCI AD16	98 PCI AD17
29 PCI FRAMEB	99 PCI CBE2
30 GND	100 GND
31 PCI IRDYB	101 PCI IRDYB
32 PCI STOPB	102 PCI DEVSELB
33 PCI SERRB	103 PCI PERRB
34 PCI CBE1	104 PCI PAR
35 GND	105 GND
36 PCI AD14	106 PCI AD15
37 PCI AD12	107 PCI AD13
38 PCI AD10	108 PCI AD11
39 PCI AD8	109 PCI AD9
40 GND	110 GND
41 PCI AD7	111 PCI CBE0
42 PCI AD5	112 PCI AD6
43 PCI AD3	113 PCI AD4
44 PCI AD1	114 PCI AD2
45 GND	115 GND
46 PCI ACK64	116 PCI AD0
47 PCI CBE7	117 PCI REQ64
48 PCI CBE5	118 PCI CBE6
49 PCI PAR64	119 PCI CBE4
50 GND	120 GND
51 PCI AD62	121 PCI AD63
52 PCI AD60	122 PCI AD61
53 PCI AD58	123 PCI AD59
54 PCI AD56	124 PCI AD57
55 GND	125 GND
56 PCI AD54	126 PCI AD55
57 PCI AD52	127 PCI AD53
58 PCI AD50	128 PCI AD51
59 PCI AD48	129 PCI AD49
60 GND	130 GND
61 PCI AD46	131 PCI AD47
62 PCI AD44	132 PCI AD45
63 PCI AD42	133 PCI AD43
64 PCI AD40	134 PCI AD41
65 GND	135 GND
66 PCI AD38	136 PCI AD39
67 PCI AD36	137 PCI AD37
68 PCI AD34	138 PCI AD35
69 PCI AD32	139 PCI AD33
70 GND	140 GND

CN4 Rapo Option	
1 N.C.	71 +5VEP
2 +5VEP	72 +5VEP
3 +5VEP	73 +5VEP
4 GND	74 GND
5 RSV	75 RSV
6 RSV	76 RSV
7 RSV	77 RSV
8 PCI REQ3	78 IDSEL 6
9 PCI GN73	79 RSV
10 GND	80 GND
11 PCI INTC	81 RSV
12 XPME	82 RSV
13 GND	83 GND
14 PCI CLK3	84 RSV
15 GND	85 GND
16 RSV	86 PCI RSTB
17 RSV	87 (PCI GN7B)
18 PCI AD30	88 PCI AD31
19 PCI AD28	89 PCI AD29
20 GND	90 GND
21 PCI AD26	91 PCI AD27
22 PCI AD24	92 PCI AD25
23 RSV	93 PCI CBE3
24 PCI AD22	94 PCI AD23
25 GND	95 GND
26 PCI AD20	96 PCI AD21
27 PCI AD18	97 PCI AD19
28 PCI AD16	98 PCI AD17
29 PCI FRAMEB	99 PCI CBE2
30 GND	100 GND
31 PCI IRDYB	101 PCI IRDYB
32 PCI STOPB	102 PCI DEVSELB
33 PCI SERRB	103 PCI PERRB
34 PCI CBE1	104 PCI PAR
35 GND	105 GND
36 PCI AD14	106 PCI AD15
37 PCI AD12	107 PCI AD13
38 PCI AD10	108 PCI AD11
39 PCI AD8	109 PCI AD9
40 GND	110 GND
41 PCI AD7	111 PCI CBE0
42 PCI AD5	112 PCI AD6
43 PCI AD3	113 PCI AD4
44 PCI AD1	114 PCI AD2
45 GND	115 GND
46 PCI ACK64	116 PCI AD0
47 PCI CBE7	117 PCI REQ64
48 PCI CBE5	118 PCI CBE6
49 PCI PAR64	119 PCI CBE4
50 GND	120 GND
51 PCI AD62	121 PCI AD63
52 PCI AD60	122 PCI AD61
53 PCI AD58	123 PCI AD59
54 PCI AD56	124 PCI AD57
55 GND	125 GND
56 PCI AD54	126 PCI AD55
57 PCI AD52	127 PCI AD53
58 PCI AD50	128 PCI AD51
59 PCI AD48	129 PCI AD49
60 GND	130 GND
61 PCI AD46	131 PCI AD47
62 PCI AD44	132 PCI AD45
63 PCI AD42	133 PCI AD43
64 PCI AD40	134 PCI AD41
65 GND	135 GND
66 PCI AD38	136 PCI AD39
67 PCI AD36	137 PCI AD37
68 PCI AD34	138 PCI AD35
69 PCI AD32	139 PCI AD33
70 GND	140 GND

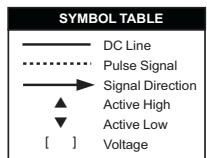

B286/B289 POINT TO POINT BLOCK DIAGRAM 2/2

ELECTRICAL COMPONENT LAYOUT (B286/B289)

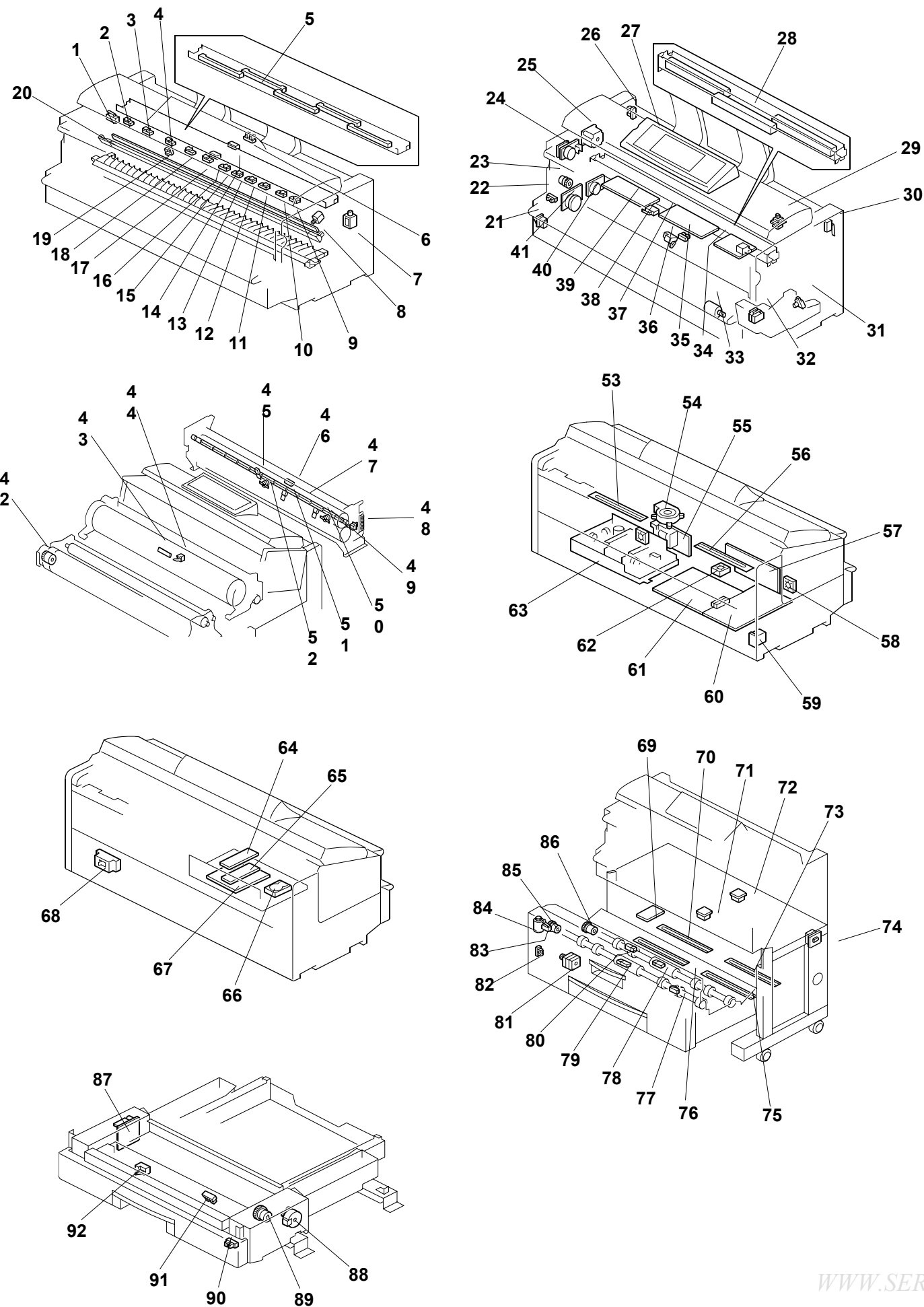

Symbol	Index No.	Description	P to P
CIS			
CIS1 - 5	5	CIS 1 - 5 (Contact Image Sensor)	F5-8 (1/2)
Lamp			
L1	47	Fusing Lamp	A2 (1/2)
LPH			
LPH1 - 3	28	LPH1 - 3 (LED Print Head)	E1-3 (1/2)
Magnetic Clutches			
MC1	89	Cassette Feed Clutch	A5 (1/2)
MC2	23	Paper Registration Clutch	D3 (1/2)
MC3	85	Roll Feed Clutch 1	B9 (1/2)
MC4	86	Roll Feed Clutch 2	B9 (1/2)
MC5	42	Toner Supply Clutch	B4 (1/2)
Motors			
M1	88	Cassette Feed Motor	A5 (1/2)
M2	54	Cooling Fan Motor	D3 (1/2)
M3	84	Cutter Motor	B9 (1/2)
M4	24	Drum Motor	B6 (1/2)
M5	40	Fusing Motor	B6 (1/2)
M6	41	Main Motor	B6 (1/2)
M7	58	PCB Cooling Fan Motor1	D2 (1/2)
M8	62	PCB Cooling Fan Motor2	D2 (1/2)
M9	81	Roll Feed Motor	B9 (1/2)
M10	25	Scanner Motor	C1 (1/2)
M11	33	Used Toner Bottle Motor	B6 (1/2)
M12	8	Wire Cleaner Motor	B6 (1/2)
PCB			
PCB1	60	IPU (Image Processing Unit)	E4 (1/2)
PCB2	61	MCU (Main Control Unit)	C4 (1/2)
PCB3	27	Operation Panel	D4 (1/2)
PCB4	63	PSU (Power Supply Unit)	A1 (1/2)
PCB5	69	RFDB (Roll Feed Drive Board)	B8 (1/2)
PCB6	87	SFDB (Sheet Feed Drive Board)	A6 (1/2)
PCB7	37	SIB (Scanner Interface Board)	E6 (1/2)
PCB8	57	Mother Board	F4 (1/2)
PCB9	39	VDB (Video Drive Board)	E1 (1/2)
PCB10	67	Controller Board	C13 (2/2)
PCB11	64	Interface Board	B11 (2/2)
PCB12	65	File Format Converter (MLB)	B11 (2/2)
Power Packs			
PP1	34	CGB Power Pack	D6 (1/2)
PP2	55	T&S Power Pack	D6 (1/2)
QL			
QL1 - 3	20	Quenching Lamp (1:Left, 2:Center, 3:Right)	B5 (1/2)

Symbol	Index No.	Description	P to P
Others			
CO1	59	Recycle Counter	D5 (1/2)
H1	75	Dehumidifier 1 (Front/Right)	A4 (1/2)
H2	76	Dehumidifier 2 (Front/Left)	A4 (1/2)
H3	70	Dehumidifier 3 (Rear/Right)	A4 (1/2)
H4	73	Dehumidifier 4 (Rear/Left)	A4 (1/2)
H5	56	Anti-Condensation Heater (Left)	A3 (1/2)
H6	53	Anti-Condensation Heater (Right)	A3 (1/2)
HDD1	66	HDD	B14 (2/2)
TH1	45	Hot Roller Thermistor	A3 (1/2)
TH2	50	Pressure Roller Thermistor 1 (End)	A3 (1/2)
TH3	51	Pressure Roller Thermistor 2 (Center)	A3 (1/2)
TS1	52	Thermostat 1 (199°C)	A2 (1/2)
TS2	49	Thermostat 2 (200°C)	A2 (1/2)
CB1	68	Circuit Breaker	B1 (1/2)

Symbol	Index No.	Description	P to P
Sensors			
S1	91	Cassette End Sensor	A5 (1/2)
S2	90	Cassette Set Sensor	A5 (1/2)
S3	26	Exit Cover Sensor	B4 (1/2)
S4	46	Fusing Exit Sensor	B5 (1/2)
S5	43	ID Sensor	B5 (1/2)
S6	14	Original Exit Sensor	D7 (1/2)
S7	16	Original Registration Sensor	D7 (1/2)
S8	17	Original Set Sensor (A4/8.5" SEF)	D7 (1/2)
S9	10	Original Width Sensor (A0/34")	E8 (1/2)
S10	12	Original Width Sensor (A1/22")	E8 (1/2)
S11	13	Original Width Sensor (A2/17")	D8 (1/2)
S12	15	Original Width Sensor (A3/11")	D8 (1/2)
S13	9	Original Width Sensor (914mm/36")	E8 (1/2)
S14	11	Original Width Sensor (30")	E8 (1/2)
S15	2	Original Width Sensor (B1/24")	D7 (1/2)
S16	3	Original Width Sensor (B2/18")	D7 (1/2)
S17	4	Original Width Sensor (B3/12")	D7 (1/2)
S18	18	Original Width Sensor (B4/9")	D7 (1/2)
S19	6	Paper Exit Selection Sensor	D3 (1/2)
S20	35	Paper Registration Sensor	B4 (1/2)
S21	36	Paper Set Sensor	B4 (1/2)
S22	92	Relay Sensor	A5 (1/2)
S23	80	RF Exit Sensor	A9 (1/2)
S24	82	RF Set Sensor	A9 (1/2)
S25	71	Roll End Sensor 1	A9 (1/2)
S26	72	Roll End Sensor 2	A9 (1/2)
S27	79	Roll End Sensor 3	A9 (1/2)
S28	78	Roll End Sensor 4	A9 (1/2)
S29	31	Toner Overflow Sensor	B4 (1/2)
S30	22	Upper Unit Sensor	D2 (1/2)
S31	19	Wire Cleaner Sensor	B5 (1/2)
Solenoids			
SOL1	7	Paper Junction Gate Solenoid	D3 (1/2)
SOL2	44	Pick-Off Pawl Solenoid	B5 (1/2)
Switches			
SW1	74	Dehumidifier Switch	A3 (1/2)
SW2	30	Exit Cover Switch	B3 (1/2)
SW3	21	Main Power Switch	B1 (1/2)
SW4	29	Scanner Stop Switch	D3 (1/2)
SW5	1	Scanner Switch	C2 (1/2)
SW6	38	Toner Hopper Cover Switch	B3 (1/2)
SW7	32	Upper Unit Switch 1	B3 (1/2)
SW8	32	Upper Unit Switch 2	B3 (1/2)
SW9	83	Left Cutter HP Switch	A9 (1/2)
SW10	77	Right Cutter HP Switch	B9 (1/2)
SW11	48	Exit Unit Switch	D4 (1/2)