

Chapter 4 Plug/Jack(P/J) Connector Locations CONTENTS

1. Connector [P (plug) / J (jack)].....4 - 1

 1.1 List of P/J 4 - 1

 1.2 IOT P/J layout diagram 4 - 5

 1.3 DUPLEX P/J layout diagram..... 4 - 9

 1.4 OPTION FEEDER P/J layout diagram..... 4 - 10

1. Connector [P (plug) / J (jack)]

1.1 List of P/J

IOT

P/J	Coordinates	Remarks
3	E-138	Connects ELECTRONIC SUB-SYSTEM CONTROL BOARD and HARD DISK
10	J-157	Connects MACHINE CONTROL UNIT and IF Harness Assembly
12	J-157	Connects MACHINE CONTROL UNIT and ROS Harness Assembly
13	I-157	Connects MACHINE CONTROL UNIT and LV TOP Harness Assembly
14	J-157	Connects MACHINE CONTROL UNIT and LV TOP Harness Assembly
15	I-157	Connects MACHINE CONTROL UNIT and LV TOP Harness Assembly
16	I-157	Connects MACHINE CONTROL UNIT and HIGH VOLTAGE POWER SUPPLY
16	F-138	Connects ELECTRONIC SUB-SYSTEM CONTROL BOARD and NETWORK PROTOCOL ADAPTER
17	I-157	Connects MACHINE CONTROL UNIT and FUSER Harness Assembly
18	I-157	Connects MACHINE CONTROL UNIT and LV TOP Harness Assembly
19	I-157	Connects MACHINE CONTROL UNIT and CRU SNR Harness Assembly
20	J-158	Connects MACHINE CONTROL UNIT and DRIVE ASSY K (K SNR Harness Assembly)
22	I-158	Connects MACHINE CONTROL UNIT and R SIDE Harness Assembly
23	I-159	Connects MACHINE CONTROL UNIT and R SIDE Harness Assembly
24	I-159	Connects MACHINE CONTROL UNIT and R SIDE Harness Assembly
25	I-158	Connects MACHINE CONTROL UNIT and R SIDE Harness Assembly
26	J-159	Connects MACHINE CONTROL UNIT and HUM Harness Assembly
27	I-159	Connects MACHINE CONTROL UNIT and R SIDE Harness Assembly
28	I-159	Connects MACHINE CONTROL UNIT and R SIDE Harness Assembly
29	J-159	Connects MACHINE CONTROL UNIT and R SIDE Harness Assembly
29	F-138	Connects ELECTRONIC SUB-SYSTEM CONTROL BOARD and ESS Harness Assembly
30	I-159	Connects MACHINE CONTROL UNIT and R SIDE Harness Assembly
31	J-159	Connects MACHINE CONTROL UNIT and CRUM Harness Assembly
40	F-149	Connects LOW VOLTAGE POWER SUPPLY and LV TOP Harness Assembly
44	E-149	Connects LOW VOLTAGE POWER SUPPLY and INTERLOCK SWITCH
47	E-150	Connects LOW VOLTAGE POWER SUPPLY and FUSER Harness Assembly
48	E-150	Connects LOW VOLTAGE POWER SUPPLY and AC IN Harness Assembly
101	F-138	Connects ELECTRONIC SUB-SYSTEM CONTROL BOARD and IF Harness Assembly
101	I-158	Not Connects (Debug only)
111	F-139	Connects ELECTRONIC SUB-SYSTEM CONTROL BOARD and IF Harness Assembly
141	I-136	Connects LED ASSEMBLY and LV TOP Harness Assembly
144	C-108	Connects PWBA EEPROM (BELT) and BELT Harness Assembly (TRANSFER BELT)
144	D-153	Connects PWBA EEPROM (XPRO) and R SIDE Harness Assembly
151	H-122	Connects ROS and ROS Harness Assembly
161	G-136	Connects HIGH VOLTAGE POWER SUPPLY and MACHINE CONTROL UNIT

P/J	Coordinates	Remarks
171	H-106	Connects FUSER and FUSER Harness Assembly
181	I-139	Connects TONER DISPENSER (Y) and LV TOP Harness Assembly
182	H-138	Connects TONER DISPENSER (M) and LV TOP Harness Assembly
183	H-136	Connects TONER DISPENSER (K) and LV TOP Harness Assembly
184	H-137	Connects TONER DISPENSER (C) and LV TOP Harness Assembly
191	H-124	Connects TONER CARTRIDGE SENSOR ASSEMBLY (Y) and CRU SNR Harness Assembly
192	H-124	Connects TONER CARTRIDGE SENSOR ASSEMBLY (M) and CRU SNR Harness Assembly
193	H-122	Connects TONER CARTRIDGE SENSOR ASSEMBLY (K) and CRU SNR Harness Assembly
194	H-123	Connects TONER CARTRIDGE SENSOR ASSEMBLY (C) and CRU SNR Harness Assembly
201	H-108	Connects DRIVE ASSY K (K Mode Sensor) and K SNR Harness Assembly
220	D-105	Connects OPERATOR PANEL and OPEPANE Harness Assembly
221	H-108	Connects PHOTOCONDUCTOR (PC) / DEVELOPER (DEV) DRIVE (Sub Motor) and R SIDE Harness Assembly
222	G-109	Connects PHOTOCONDUCTOR (PC) / DEVELOPER (DEV) DRIVE (Main Motor) and R SIDE Harness Assembly
231	I-124	Connects INTEGRATED FEEDER ASSEMBLY (REGI Clutch) and R SIDE Harness Assembly
232	H-124	Connects INTEGRATED FEEDER ASSEMBLY (Turn Clutch) and R SIDE Harness Assembly
233	H-123	Connects INTEGRATED FEEDER ASSEMBLY (CST Feed Clutch) and R SIDE Harness Assembly
234	H-111	Connects MPF FEED SOLENOID and R SIDE Harness Assembly
235	I-107	Connects PHOTOCONDUCTOR (PC) / DEVELOPER (DEV) DRIVE (Exit Clutch) and R SIDE Harness Assembly
241	I-109	Connects DRIVE ASSY K (K Mode Solenoid) and R SIDE Harness Assembly
251	H-110	Connects FEED DRIVE ASSEMBLY (PH Motor) and R SIDE Harness Assembly
261	H-152	Connects HUMIDITY SENSOR and HUM Harness Assembly
272	I-110	Connects FRONT COVER Harness Assembly and R SIDE Harness Assembly
281	H-126	Connects R SIDE Harness Assembly and 550 SHEET FEEDER ASSEMBLY (FDR UNIT Harness Assembly)
282	I-109	Connects MSI NPP Harness Assembly and R SIDE Harness Assembly
291	I-125	Connects SIZE SWITCH ASSEMBLY and R SIDE Harness Assembly
292	H-125	Connects INTEGRATED FEEDER ASSEMBLY (REGI SNR Harness Assembly) and R SIDE Harness Assembly
301	H-124	Connects INTEGRATED FEEDER ASSEMBLY (TEN SNR Harness Assembly) and R SIDE Harness Assembly
311	G-124	Connects CRUM Sensor (Y) and CRUM Harness Assembly
312	G-123	Connects CRUM Sensor (M) and CRUM Harness Assembly
313	G-122	Connects CRUM Sensor (C) and CRUM Harness Assembly
314	G-122	Connects CRUM Sensor (K) and CRUM Harness Assembly
401	F-138	Connects ELECTRONIC SUB-SYSTEM CONTROL BOARD and LV TOP Harness Assembly
482	E-153	Connects BREAKER GFI INLET and AC IN Harness Assembly
483	E-154	Connects BREAKER GFI INLET and AC IN Harness Assembly

P/J	Coordinates	Remarks
501	F-149	Connects LOW VOLTAGE POWER SUPPLY and LV TOP Harness Assembly
502	F-149	Connects LOW VOLTAGE POWER SUPPLY and LV TOP Harness Assembly
503	F-149	Connects LOW VOLTAGE POWER SUPPLY and FAN
504	F-149	Connects LOW VOLTAGE POWER SUPPLY and LV TOP Harness Assembly
2411	F-125	Connects INTEGRATED FEEDER ASSEMBLY (PWBA TEN SNR) and TEN SNR Harness Assembly
2721	B-107	Connects TRANSFER BELT and FRONT COVER Harness Assembly
2821	E-110	Connects MSI No Paper Sensor and MSI NPP Harness Assembly
2900	I-110	Connects OPEPANE Harness Assembly and ESS Harness Assembly
2921	D-125	Connects INTEGRATED FEEDER ASSEMBLY (CST No Paper Sensor) and REGI SNR Harness Assembly
2922	E-125	Connects INTEGRATED FEEDER ASSEMBLY (REGI Sensor) and REGI SNR Harness Assembly
5041	F-138	Not Connects (Used in production process only)
27212	D-106	Connects ADC Sensor and BELT Harness Assembly (TRANSFER BELT)
27213	D-107	Connects ADC Solenoid and BELT Harness Assembly (TRANSFER BELT)

DUP

P/J	Coordinates	Remarks
1	E-168	Not Connects (Debug only)
427	F-168	Connects PWBA DUP and FAN DUP
428	F-168	Connects PWBA DUP and DUP UNIT Harness Assembly
429	F-169	Connects PWBA DUP and MOTOR ASSY DUP
430	F-168	Connects PWBA DUP and DUP SNR Harness Assembly
431	F-168	Connects PWBA DUP and DUP Clutch
2720	I-169	Connects DUPLEX MODULE (DUP UNIT Harness Assembly) and PRINTER
4301	E-167	Connects DUP Jam Sensor and DUP SNR Harness Assembly

OPT FEEDER

P/J	Coordinates	Remarks
1	G-180	Not Connects (Debug only)
281	H-183	Connects 550 SHEET FEEDER ASSEMBLY (FDR UNIT Harness Assembly) and PRINTER
419	G-180	Connects PWBA OPT FDR and FDR UNIT Harness Assembly
420	G-180	Connects PWBA OPT FDR and C2 TURN Harness Assembly
421	G-179	Connects PWBA OPT FDR and C2 CHUTE Harness Assembly
422	G-179	Connects PWBA OPT FDR and C2 MOT Harness Assembly
423	G-180	Not Connects
4201	H-185	Connects C2 TURN CLUTCH and C2 TURN Harness Assembly
4202	H-185	Not Connects
4211	I-184	Connects SWITCH ASSY SIZE OPT and C2 CHUTE Harness Assembly
4212	H-184	Connects C2 CHUTE Harness Assembly and C2 NO PAPER Harness Assembly
4213	H-185	Connects C2 FEED CLUTCH and C2 CHUTE Harness Assembly
4221	G-185	Connects DRIVE ASSY OPT FDR (OPT FDR Motor) and C2 MOT Harness Assembly

P/J	Coordinates	Remarks
4222	G-185	Connects DRIVE ASSY OPT FDR (OPT FDR Motor) and C2 MOT Harness Assembly
42121	D-183	Connects C2 CST No Paper Sensor and C2 NO PAPER Harness Assembly

1.2 IOT P/J layout diagram

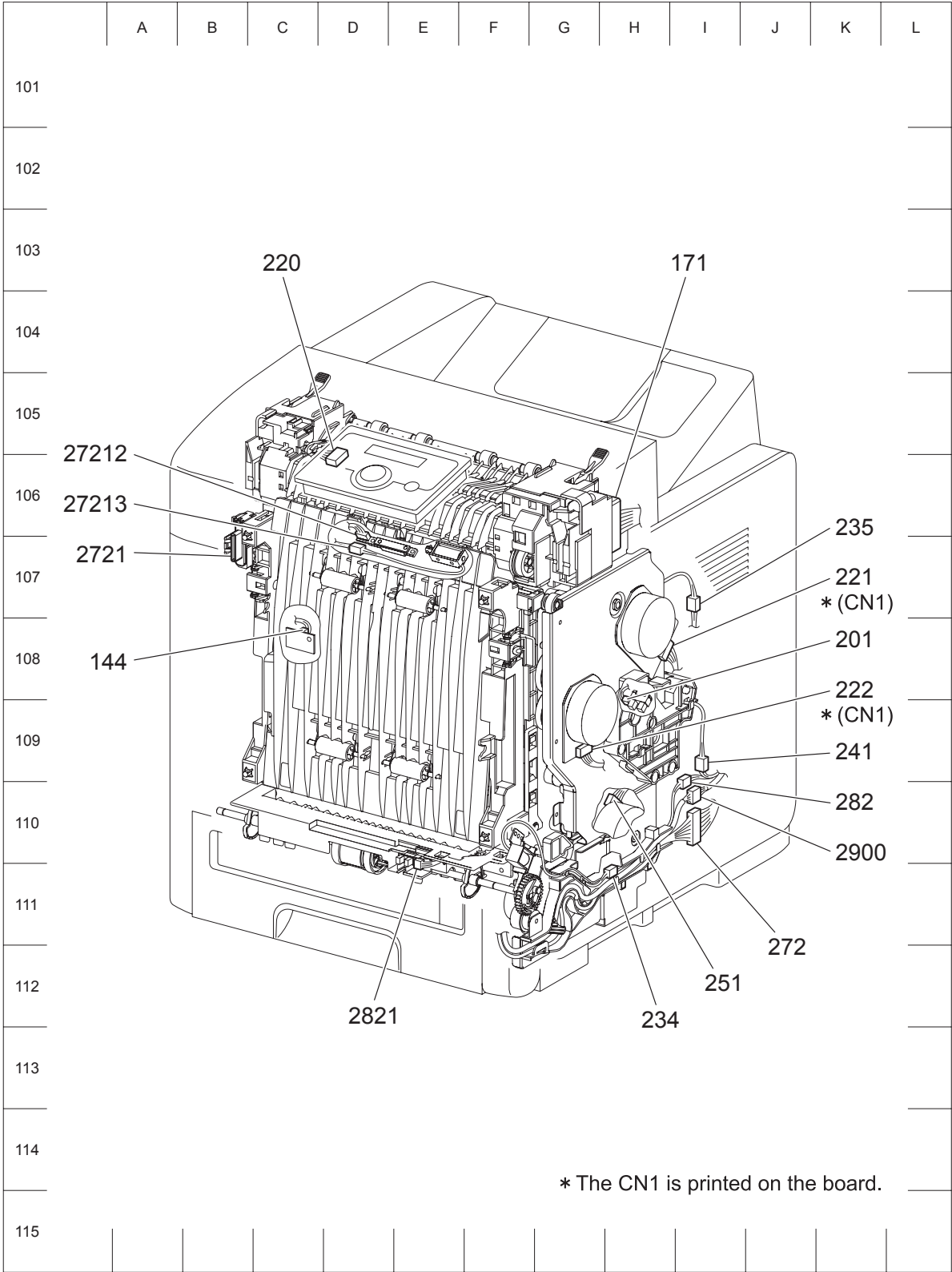

Zna04001KB

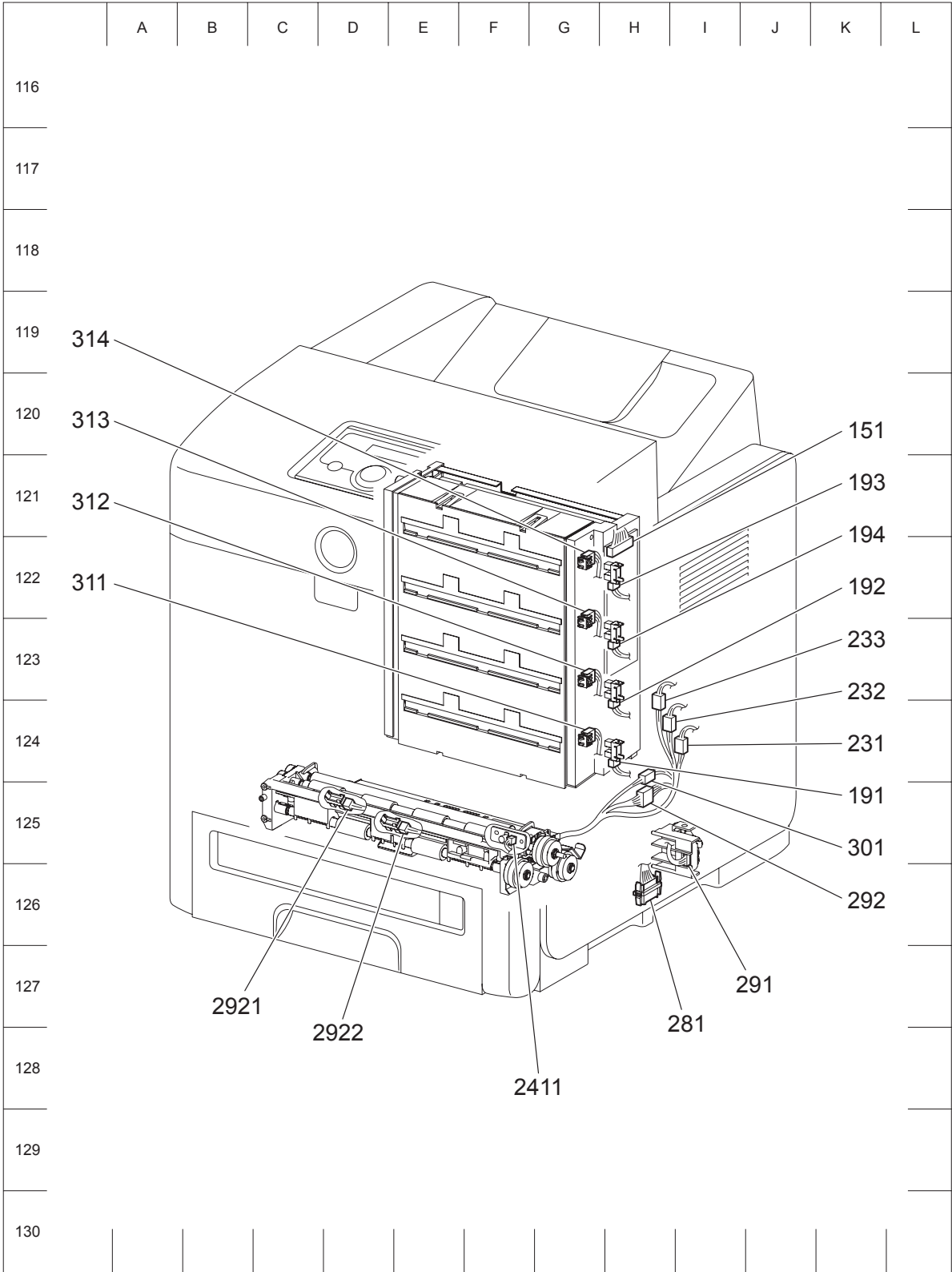

Zna04002KB

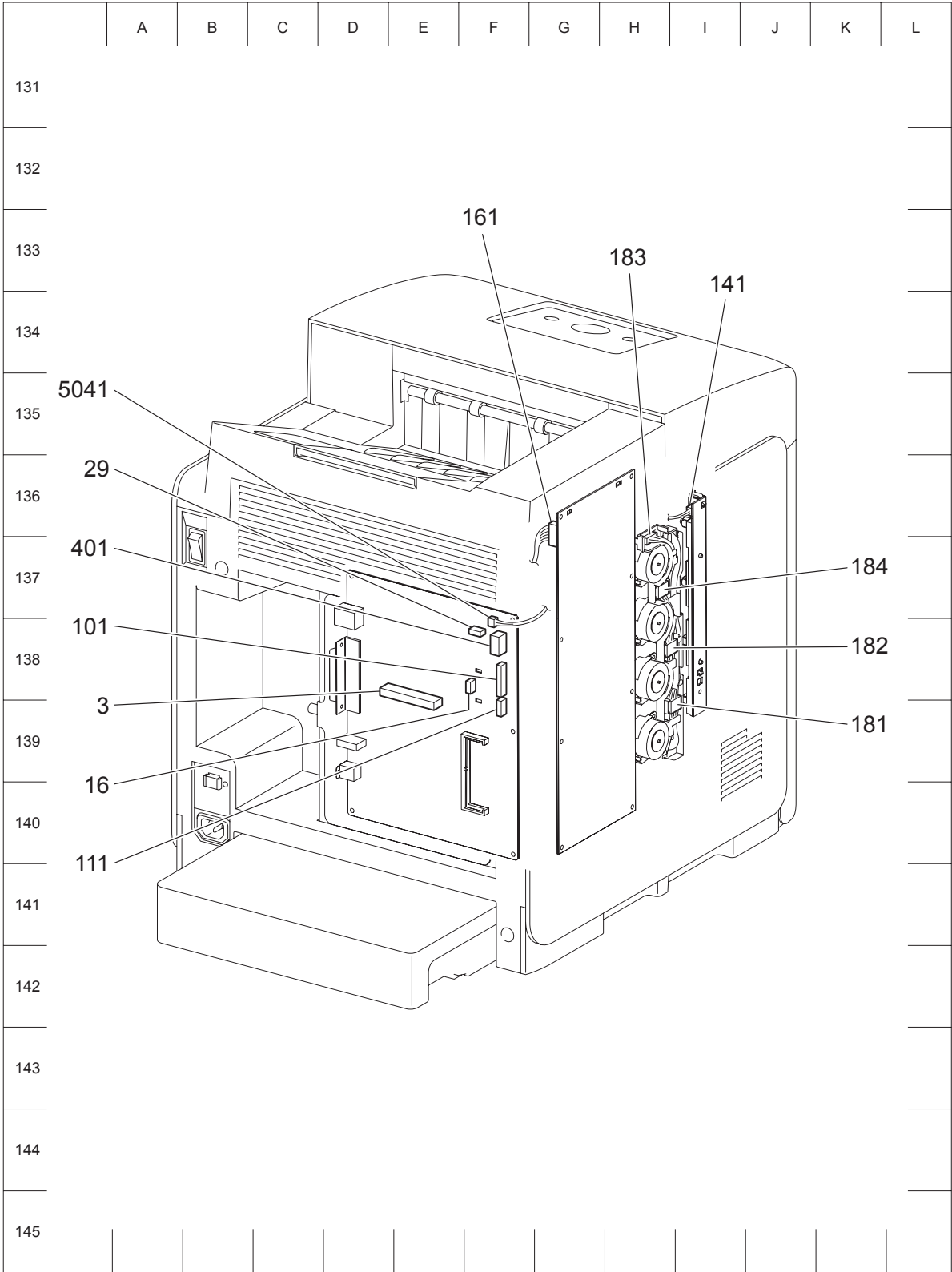

Zna04003KB

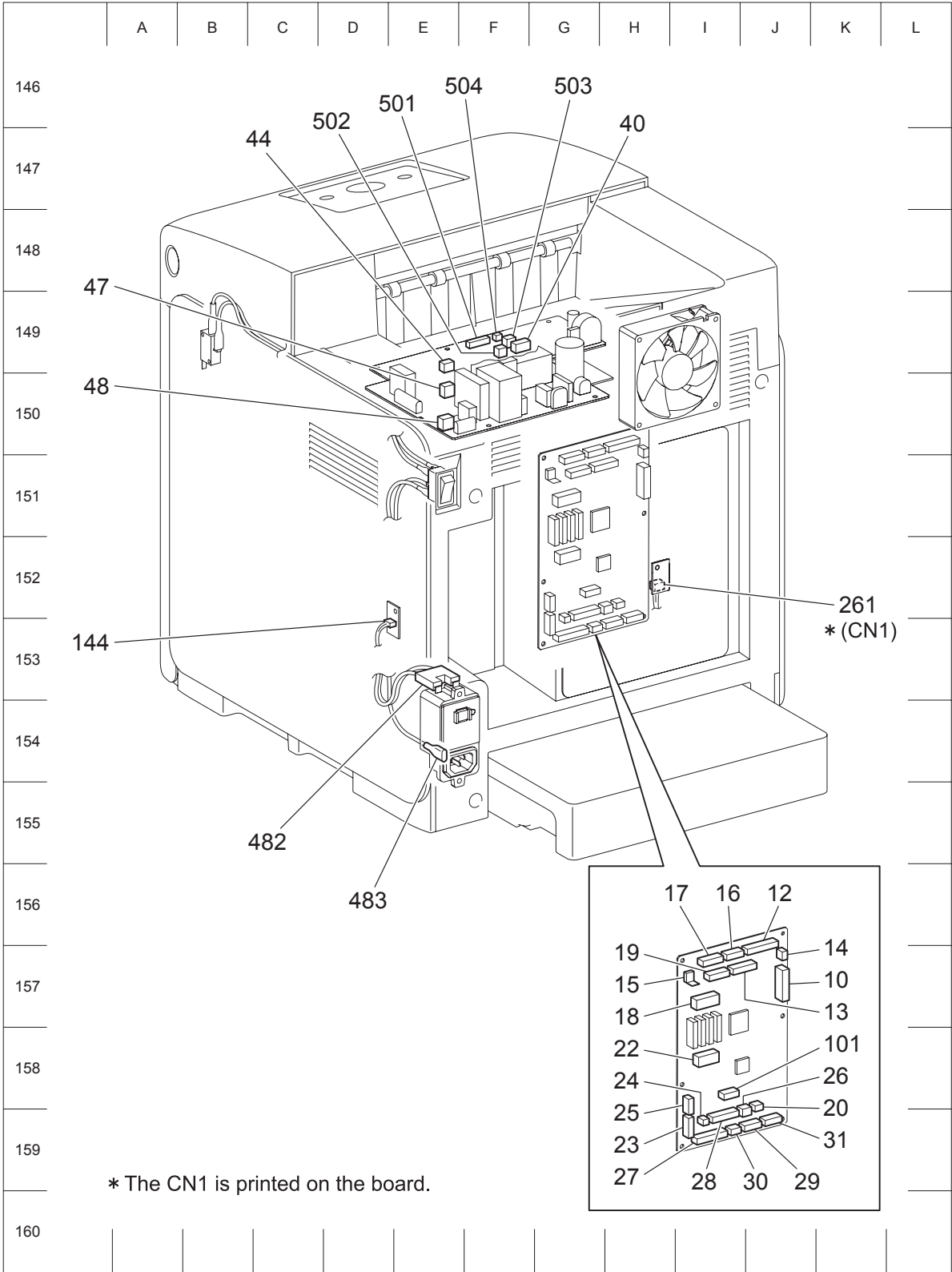

Zna04004KB

1.3 DUPLEX P/J layout diagram

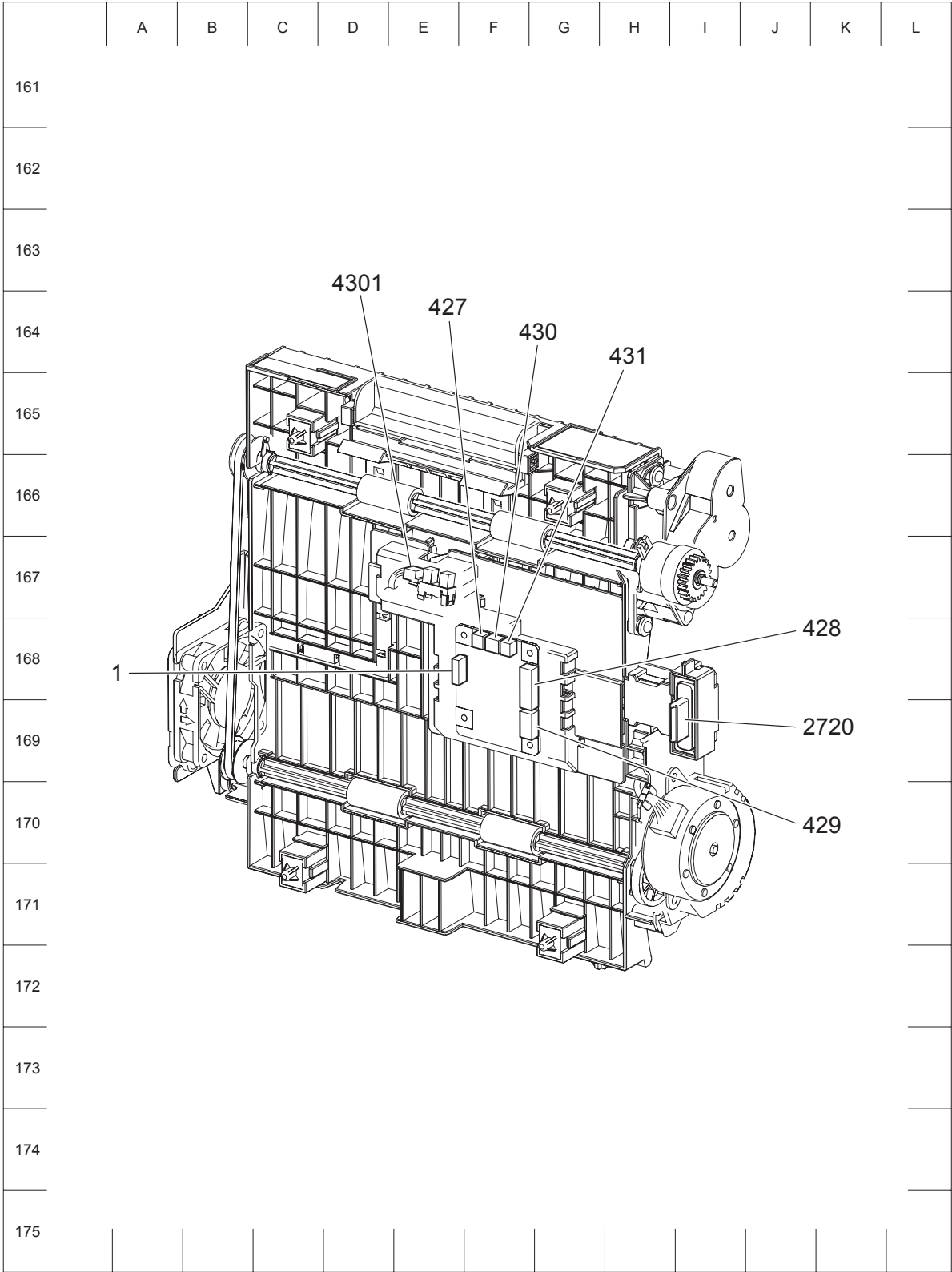

Kmy04005KA

1.4 OPTION FEEDER P/J layout diagram

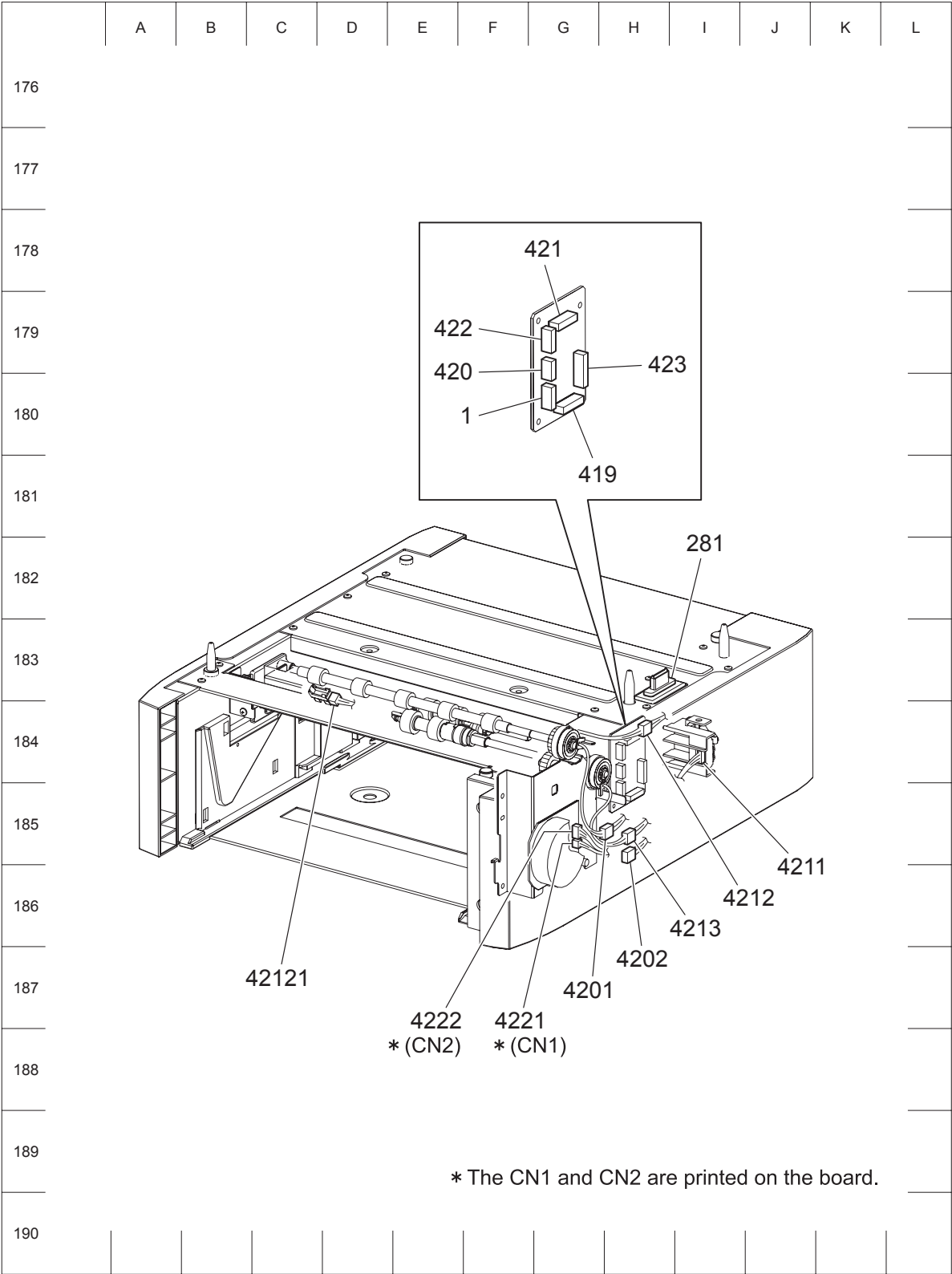

Zna04006KA

Blank page