

P C600
Point to Point Diagram (1/5)

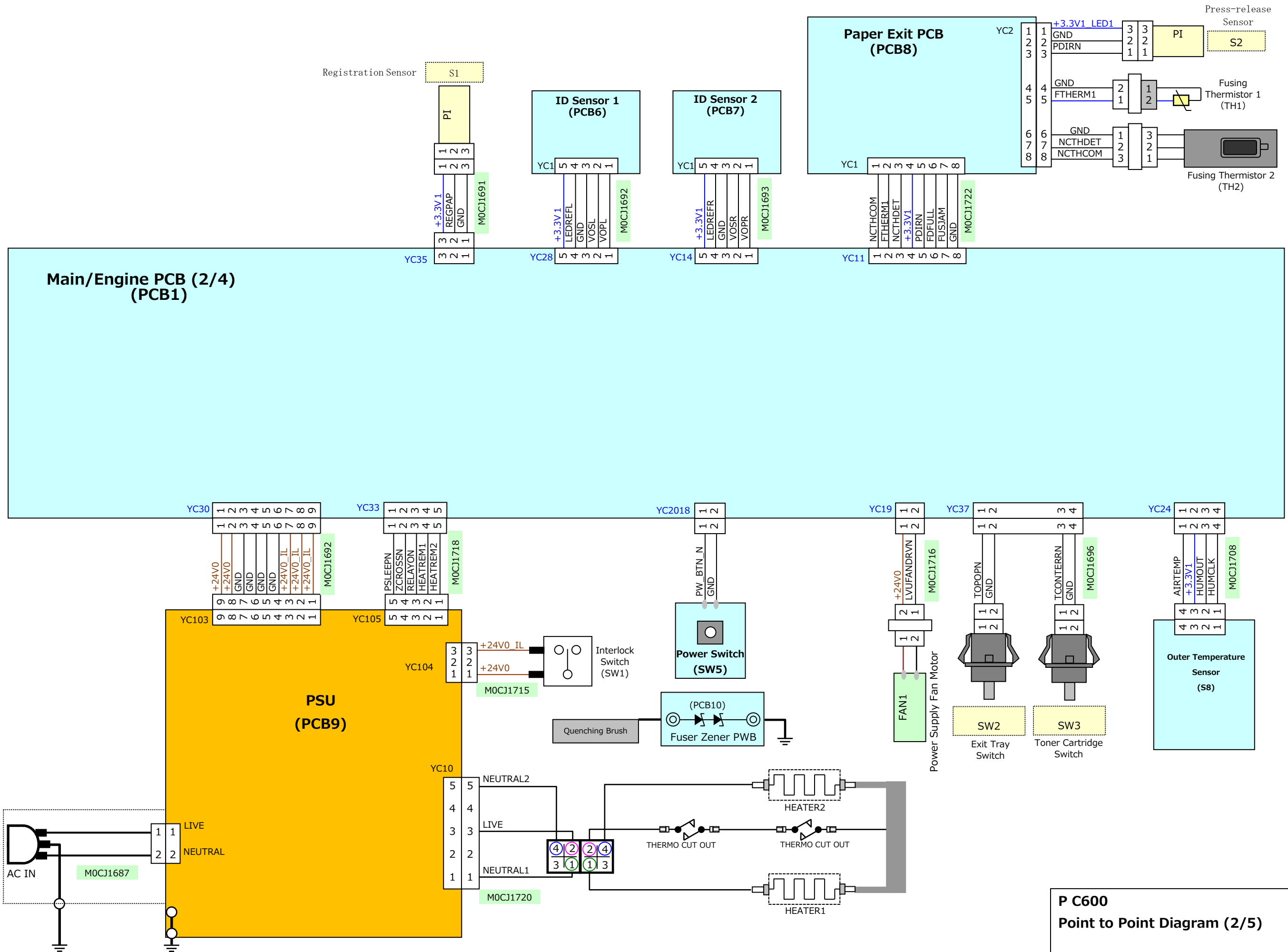

P C600
Point to Point Diagram (2/5)

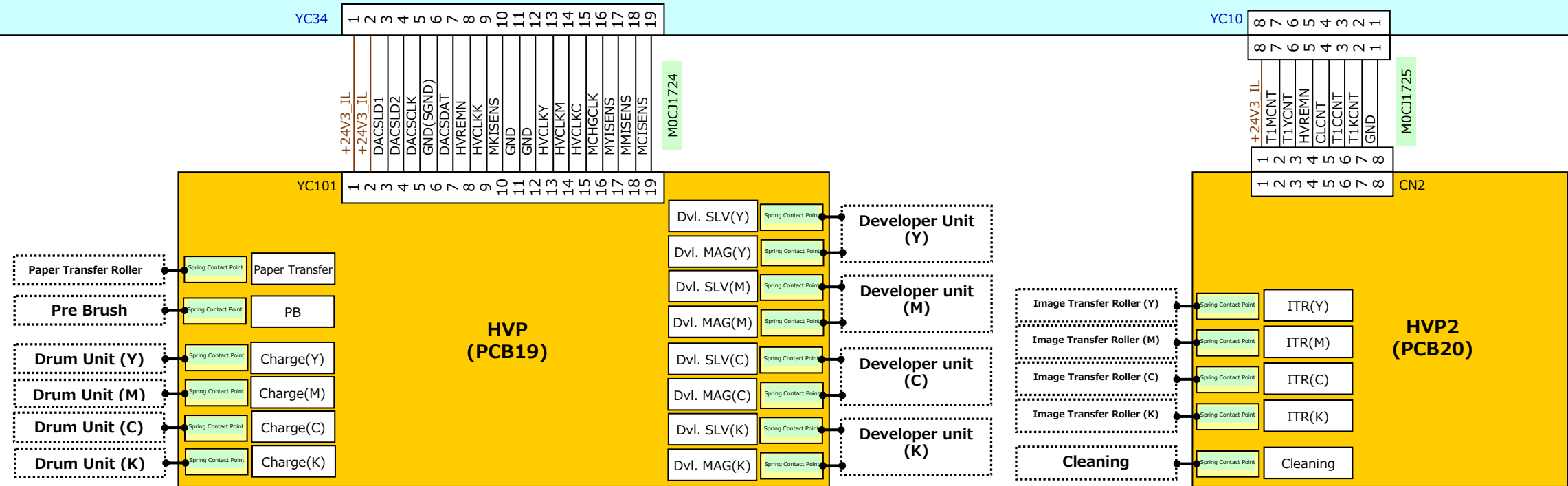
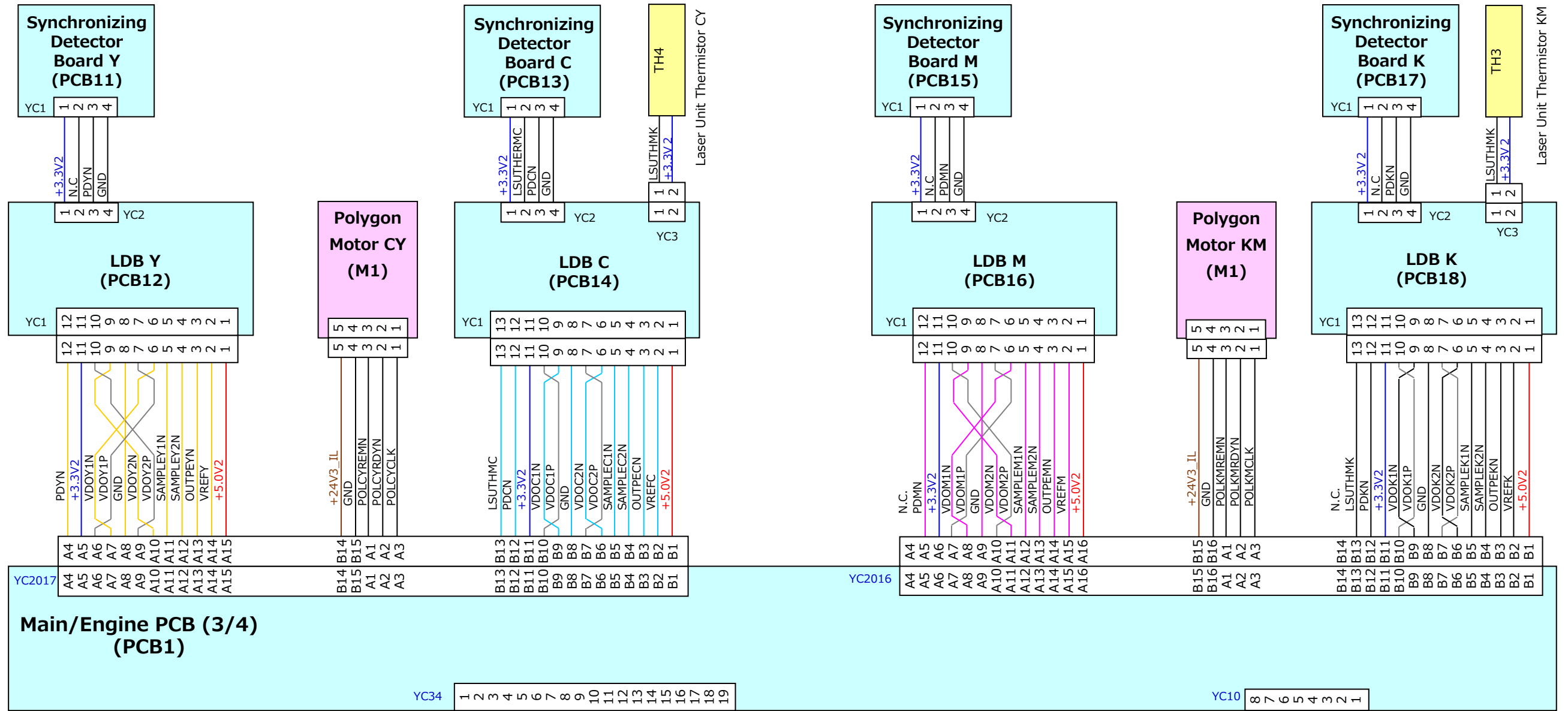

P C600
Point to Point Diagram (3/5)

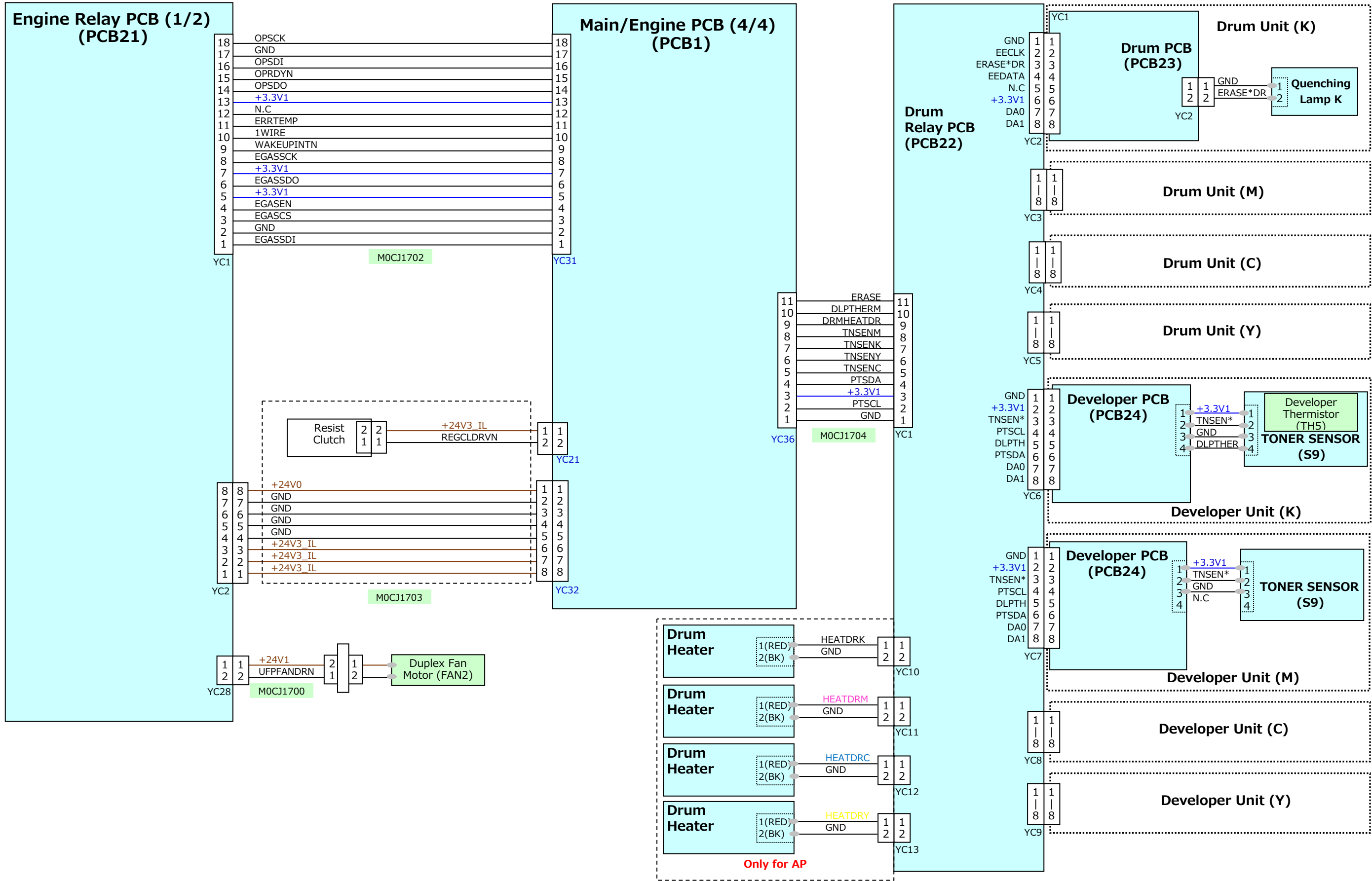

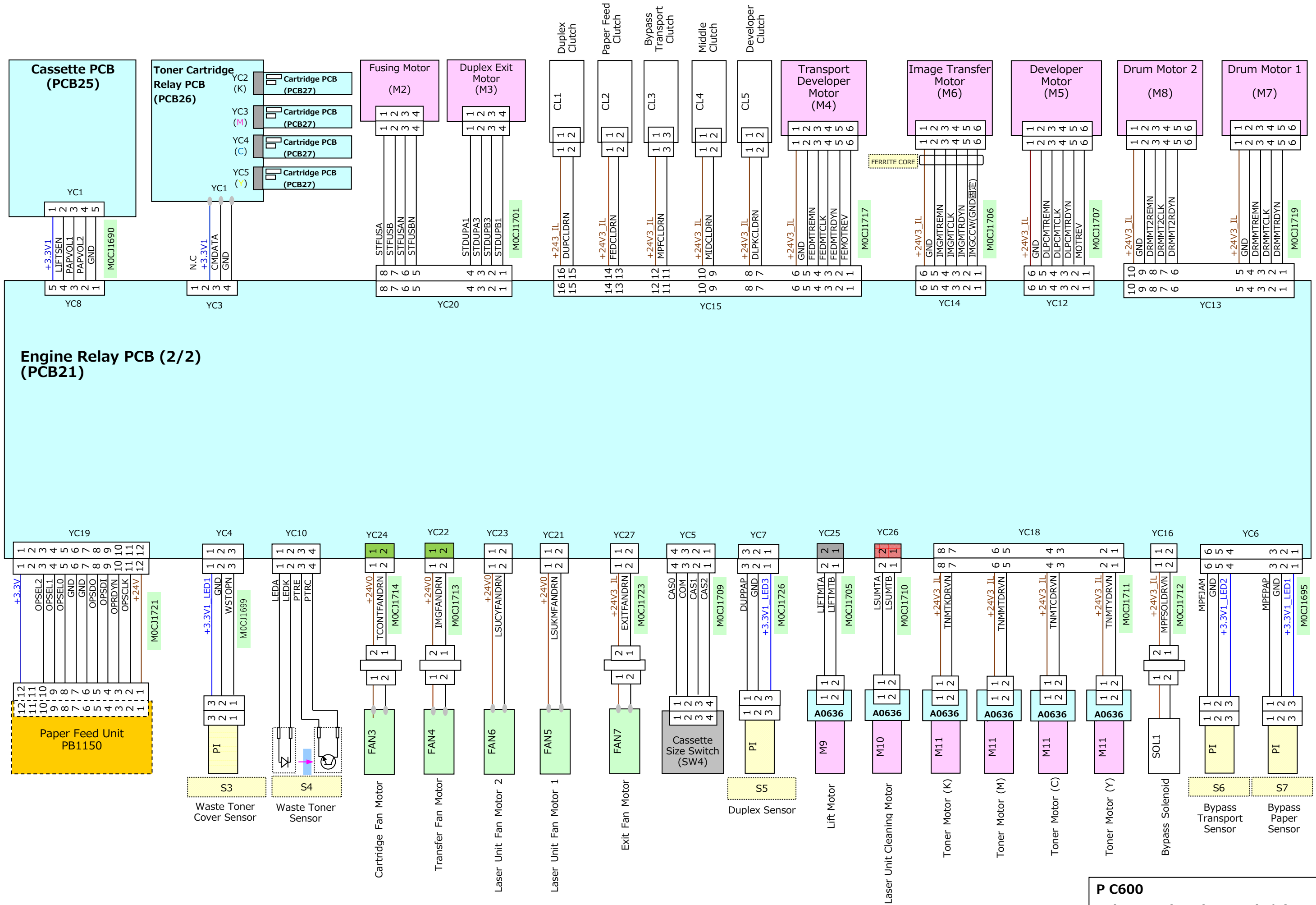

P C600 Component Layout (1/4)

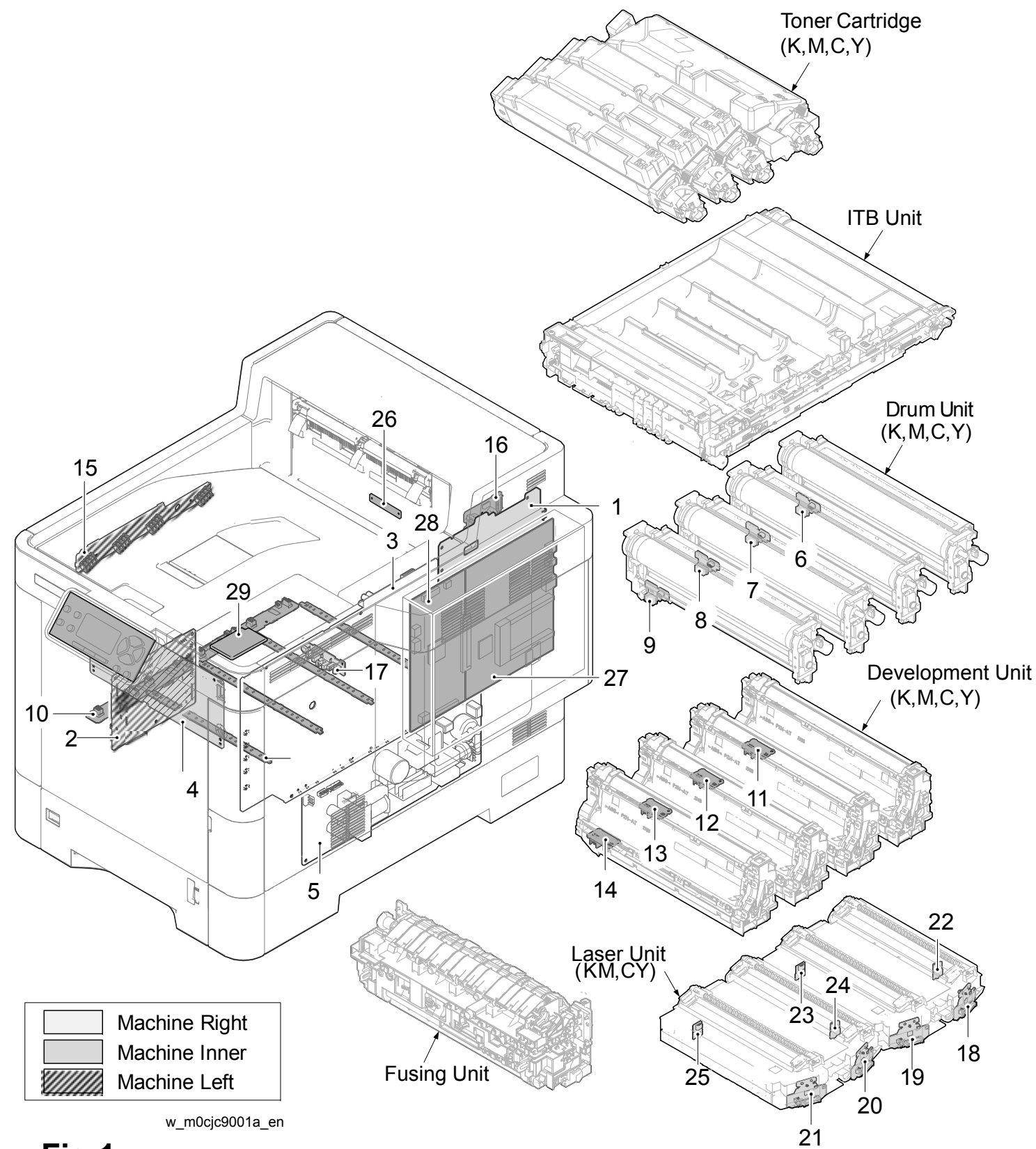

Symbol	Layout	Part Name
PCBs		
PCB1	Fig.1-1	Main/Engine PCB
PCB2	Fig.1-28	BiCU
PCB3	Fig.1-27	Controller Board
PCB4	Fig.1-29	NFC Board
PCB5	-	LCD
PCB8	Fig.1-16	Paper Exit PCB
PCB9	Fig.1-5	PSU
PCB10	Fig.1-26	Fusing Zener PCB
PCB11	Fig.1-25	Synchronizing Detector Board Y
PCB12	Fig.1-21	LDB Y
PCB13	Fig.1-24	Synchronizing Detector Board C
PCB14	Fig.1-20	LDB C
PCB15	Fig.1-23	Synchronizing Detector Board M
PCB16	Fig.1-19	LDB M
PCB17	Fig.1-22	Synchronizing Detector Board K
PCB18	Fig.1-18	LDB K
PCB19	Fig.1-3	HVP
PCB20	Fig.1-4	HVP 2
PCB21	Fig.1-2	Engine Relay PCB
PCB22	Fig.1-10	Drum Relay PCB
PCB23	Fig.1-6	Drum PCB K
PCB23	Fig.1-7	Drum PCB M
PCB23	Fig.1-8	Drum PCB C
PCB23	Fig.1-9	Drum PCB Y
PCB24	Fig.1-11	Developer PCB K
PCB24	Fig.1-12	Developer PCB M
PCB24	Fig.1-13	Developer PCB C
PCB24	Fig.1-14	Developer PCB Y
PCB25	Fig.1-17	Cassette PCB
PCB26	Fig.1-15	Toner Cartridge Relay PCB
PCB27	-	Cartridge PCB

Fig.1

P C600 Component Layout (2/4)

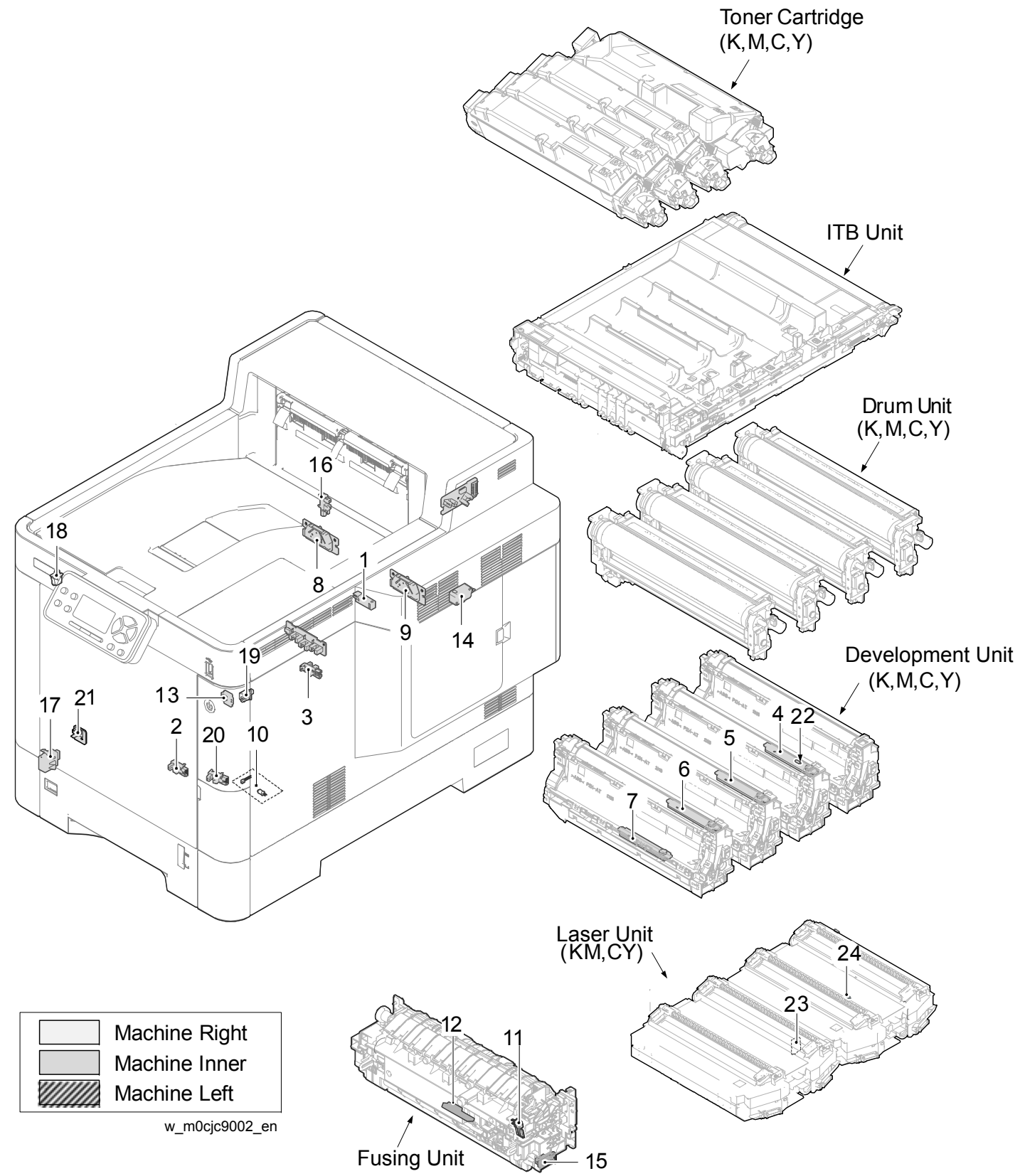

Symbol	Layout	Part Name
Sensors		
S1	Fig.2-1	Registration Sensor
S2	Fig.2-15	Press-release Sensor
S3	Fig.2-20	Waste Toner Cover Sensor
S4	Fig.2-10	Waste Toner Sensor
S5	Fig.2-16	Duplex Sensor
S6	Fig.2-3	Bypass Transport Sensor
S7	Fig.2-2	Bypass Paper Sensor
S8	Fig.2-21	Outer Temperature Sensor
S9	Fig.2-4	Toner Sensor K
S9	Fig.2-5	Toner Sensor M
S9	Fig.2-6	Toner Sensor C
S9	Fig.2-7	Toner Sensor Y
Switches		
SW1	Fig.2-14	Interlock Sw itch
SW2	Fig.2-18	Exit Tray Sw itch
SW3	Fig.2-19	Toner Cartridge Sw itch
SW4	Fig.2-17	Cassette Size Sw itch
SW5	Fig.2-13	Pow er Sw itch
Thermistors		
TH1	Fig.2-11	Fusing Thermistor 1
TH2	Fig.2-12	Fusing Thermistor 2
TH3	Fig.2-23	Laser Unit Thermistor KM
TH4	Fig.2-24	Laser Unit Thermistor CY
TH5	Fig.2-22	Developer Thermistor
PCBs		
PCB6	Fig.2-8	ID Sensor 1
PCB7	Fig.2-9	ID Sensor 2

Fig.2

P C600 Component Layout (3/4)

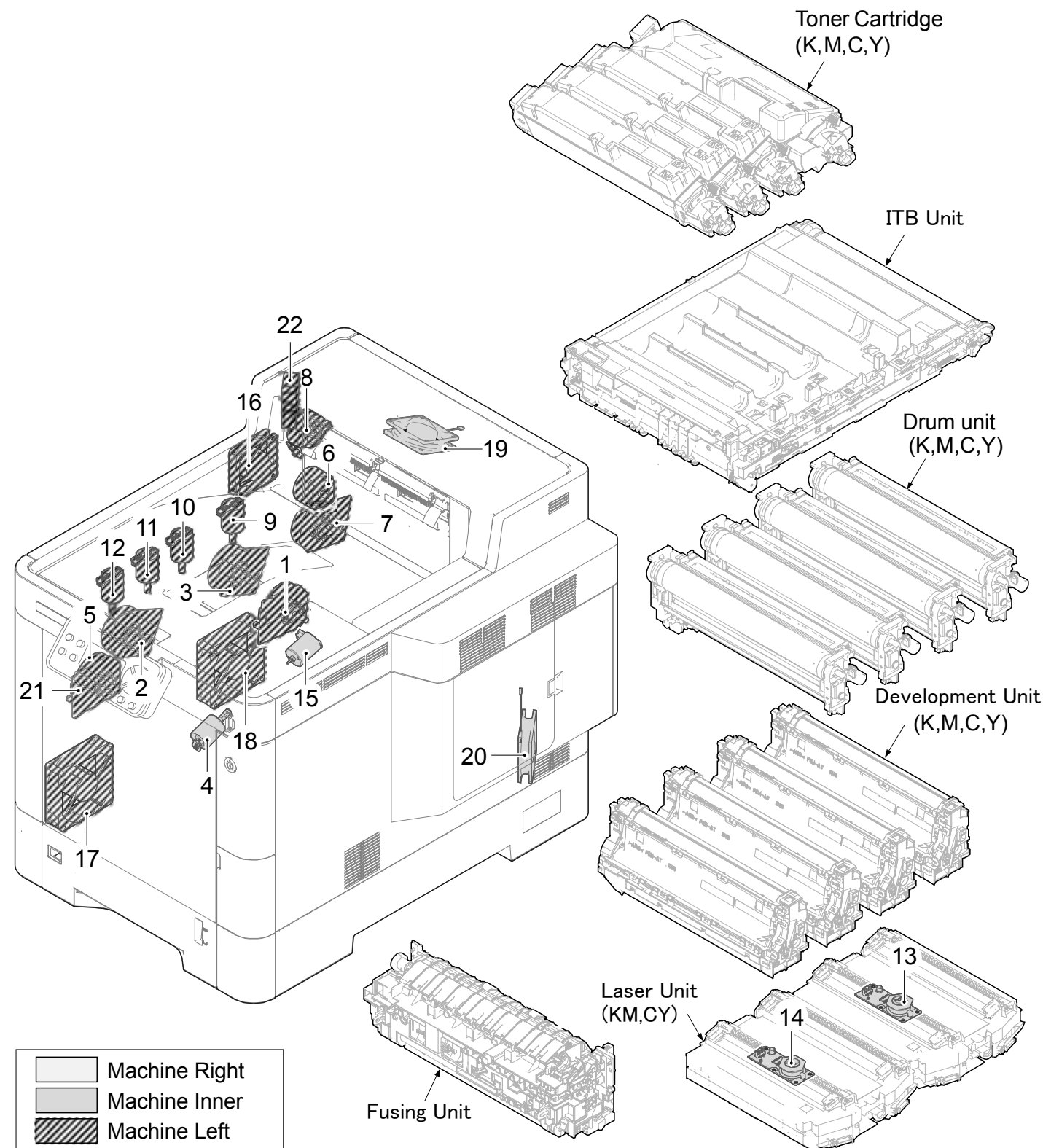

w_m0cjc9003_en

Fig.3

Symbol	Layout	Part Name
Motors		
M1	Fig.3-13	Polygon Motor KM
M1	Fig.3-14	Polygon Motor CY
M2	Fig.3-6	Fusing Motor
M3	Fig.3-8	Duplex Exit Motor
M4	Fig.3-1	Transport Developer Motor
M5	Fig.3-5	Developer Motor
M6	Fig.3-7	Image Transfer Motor
M7	Fig.3-2	Drum Motor 1
M8	Fig.3-3	Drum Motor 2
M9	Fig.3-4	Lift Motor
M10	Fig.3-15	Laser Unit Cleaning Motor
M11	Fig.3-9	Toner Motor K
M11	Fig.3-10	Toner Motor M
M11	Fig.3-11	Toner Motor C
M11	Fig.3-12	Toner Motor Y
Fan Motors		
FAN1	Fig.3-20	Power Supply Fan Motor
FAN2	Fig.3-22	Duplex Fan Motor
FAN3	Fig.3-16	Cartridge Fan Motor
FAN4	Fig.3-21	Transfer Fan Motor
FAN5	Fig.3-17	Laser Unit Fan Motor 1
FAN6	Fig.3-18	Laser Unit Fan Motor 2
FAN7	Fig.3-19	Exit Fan Motor

P C600 Component Layout (4/4)

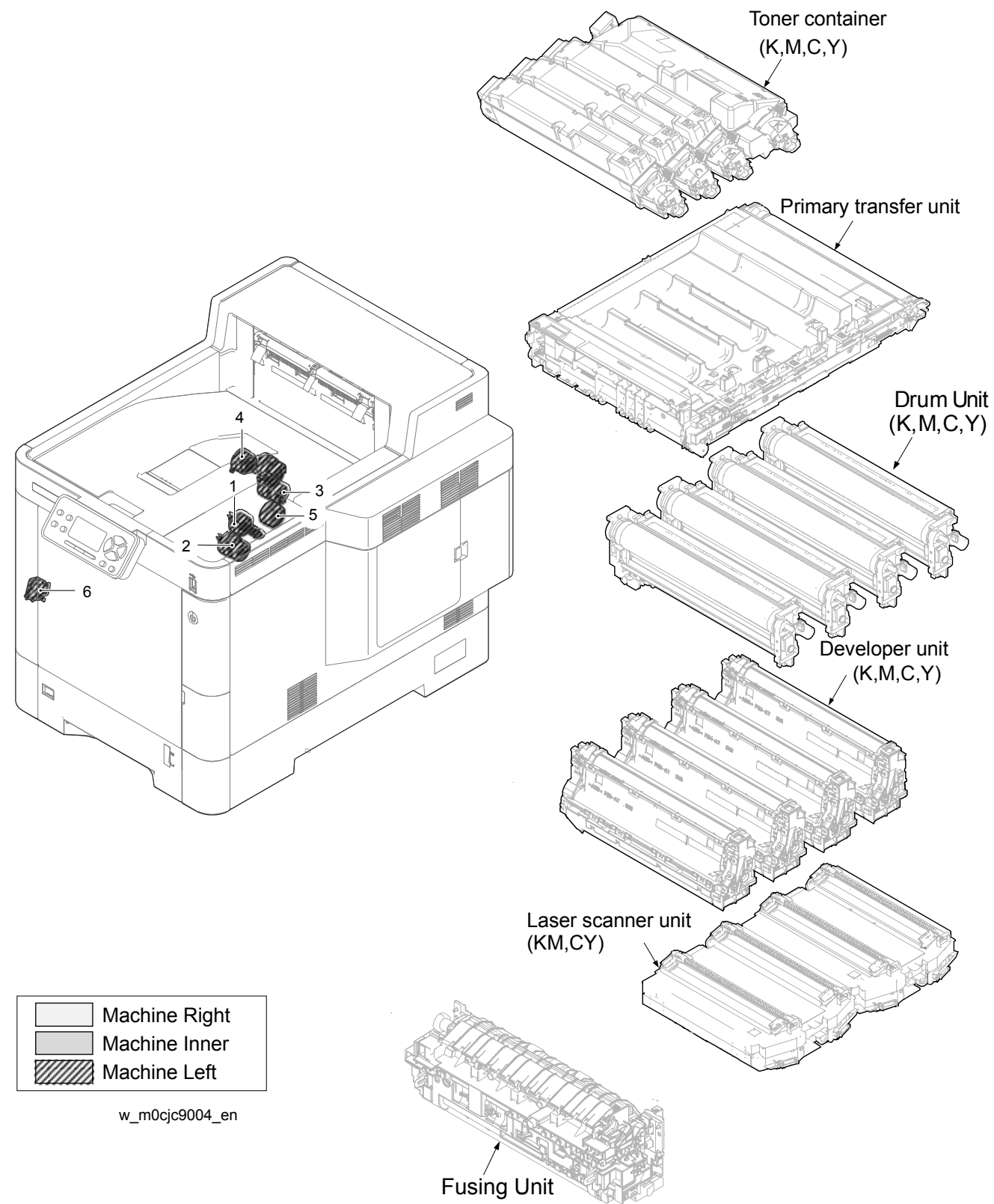

Symbol	Layout	Part Name
Clutches		
CL1	Fig.4-5	Duplex Clutch
CL2	Fig.4-1	Paper Feed Clutch
CL3	Fig.4-2	Bypass Transport Clutch
CL4	Fig.4-3	Middle Clutch
CL5	Fig.4-4	Developer Clutch
Solenoids		
SOL1	Fig.4-6	Bypass Solenoid

Fig.4

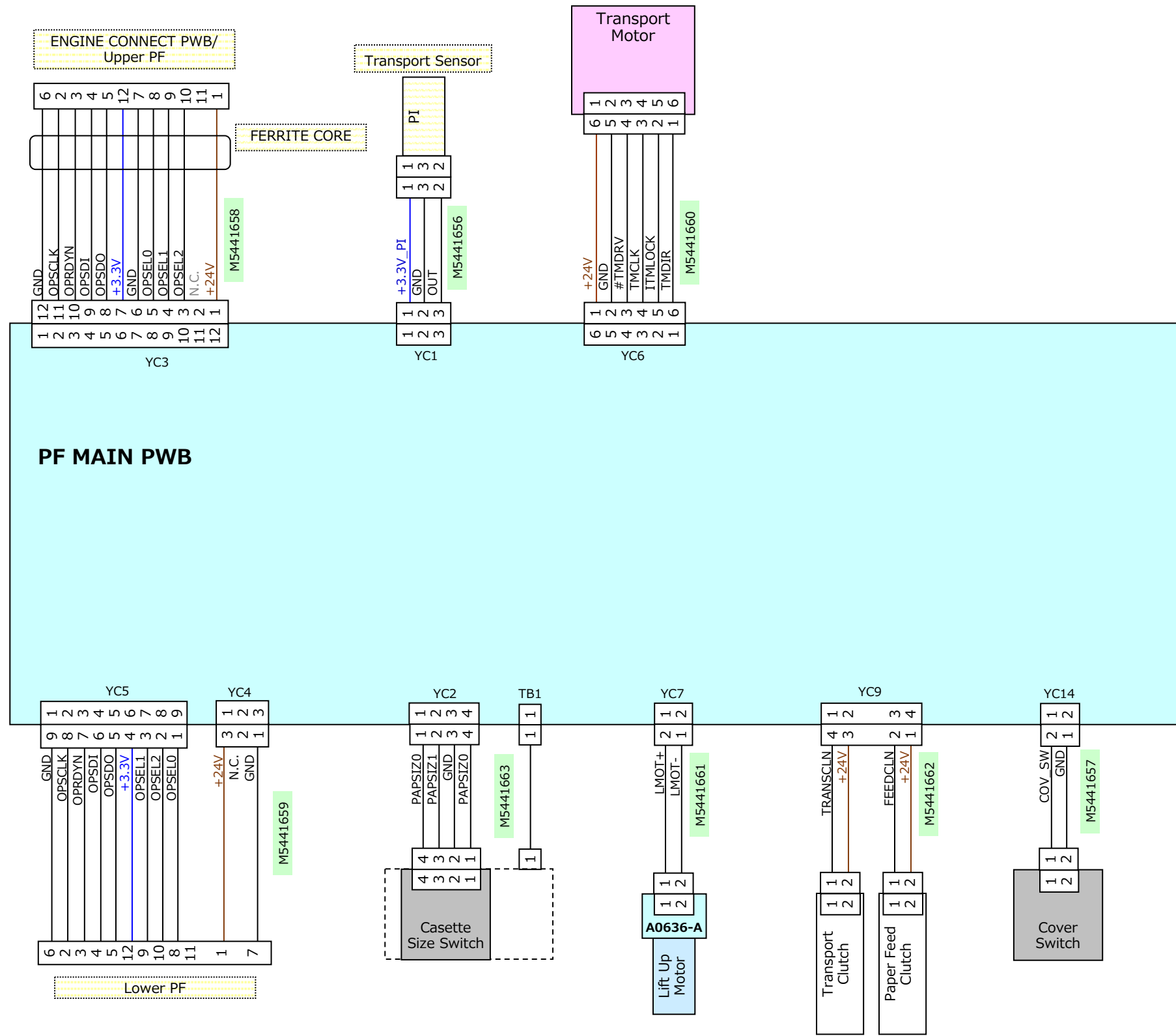

**Paper Feed Unit PB1150
Point to Point Diagram**