

D117/D118 POINT TO POINT DIAGRAM

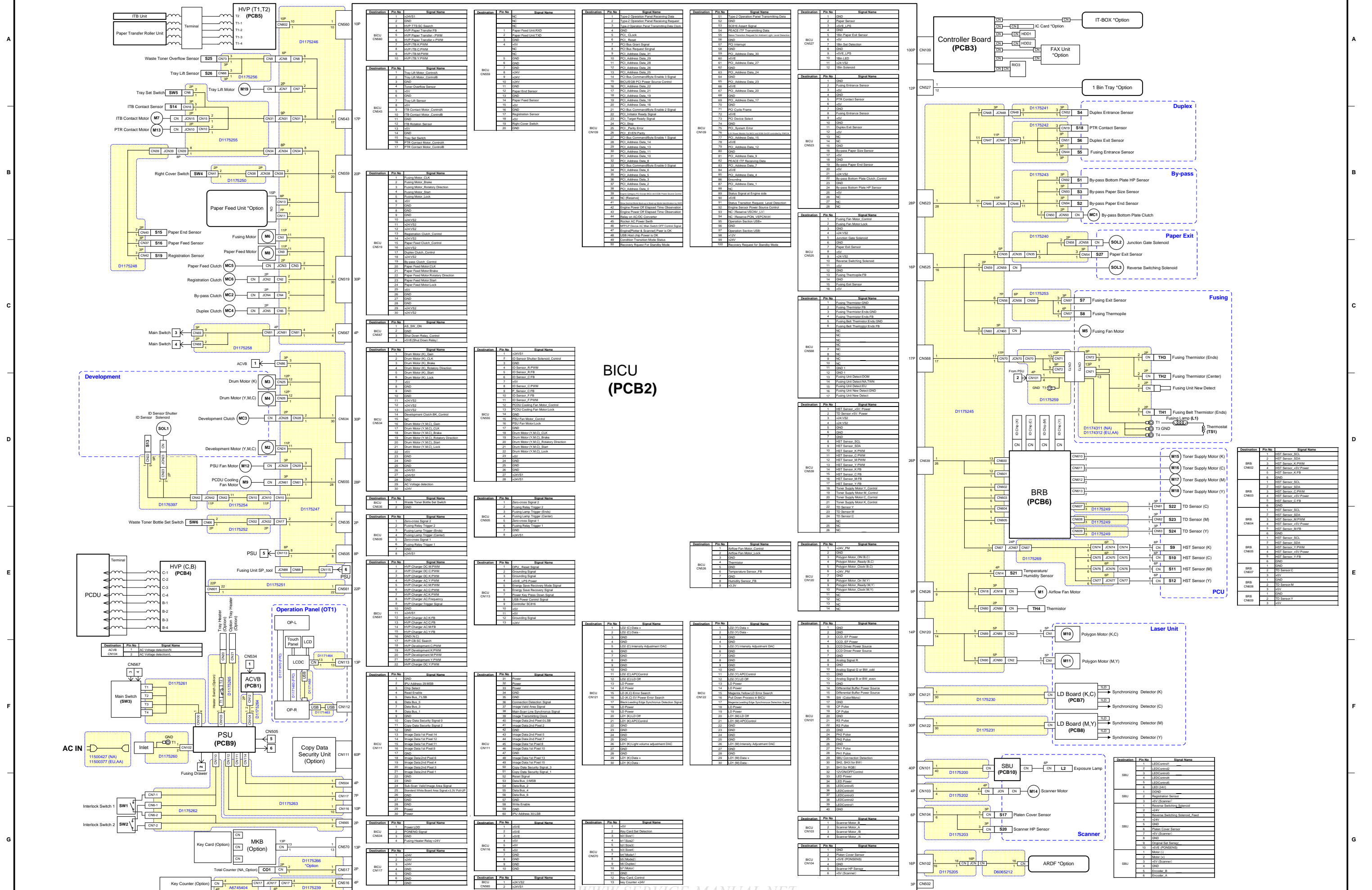

BICU (PCB2)

Destination	Pin No.	Signal Name	Destination	Pin No.	Signal Name
ICU CNG0	1	ICU CNG0	ICU CNG0	1	ICU CNG0
ICU CNG1	2	ICU CNG1	ICU CNG1	2	ICU CNG1
ICU CNG2	3	ICU CNG2	ICU CNG2	3	ICU CNG2
ICU CNG3	4	ICU CNG3	ICU CNG3	4	ICU CNG3
ICU CNG4	5	ICU CNG4	ICU CNG4	5	ICU CNG4
ICU CNG5	6	ICU CNG5	ICU CNG5	6	ICU CNG5
ICU CNG6	7	ICU CNG6	ICU CNG6	7	ICU CNG6
ICU CNG7	8	ICU CNG7	ICU CNG7	8	ICU CNG7
ICU CNG8	9	ICU CNG8	ICU CNG8	9	ICU CNG8
ICU CNG9	10	ICU CNG9	ICU CNG9	10	ICU CNG9
ICU CNG10	11	ICU CNG10	ICU CNG10	11	ICU CNG10
ICU CNG11	12	ICU CNG11	ICU CNG11	12	ICU CNG11
ICU CNG12	13	ICU CNG12	ICU CNG12	13	ICU CNG12
ICU CNG13	14	ICU CNG13	ICU CNG13	14	ICU CNG13
ICU CNG14	15	ICU CNG14	ICU CNG14	15	ICU CNG14
ICU CNG15	16	ICU CNG15	ICU CNG15	16	ICU CNG15
ICU CNG16	17	ICU CNG16	ICU CNG16	17	ICU CNG16
ICU CNG17	18	ICU CNG17	ICU CNG17	18	ICU CNG17
ICU CNG18	19	ICU CNG18	ICU CNG18	19	ICU CNG18
ICU CNG19	20	ICU CNG19	ICU CNG19	20	ICU CNG19
ICU CNG20	21	ICU CNG20	ICU CNG20	21	ICU CNG20
ICU CNG21	22	ICU CNG21	ICU CNG21	22	ICU CNG21
ICU CNG22	23	ICU CNG22	ICU CNG22	23	ICU CNG22
ICU CNG23	24	ICU CNG23	ICU CNG23	24	ICU CNG23
ICU CNG24	25	ICU CNG24	ICU CNG24	25	ICU CNG24
ICU CNG25	26	ICU CNG25	ICU CNG25	26	ICU CNG25
ICU CNG26	27	ICU CNG26	ICU CNG26	27	ICU CNG26
ICU CNG27	28	ICU CNG27	ICU CNG27	28	ICU CNG27
ICU CNG28	29	ICU CNG28	ICU CNG28	29	ICU CNG28
ICU CNG29	30	ICU CNG29	ICU CNG29	30	ICU CNG29

More Service Manuals at www.service-manual.net

ELECTRICAL COMPONENT LAYOUT (D117/D118) 1/2

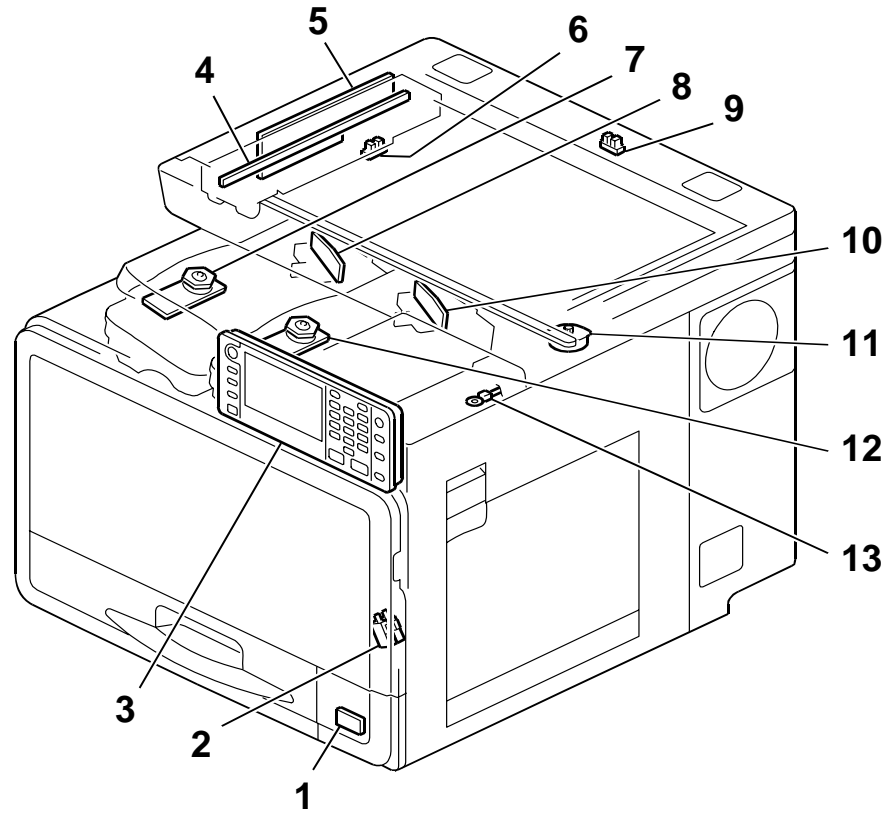

D117V151.Wmf

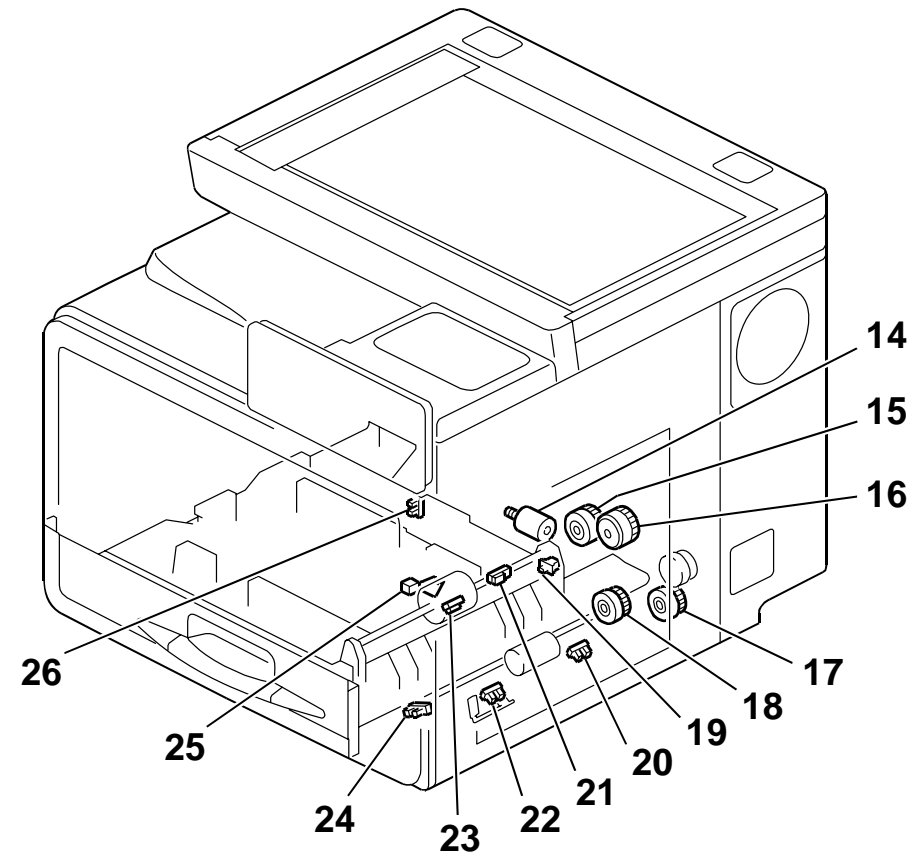

D117V153.Wmf

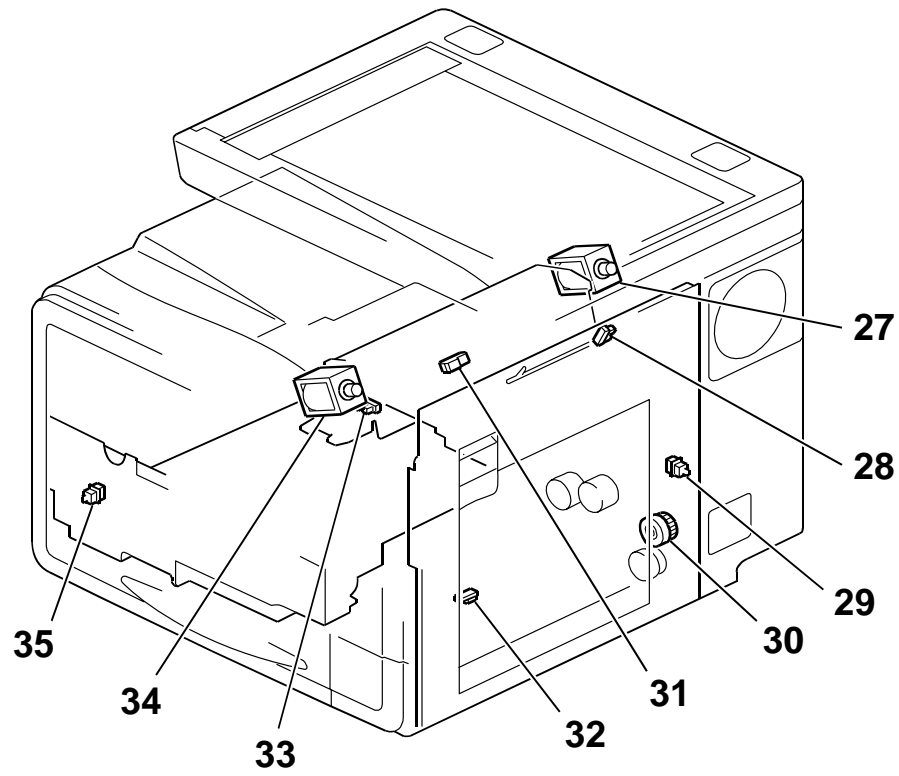

D117V155.Wmf

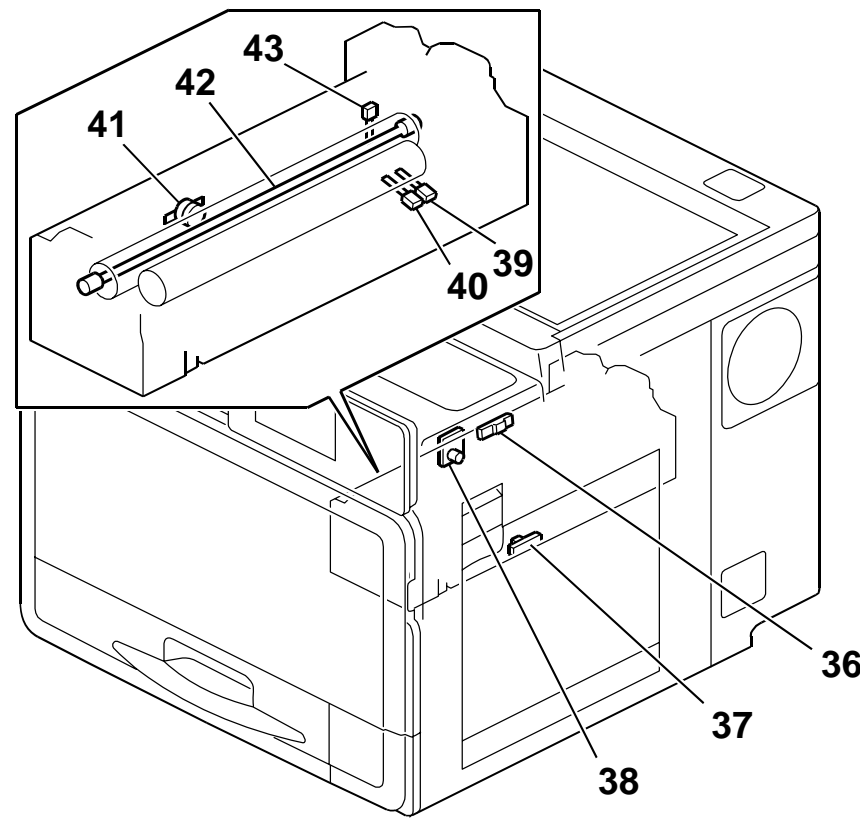

D117V154.Wmf

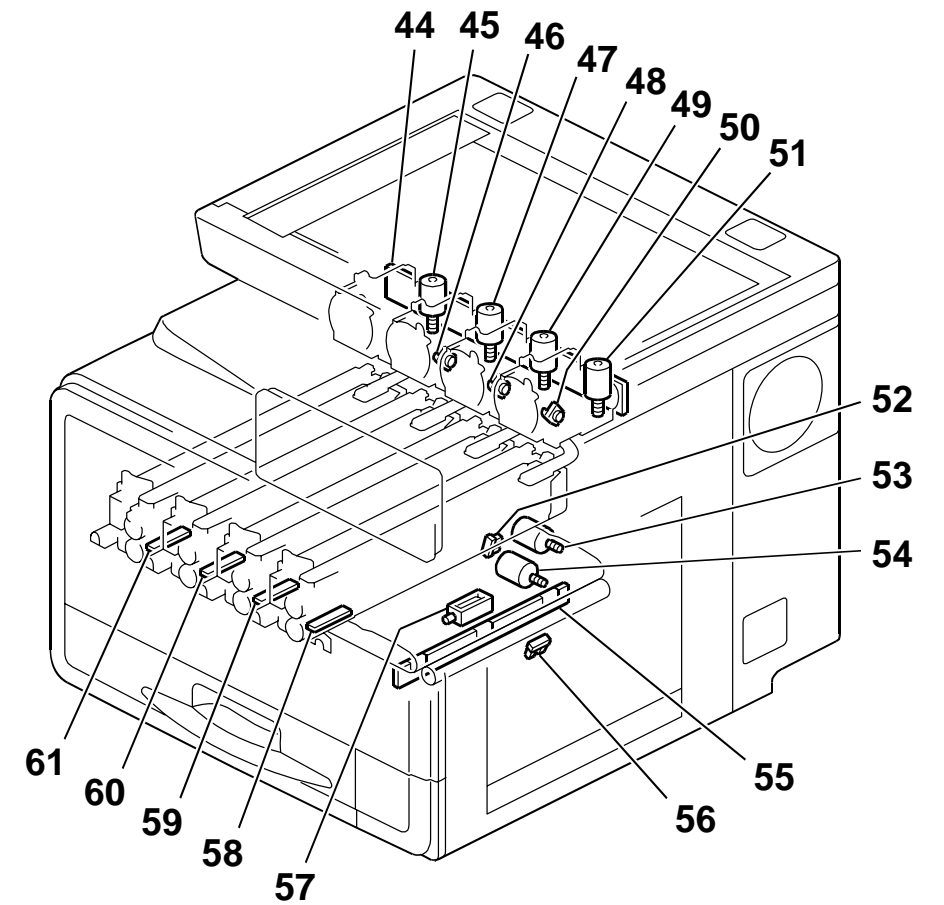

D117V152.Wmf

ELECTRICAL COMPONENT LAYOUT (D117/D118) 2/2

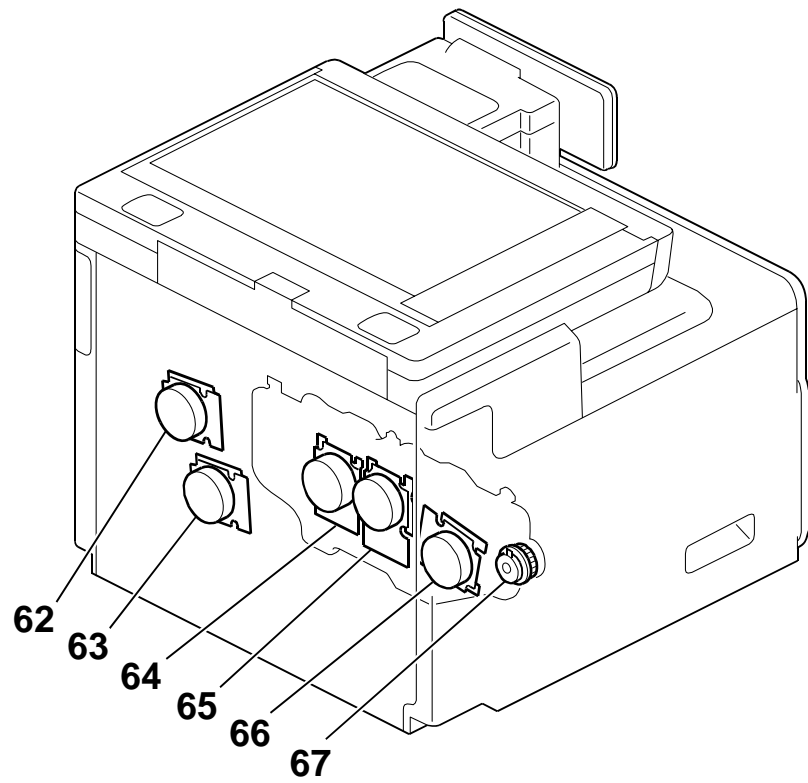

D117V156.Wmf

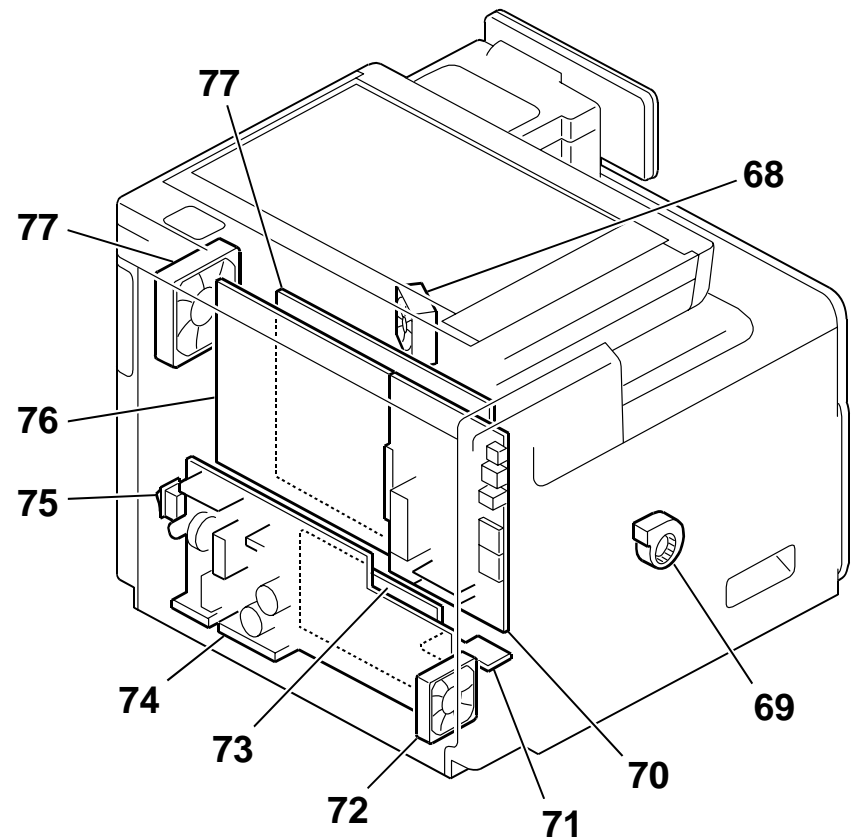

D117V157.Wmf

Symbol	Index No.	Description	P to P
Sensors			
S1	24	By-pass Bottom Plate HP Sensor	B9
S2	20	By-pass Paper End Sensor	B9
S3	22	By-pass Paper Size Sensor	B9
S4	28	Duplex Entrance Sensor	B9
S5	37	Fusing Entrance Sensor	B9
S6	32	Duplex Exit Sensor	B9
S7	36	Fusing Exit Sensor	C9
S8	38	Fusing Thermopile	C9
S9	61	HST Sensor (K)	E9
S10	60	HST Sensor (C)	E9
S11	59	HST Sensor (M)	E9
S12	58	HST Sensor (Y)	E9
S13	55	ID Sensor	D2
S14	52	ITB Contact Sensor	A2
S15	25	Paper End Sensor	B2
S16	23	Paper Feed Sensor	C2
S17	9	Platen Cover Sensor	G8
S18	56	PTR Contact Sensor	B9
S19	21	Registration Sensor	C2
S20	6	Scanner HP Sensor	G8
S21	1	Temperature/Humidity Sensor	E8
S22	46	TD Sensor (C)	E9
S23	48	TD Sensor (M)	E9
S24	50	TD Sensor (Y)	E9
S25	33	Waste Toner Overflow Sensor	A2
S26	26	Tray Lift Sensor	A2
S27	31	Paper Exit Sensor	C9
Motors			
M1	68	Airflow Fan Motor	E8
M2	64	Development Motor (Y,M,C)	D2
M3	66	Drum Motor (K)	D2
M4	65	Drum Motor (Y,M,C)	D2
M5	77	Fusing Fan Motor	C9
M6	62	Fusing Motor	B2
M7	54	ITB Contact Motor	B2
M8	63	Paper Feed Motor	C2
M9	69	PCDU Cooling Fan Motor	D2
M10	7	Polygon Motor (K,C)	E8
M11	12	Polygon Motor (M,Y)	F8
M12	72	PSU Fan Motor	D2
M13	53	PTR Contact Motor	B2
M14	11	Scanner Motor	G8
M15	45	Toner Supply Motor (K)	D9
M16	47	Toner Supply Motor (C)	D9
M17	49	Toner Supply Motor (M)	D9
M18	51	Toner Supply Motor (Y)	D9
M19	14	Tray Lift Motor	A2
Magnetic Clutches			
MC1	18	By-pass Bottom Plate Clutch	B9
MC2	17	By-pass Clutch	C2
MC3	67	Development Clutch	D2
MC4	30	Duplex Clutch	C2
MC5	15	Paper Feed Clutch	C2
MC6	16	Registration Clutch	C2

Symbol	Index No.	Description	P to P
PCBs			
PCB1	71	ACVB	F2
PCB2	76	BICU	D5
PCB3	70	Controller Board	A8
PCB4	77	HVP (C,B)	E2
PCB5	73	HVP (T1,T2)	A2
PCB6	44	BRB	D8
PCB7	8	LD Board (K,C)	F9
PCB8	10	LD Board (M,Y)	F9
PCB9	74	PSU	F2
PCB10	5	SBU	F8
Solenoids			
SOL1	57	ID Sensor Shutter Solenoid	D2
SOL2	34	Junction Gate Solenoid	C9
SOL3	27	Reverse Switching Solenoid	C9
Switches			
SW1,2	2	Interlock Switch 1,2	G1
SW3	75	Main Switch	F1
SW4	29	Right Cover Switch	B2
SW5	19	Tray Set Switch	A2
SW6	35	Waste Toner Bottle Set Switch	E2
Thermistors			
TH1	43	Fusing Belt Thermistor (Ends)	D9
TH2	40	Fusing Thermistor (Center)	D9
TH3	39	Fusing Thermistor (Ends)	C9
TH4	13	Thermistor	E8
Thermostat			
TS1	41	Thermostat	D9
Lamps			
L1	42	Fusing Lamp	D9
L2	4	Exposure Lamp	D9
Other			
OT1	3	Operation Panel	F8

D606 (ARDF) POINT TO POINT DIAGRAM

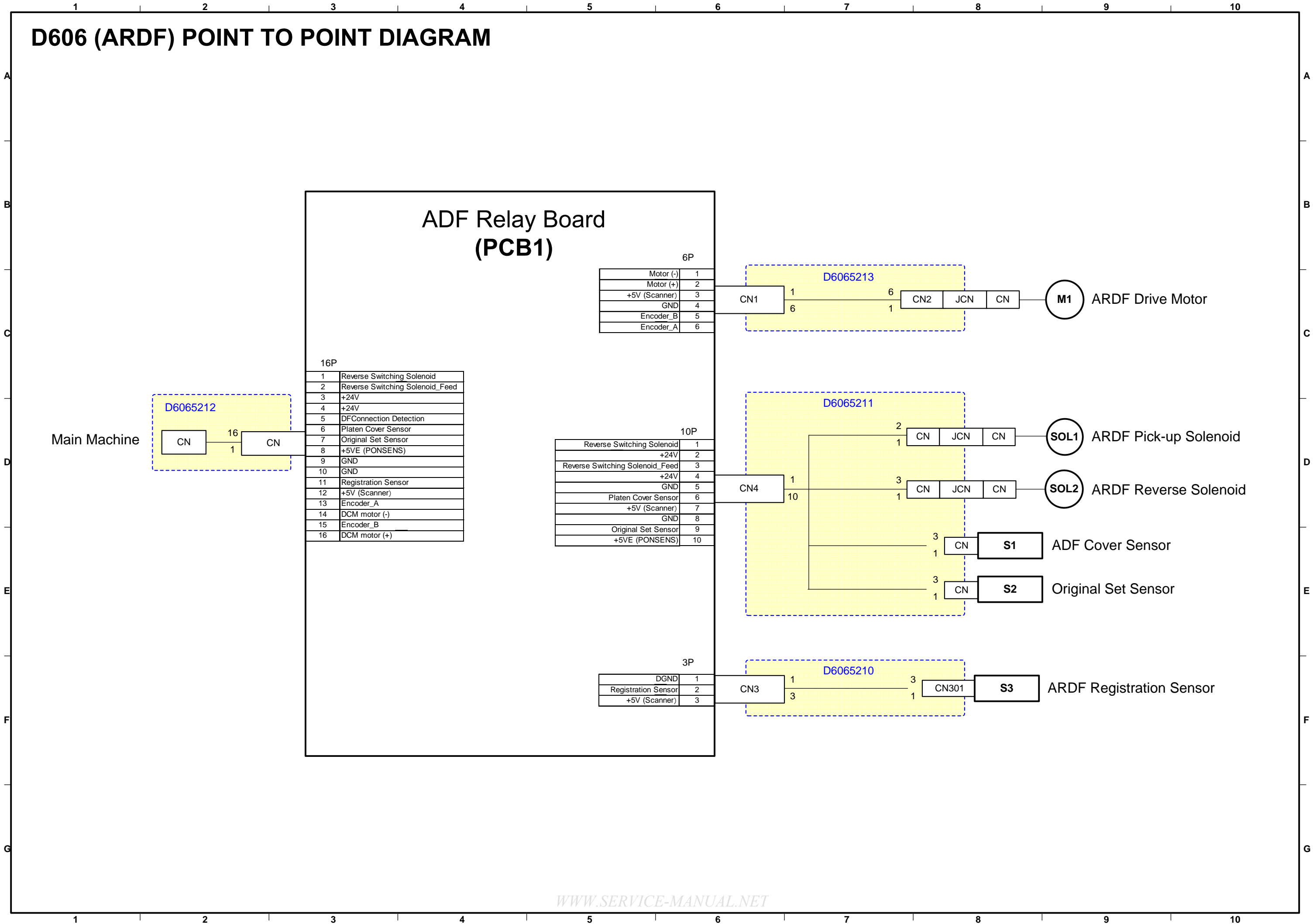

ELECTRICAL COMPONENT LAYOUT (D606)

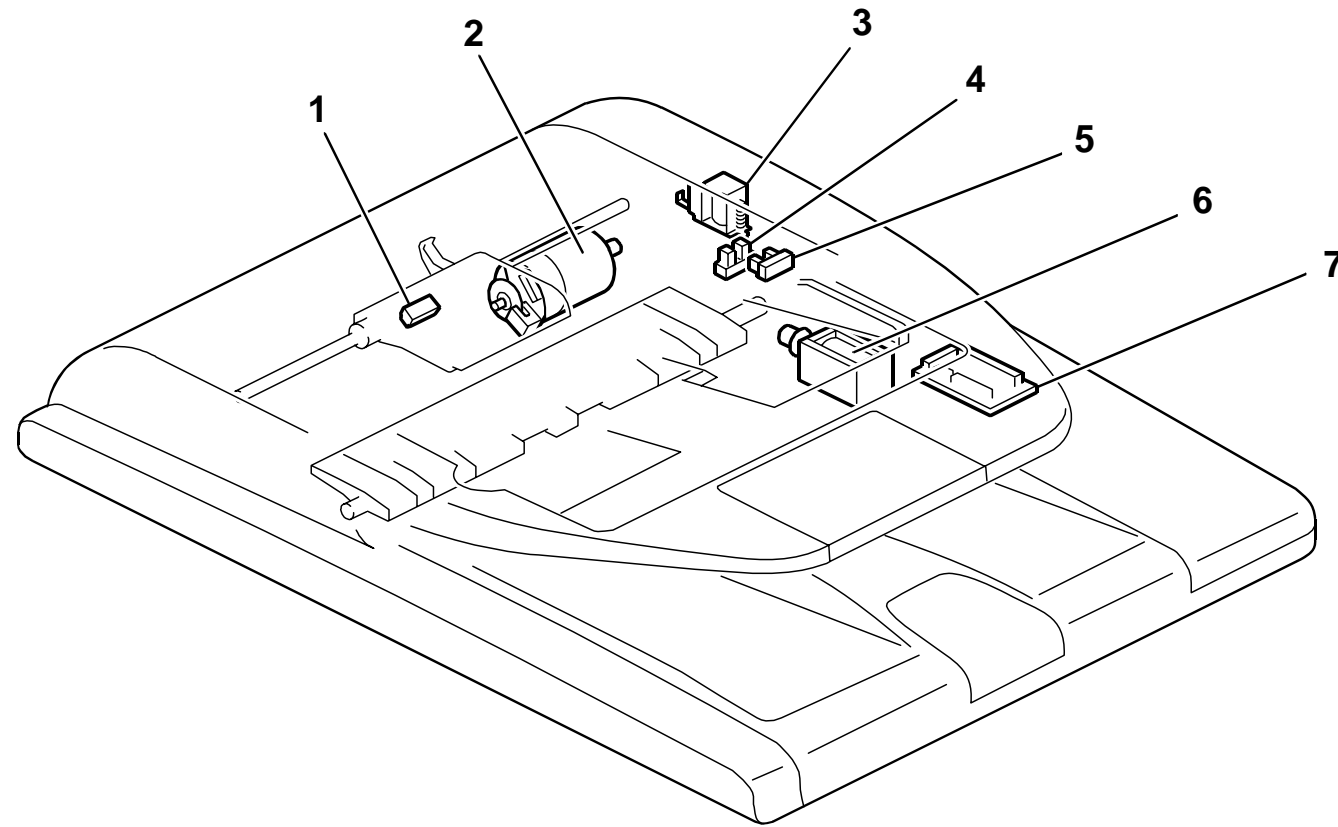

D606D102.Wmf

Symbol	Index No.	Description	P to P
Sensors			
S1	4	ADF Cover Sensor	E8
S2	5	Original Set Sensor	E8
S3	1	ARDF Registration Sensor	F8
Motor			
M1	2	ARDF Drive Motor	C9
Solenoids			
SOL1	3	ARDF Pick-up Solenoid	D8
SOL2	6	ARDF Reverse Solenoid	D8
PCB			
PCB1	7	ADF Relay Board	B4

D573 (Paper Feed Unit) POINT TO POINT DIAGRAM

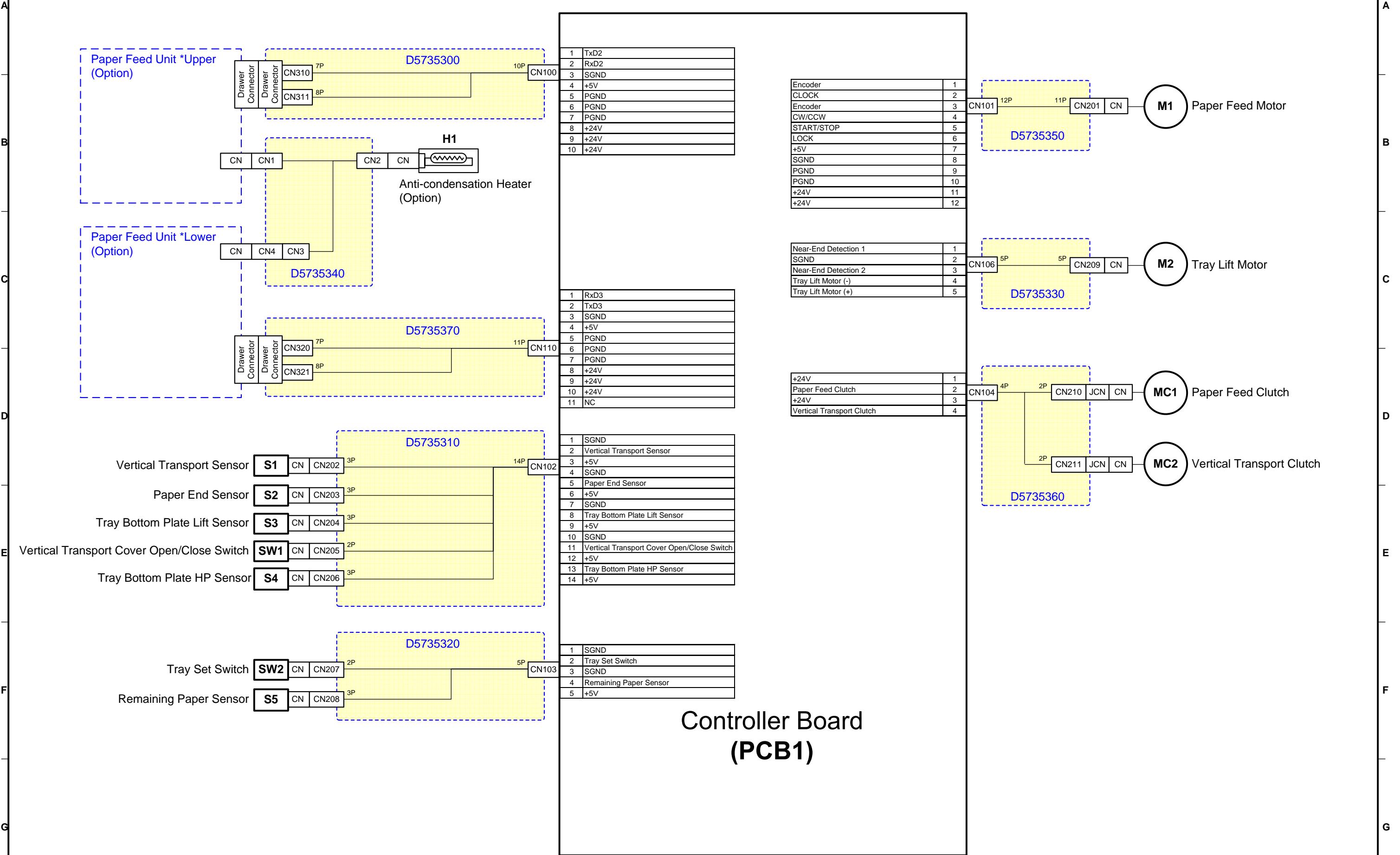

1	TxD2
2	RxD2
3	SGND
4	+5V
5	PGND
6	PGND
7	PGND
8	+24V
9	+24V
10	+24V

Encoder	1
CLOCK	2
Encoder	3
CW/CCW	4
START/STOP	5
LOCK	6
+5V	7
SGND	8
PGND	9
PGND	10
+24V	11
+24V	12

Near-End Detection 1	1
SGND	2
Near-End Detection 2	3
Tray Lift Motor (-)	4
Tray Lift Motor (+)	5

1	RxD3
2	TxD3
3	SGND
4	+5V
5	PGND
6	PGND
7	PGND
8	+24V
9	+24V
10	+24V
11	NC

+24V	1
Paper Feed Clutch	2
+24V	3
Vertical Transport Clutch	4

1	SGND
2	Vertical Transport Sensor
3	+5V
4	SGND
5	Paper End Sensor
6	+5V
7	SGND
8	Tray Bottom Plate Lift Sensor
9	+5V
10	SGND
11	Vertical Transport Cover Open/Close Switch
12	+5V
13	Tray Bottom Plate HP Sensor
14	+5V

1	SGND
2	Tray Set Switch
3	SGND
4	Remaining Paper Sensor
5	+5V

Controller Board (PCB1)

ELECTRICAL COMPONENT LAYOUT (D573)

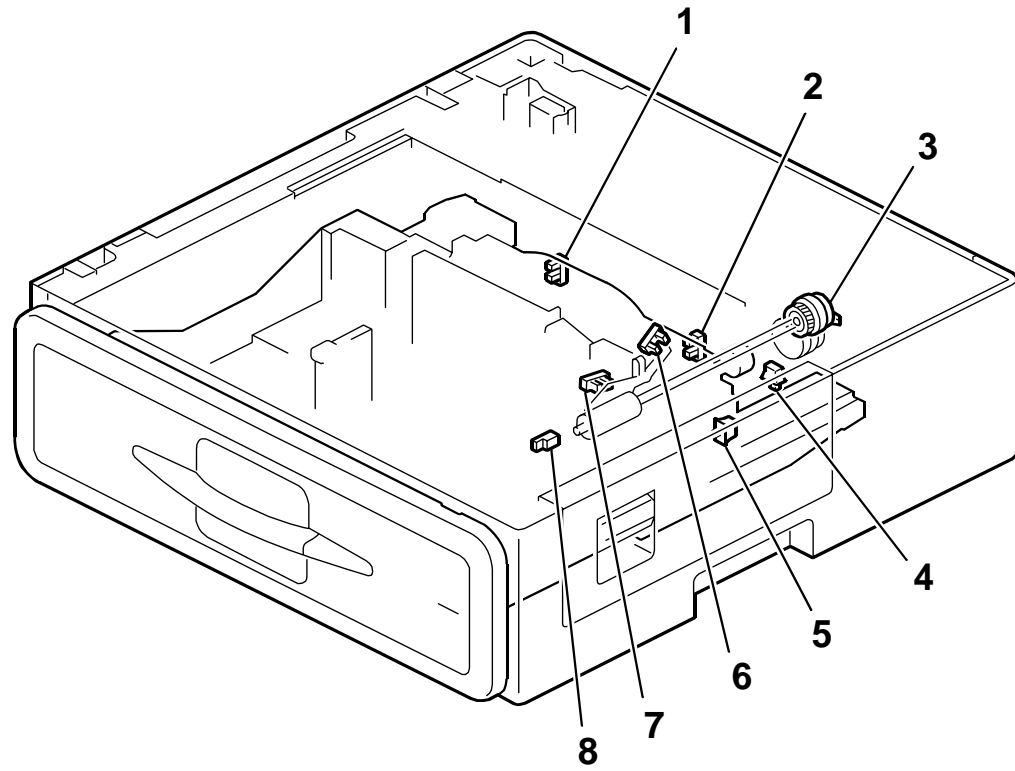

D573D104.Wmf

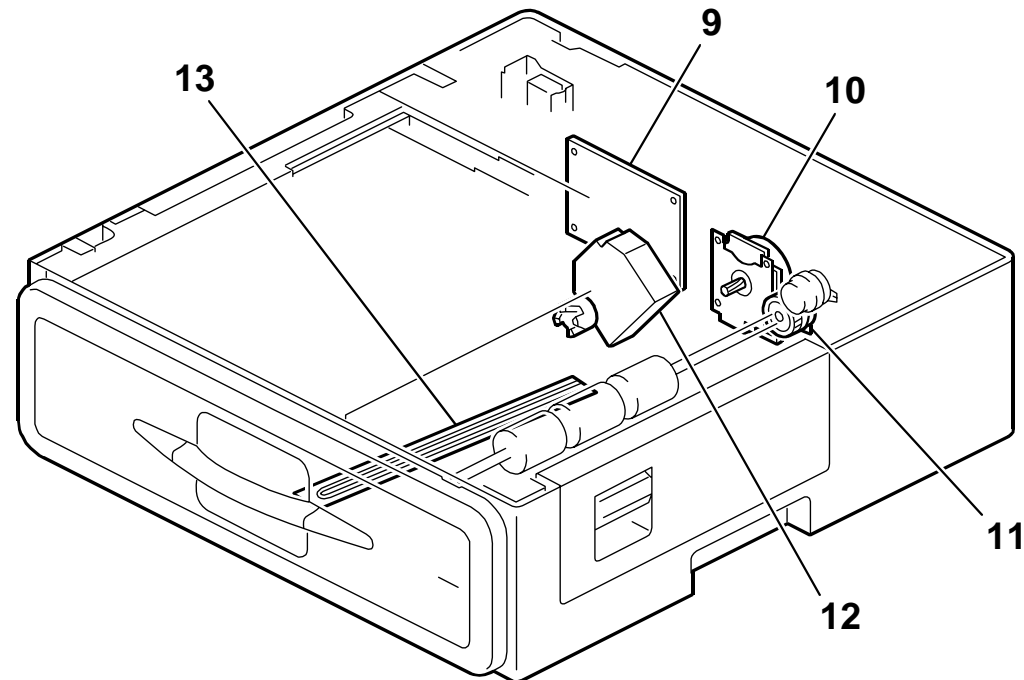

D573D103.Wmf

Symbol	Index No.	Description	P to P
Sensors			
S1	8	Vertical Transport Sensor	D2
S2	6	Paper End Sensor	E2
S3	1	Tray Bottom Plate Lift Sensor	E2
S4	2	Tray Bottom Plate HP Sensor	E2
S5	7	Remaining Paper Sensor	F2
Switches			
SW1	4	Vertical Transport Cover Open/Close Switch	E2
SW2	5	Tray Set Switch	F2
PCB			
PCB1	9	Controller Board	F6
Motors			
M1	10	Paper Feed Motor	B9
M2	12	Tray Lift Motor	C9
Magnetic Clutches			
MC1	11	Paper Feed Clutch	D9
MC2	3	Vertical Transport Clutch	D9
Other			
H1	13	Anti-condensation Heater	B4

D574 (1Bin Tray) POINT TO POINT DIAGRAM

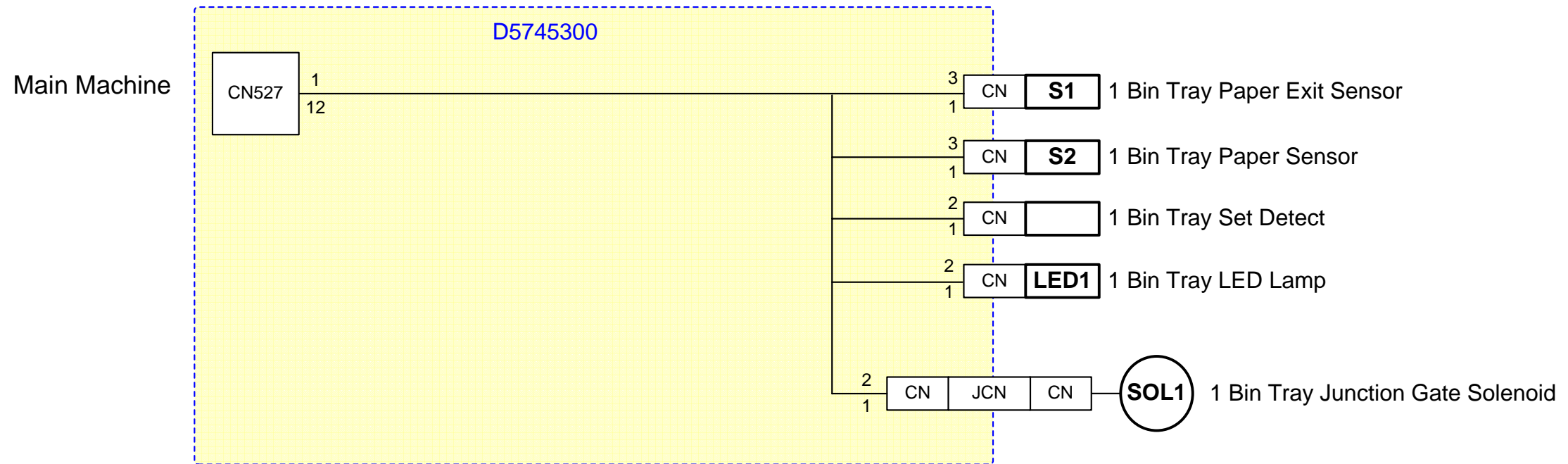

ELECTRICAL COMPONENT LAYOUT (D574)

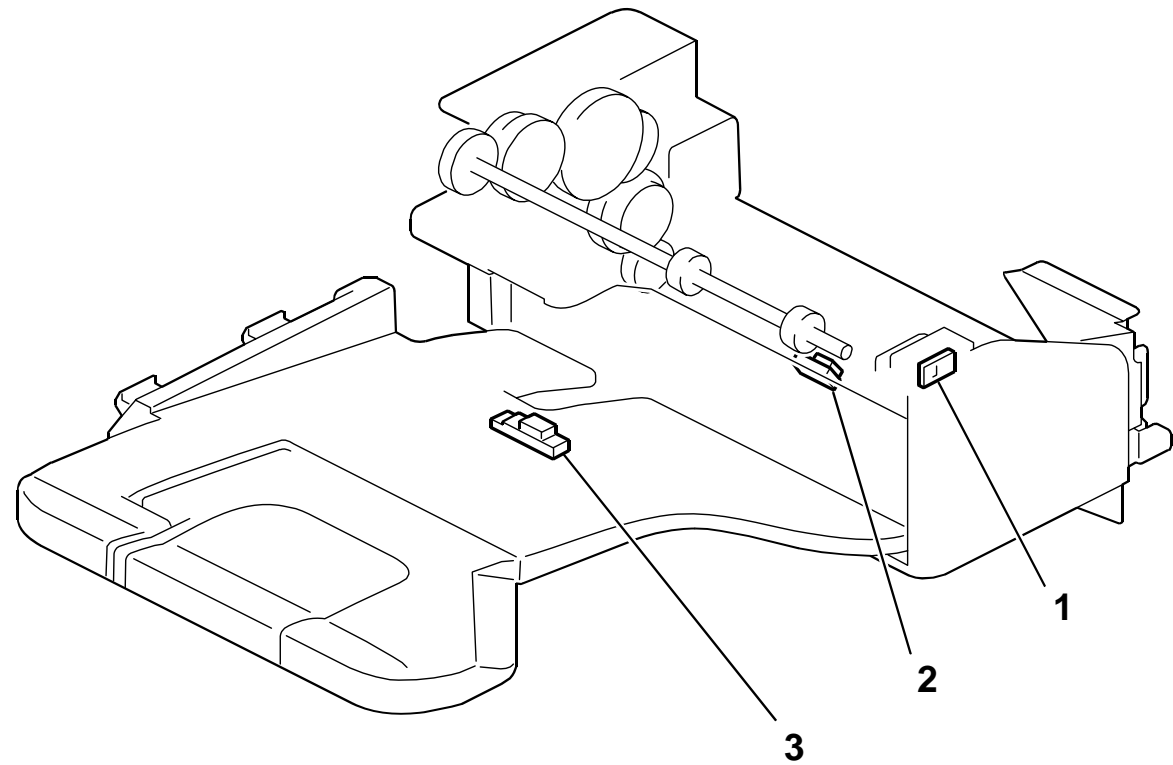

Symbol	Index No.	Description	P to P
Sensors			
S1		ADF Cover Sensor	C7
S2		Original Set Sensor	C7
Other			
LED1		ADF Relay Board	D7

D574D102.Wmf