

**Finisher SR5030**  
**(D513-EU)**  
**Parts Catalog**

**Parts change information sample**

 **Add**

 **Update**

 **Delete**

# Unit All



U001  
EXTERIOR



U002  
TRANSPORT SECTION

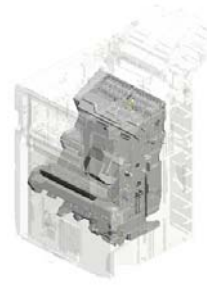

U003  
STAPLER SECTION



U004  
UNIFORM UNIT:EXIT:SIDE

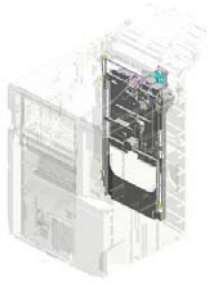

U005  
SHIFT TRAY SECTION



U006  
MECHANICAL DRIVE SECTION

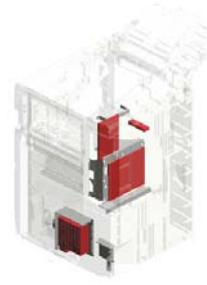

U007  
ELECTRICAL COMPONENTS



U008  
FRAME SECTION

# U001.EXTERIOR

U001\_S004  
D5127506  
SHIFT TRAY:ASS'Y

U001\_S002  
D5126240  
HINGE:DOOR:UPPER:ASS'Y

U001\_S001  
D5126220  
DOOR:FRONT:ASS'Y

U001\_S003  
D5126260  
HINGE:DOOR:LOWER:ASS'Y

U001	U002	U003	U004	U005	U006	U007	U008
------	------	------	------	------	------	------	------

# U001 EXTERIOR

4.04533006N (x2) TAPPING SCREW - M3X6  
 13.B7063035 GUIDE:MICRO SWI TCH:SHIFT TRAY  
 6.04543008Q (x14) TAPPING SCREW: 3X8  
 9.11050488 (x2) HARNESS CLAMP  
 19.D4477591 CUSHION:SPACER :440MM

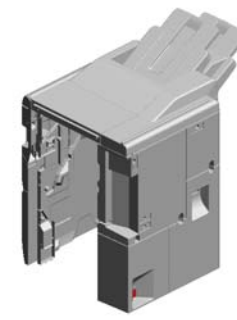

3.04523008N (x2) TAPPING SCREW - M3X8



12.B4786264 KEYTOP:PRINTING



14.B7065600 PCB:SWITCH-STO P



18.D4347740 DECAL:GUIDE PLATE:TURN-OPEN AND CLOSE:RB9



16.D4346102 INNER COVER:FR ONT:UPPER



23.D5126227 LEVER:GRIP



25.D5126229 TENSION SPRING: GRIP



22.D5126226 COVER:GRIP



24.D5126228 PLATE:MAGNET CATCH



17.D4346151 INNER COVER:FR ONT:LOWER



5.04543006Q (x8) TAPPING SCREW - M3X6



2.04513008N (x18) TAPPING SCREW - M3X8



1.04504008N (x6) TAPPING SCREW - M4X8



11.B2341293 LEVER - SAFETY SWITCH



21.D5126223 SHAFT:PLATE:MAGNET CATCH



# U001 EXTERIOR

45.D5127514 SHIFT TRAY:AUXILIARY:STACK  
 50.D5127522 TRAY:AUXILIARY:SHIFT TRAY  
 40.D5126627 COVER:TRAY:LOWER  
 33.D5126351 COVER:LEFT UPPER  
 39.D5126624 COVER:PROOF TRAY:ASSY

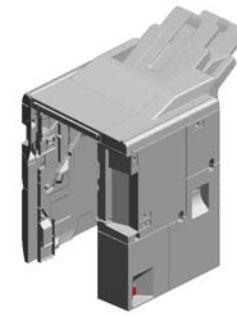

49.D5127519 (x4) TAPE:SHIFT TRAY:AUXILIARY

48.D5127518 (x2) TAPE:SHIFT TRAY:OUTER

47.D5127517 (x2) TAPE:SHIFT TRAY:MIDDLE

42.D5126711 COVER:SHIFT TRAY:FRONT

51.D5127800 DECAL:CAUTION:HINGE:DOOR

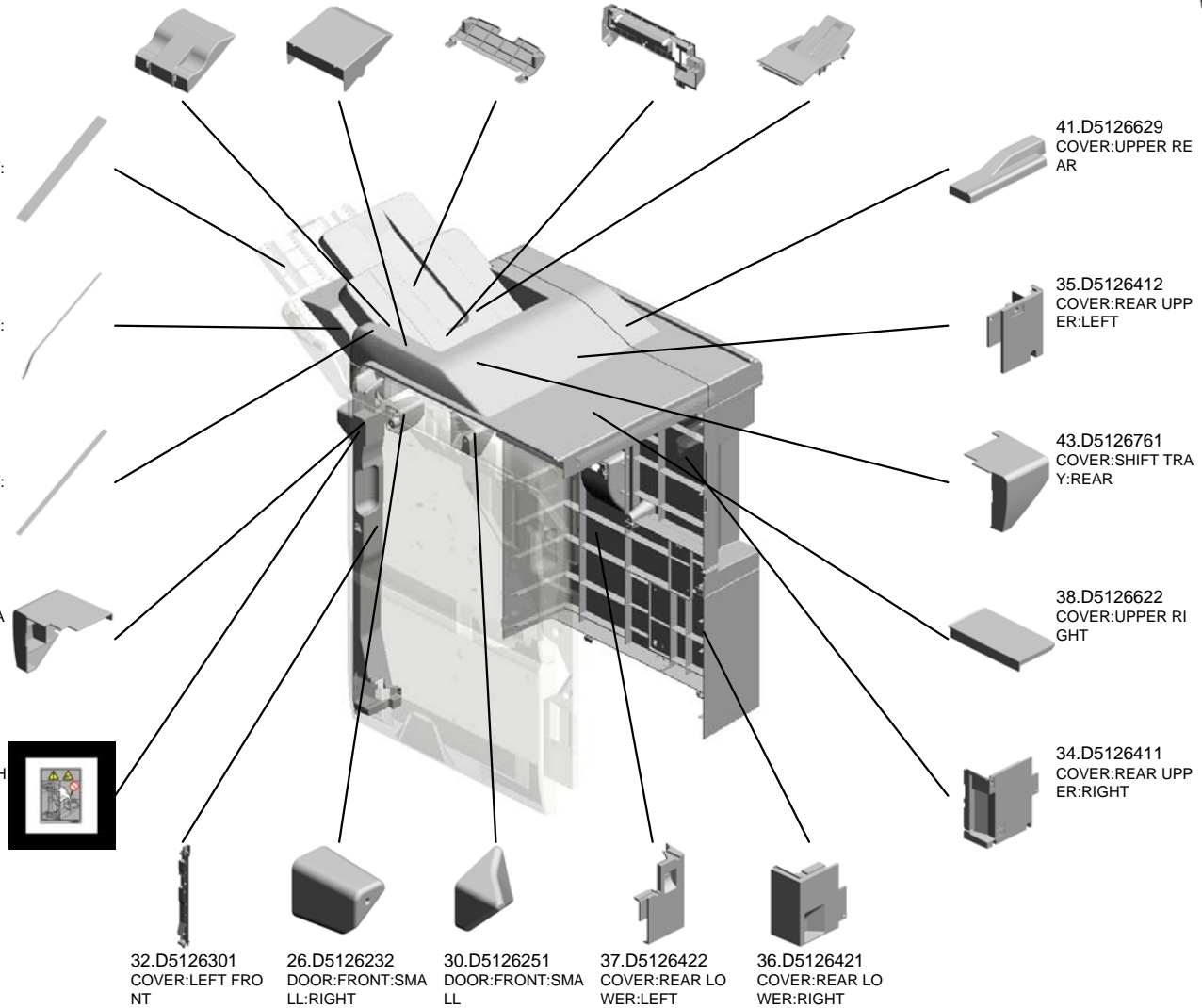

# U001 EXTERIOR

53.D5137810  
DECAL:MISFEED R  
EMOVAL



54.D5137815  
DECAL:STAPLE EX  
CHANGE

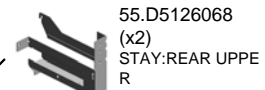
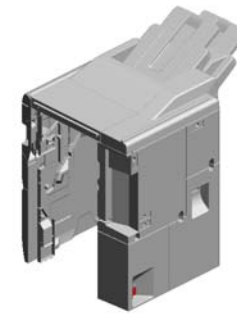
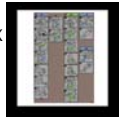

55.D5126068  
(x2)  
STAY:REAR UPPE  
R

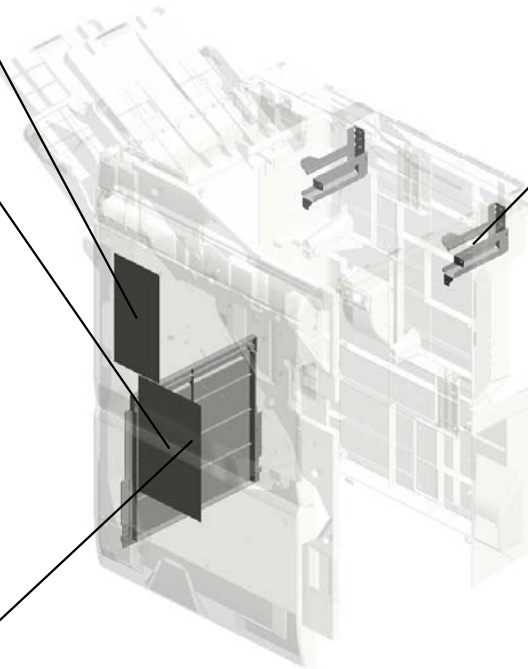

52.D5136501  
COVER:LEFT LOW  
ER



U001	U002	U003	U004	U005	U006	U007	U008
------	------	------	------	------	------	------	------

U001\_S001  
DOOR:FRONT:ASS'Y

7.07100060N (x2) HEXAGONAL NUT - M6	28.D5126246 (x2) SHAFT:HINGE:DO OR	1.04504008N (x4) TAPPING SCREW - M4X8
--	---	--

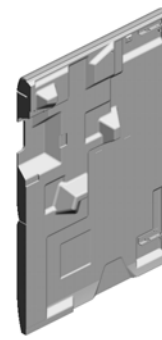

20.D5126220  
DOOR:FRONT:ASS  
Y

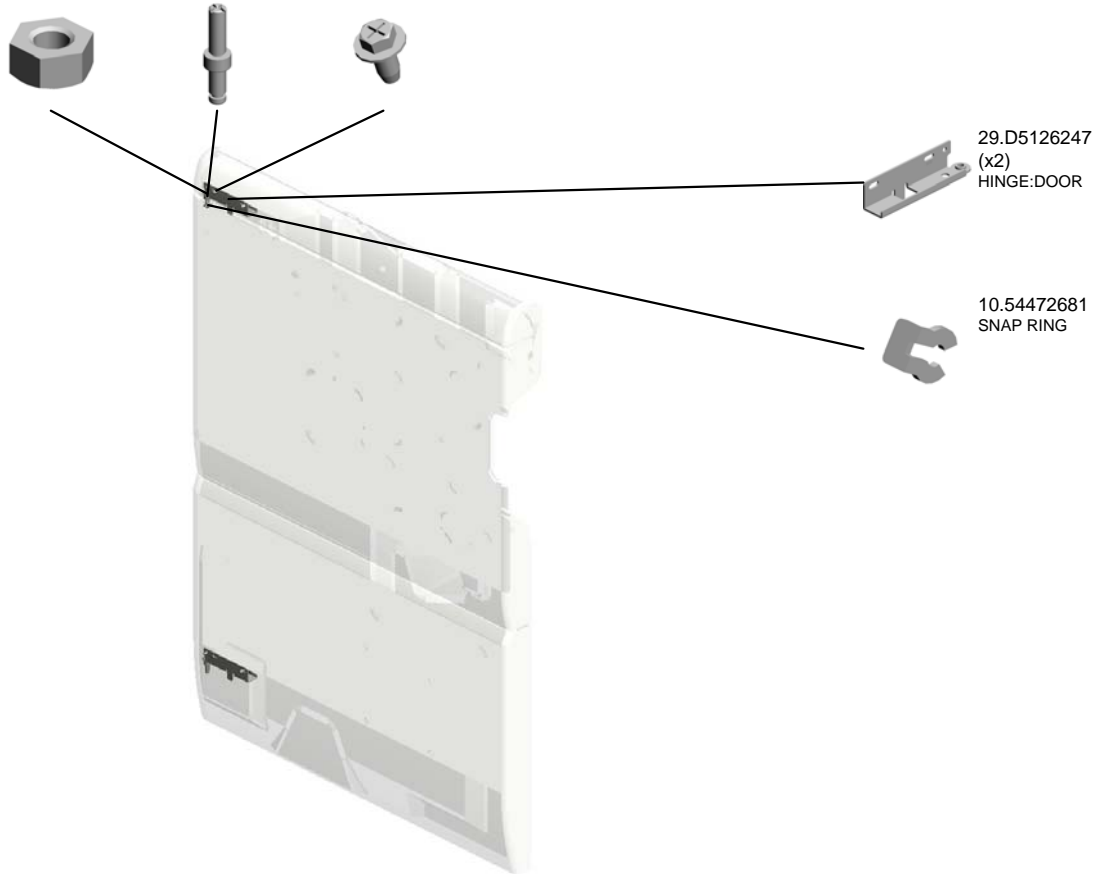

U001	U002	U003	U004	U005	U006	U007	U008
------	------	------	------	------	------	------	------



U001\_S002  
HINGE:DOOR:UPPER:ASS'Y

8.07200030E  
(x5)  
RETAINING RING -  
M3

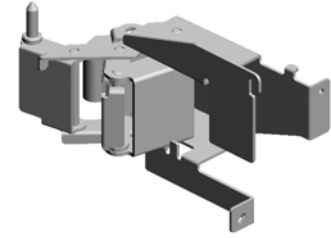
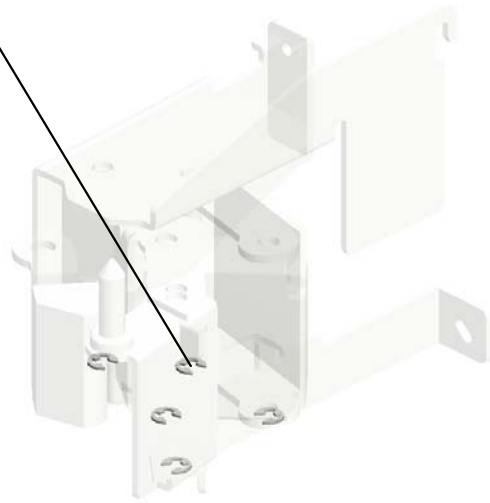
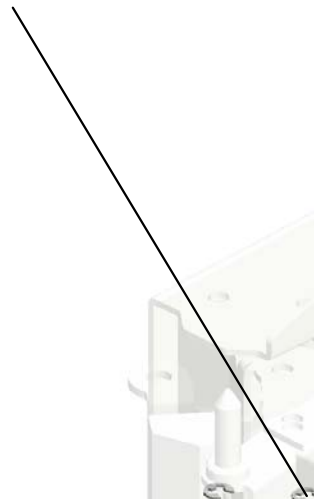

27.D5126240  
HINGE:DOOR:UPP  
ER:ASSY

U001	U002	U003	U004	U005	U006	U007	U008
------	------	------	------	------	------	------	------

U001\_S003  
HINGE:DOOR:LOWER:ASS'Y

8.07200030E  
(x5)  
RETAINING RING -  
M3

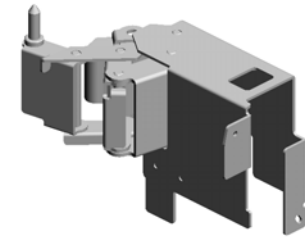
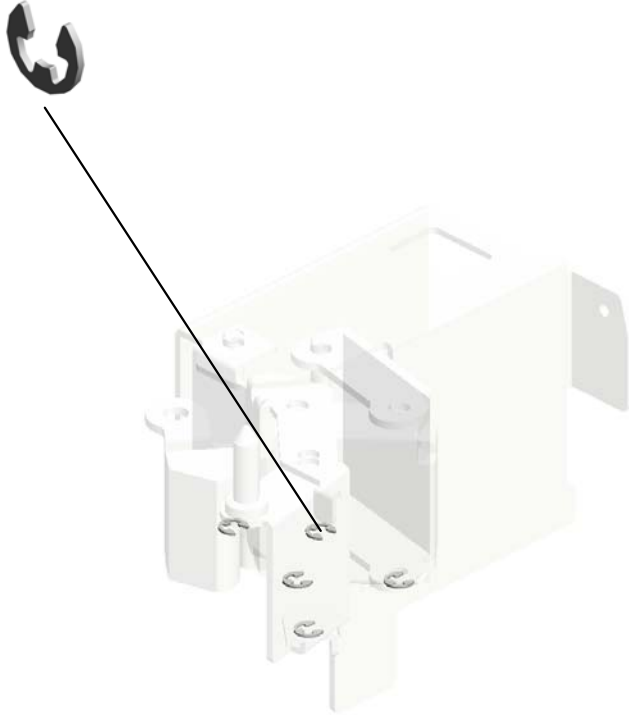

31.D5126260  
HINGE:DOOR:LOW  
ER:ASSY

U001\_S004  
SHIFT TRAY:ASS'Y

40.D5126627  
COVER:TRAY:LOW  
ER

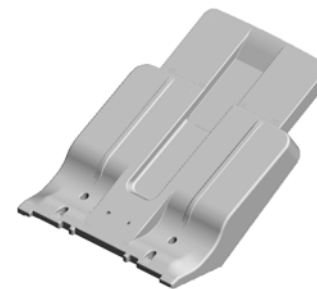
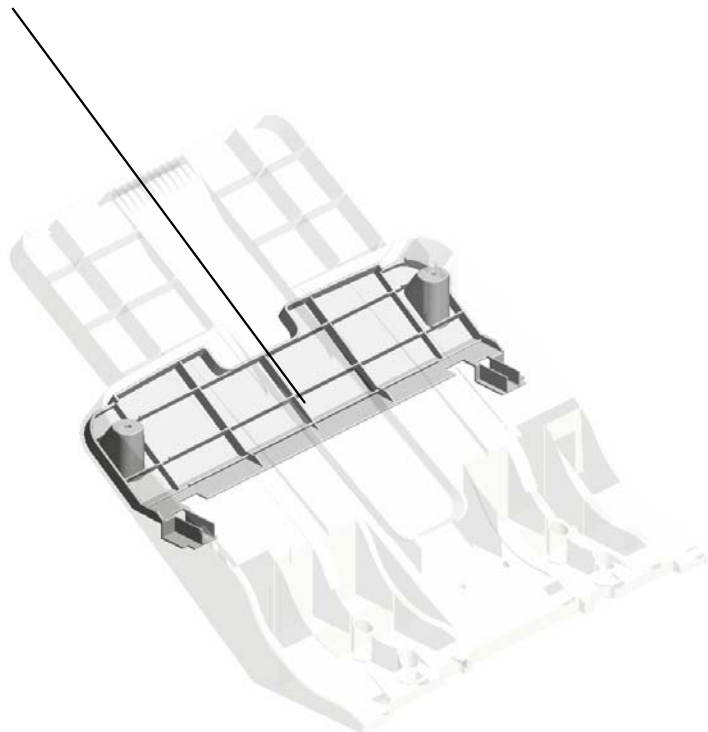

44.D5127506  
SHIFT TRAY:ASS'Y

U001	U002	U003	U004	U005	U006	U007	U008
------	------	------	------	------	------	------	------

# U002.TRANSPORT SECTION

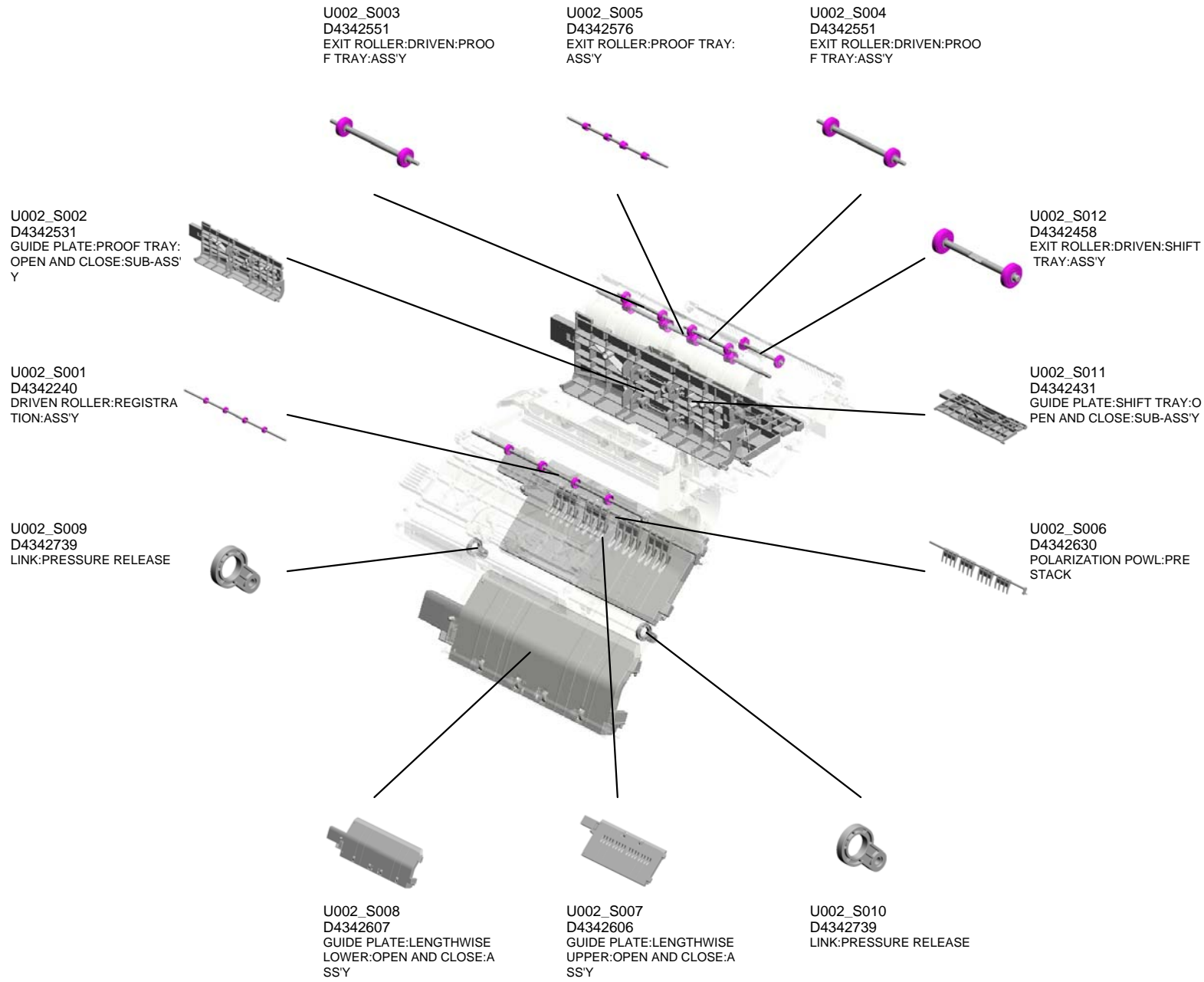

# U002 TRANSPORT SECTION

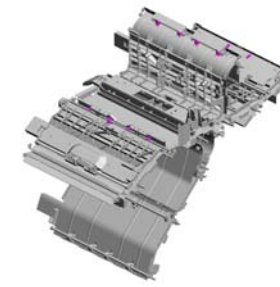

- 20.A2596590 (x2) BUSHING
- 6.04513014N TAPPING SCREW: 3X14
- 19.11050717 (x2) CLAMP:JDW-1S
- 12.07200060E (x4) RETAINING RING - M6
- 10.06330120G (x4) PARALLEL PIN - 3X12

15.08050089 (x3) RETAINING RING - M4



8.04543006Q (x61) TAPPING SCREW - M3X6



5.04513008N (x4) TAPPING SCREW - M3X8



11.07200040E (x20) RETAINING RING - M4



14.07413506 (x26) BALL BEARING - 6 X12X4 MM



17.11050522 (x5) EDGE SADDLE - L ES0510



2.04503008N (x17) TAPPING SCREW - M3X8



16.11050516 (x6) CLAMP



9.04543012Q (x2) TAPPING SCREW: 3X12



4.04513006N (x8) TAPPING SCREW - 3X6



21.A3533354 DRIVEN ROLLER HOLDER



18.11050623 (x5) CLAMP - LBWS-02 06S-V0



1.03130040N SCREW:M3X4



3.04504008N (x3) TAPPING SCREW - M4X8



7.04543006N (x4) TAPPING SCREW: ROUND POINT:3X6



# U002 TRANSPORT SECTION

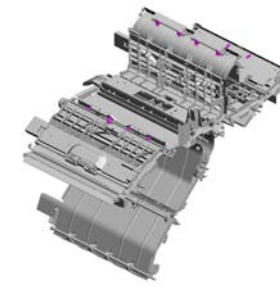

26.AA080237  
(x4)  
BUSHING - 4X5X7

38.B4782231  
ROLLER:EXIT:AUXILIARY:ASSY

34.AW010091  
(x2)  
PHOTO REFLECTIVE SENSOR

22.B3022216  
EXIT GUIDE - UPPER EXIT GUIDE

41.B7002317  
(x2)  
DISCHARGE BRUSH

37.B4082281  
(x2)  
KNOB - TRANSFER ROLLER

35.B3022305  
(x2)  
MIDDLE EXIT ROLLER

31.AG070513  
MAGNET CATCH

22.A3792215  
EXIT MYLAR

27.AA082101  
(x3)  
BUSHING - 6X10X6

23.A4221063  
SEAL - 0.7X13X20

32.AG070514  
(x4)  
MAGNET CATCH

33.AW010089  
PHOTOSENSOR - GP2A28C

25.AA063529  
(x4)  
PRESSURE SPRING - 14.5MM

39.B4782332  
SPRING PLATE:SHIFTER:EXIT

40.B7002145  
BRACKET:ENTRANCE SENSOR

29.AF022147  
(x2)  
DRIVEN ROLLER

28.AA120097  
(x2)  
ANTISTATIC BRUSH

36.B3022513  
(x2)  
SUPPORT PLATE - EXIT GATE

30.AF022148  
(x2)  
ROLLER:DRIVEN:LEFT=125

# U002 TRANSPORT SECTION

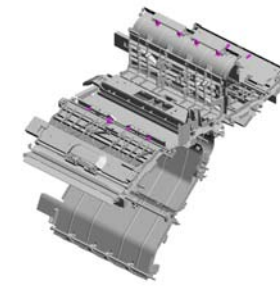

- 54.D4342121 GUIDE PLATE:REGISTRATION:OPEN AND CLOSE
- 57.D4342131 GUIDE PLATE:ENTRANCE:LOWER:ASSY
- 45.B7932154 RELEASE KNOB
- 46.D4342136 DISCHARGE BRUSH:EXIT
- 56.D4342127 SUPPORTING PLATE:GUIDE PLATE:OPEN AND CLOSE

47.B8301135  
(x3)  
SCREW



56.D4342129  
SUPPORTING PLATE:GUIDE PLATE:OPEN AND CLOSE



52.D4342111  
GUIDE PLATE:ENTRANCE:UPPER



50.B8307516  
GUIDE PLATE:CONNECTING:UPPER



49.B8307511  
CONNECTING GUIDE PLATE - LOWER



58.D4342135  
(x2)  
SEAL:0.1MM:GUIDE PLATE:ENTRANCE:LOWER



55.D4342125  
SEAL:0.188MM:GUIDE PLATE:REGISTRATION



59.D4342141  
(x4)  
TRANSPORT ROLLER:380MM:ENTRANCE



46.B8023756  
(x2)  
DISCHARGE BRUSH:EXIT



53.D4342115  
TENSION SPRING:ENTRANCE:2N



44.B7062323  
DISCHARGE BRUSH:H:L=320:MM3

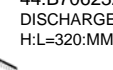

48.B8302327  
EXIT GUIDE BRACKET

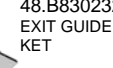

51.C1012360  
SNAP RING

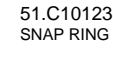

42.B7002476  
(x2)  
COMPRESSION SPRING:EXIT:DRIVEN

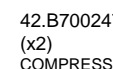

43.B7002520  
CUSHION:GATE PAWL

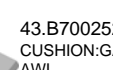

# U002 TRANSPORT SECTION

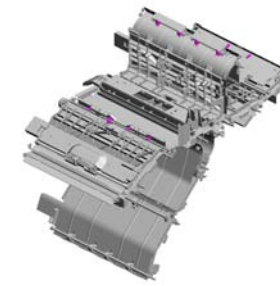

70.D4342341 GATE PAWL:PROOF TRAY  
 81.D4342511 TRANSPORT ROLLER:PROOF TRAY:DRIVE  
 87.D4342554 GUIDE PLATE:EXIT :PROOF TRAY  
 82.D4342521 TRANSPORT ROLLER:PROOF TRAY:DRIVE:REAR  
 85.D4342547 GUIDE PLATE:PROOF TRAY:ASSY

67.D4342326 GUIDE PLATE:GATE:UPPER:OPEN AND CLOSE

60.D4342211 GUIDE PLATE:HORIZONTAL:ASSY

66.D4342311 GUIDE PLATE:GATE:FRONT:ASSY

64.D4342261 (x2) HOLDER:DRIVEN ROLLER:REGISTRATION

65.D4342266 (x2) BUSHING:DRIVEN ROLLER:REGISTRATION

69.D4342331 GATE PAWL:STAPLE

63.D4342251 (x2) ARM:PRESSURE:DRIVEN ROLLER

68.D4342327 (x4) COMPRESSION SPRING:RING:1.5N

72.D4342433 GUIDE PLATE:SHIFT TRAY:LOWER:FIX

84.D4342535 TORSION SPRING:PROOF TRAY

75.D4342456 GUIDE PLATE:EXIT :UPPER

79.D4342493 [A] SHAFT:EXIT ROLLER  
201302-02 X/O

78.D4342474 (x2) ROLLER:EXIT ROLLER:SHIFT

74.D4342451 SHAFT:GUIDE PLATE:EXIT:UPPER

77.D4342465 GUIDE PLATE:EXIT :STAPLE:ASSY



# U002 TRANSPORT SECTION

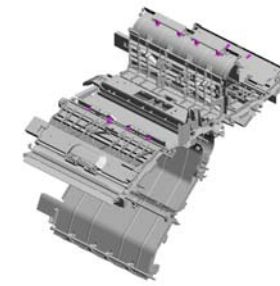

- 88.D4342556 (x4) COMPRESSION SPRING:2N
- 94.D4342612 (x2) MYLAR:GUIDE PLATE:TURN
- 111.D4342741 (x2) TRANSPORT ROLLER:PRE STACK:LOWER
- 93.D4342611 GUIDE PLATE:TURN:UPPER:OPEN AND CLOSE
- 89.D4342561 BRACKET:PAPER FEED SENSOR:PROOF TRAY

113.D4347705  
DECAL:REGISTRATION ROLLER:RB2



112.D4347700  
DECAL:GUIDE PLATE:REGISTRATION:OPEN AND CLOSE:RB1



101.D4342641  
GUIDE PLATE:DUPLEX STACK:UPPER



109.D4342735 (x2)  
COMPRESSION SPRING:8N



108.D4342733 (x2)  
ARM:PRESSURE:TRANSPORT ROLLER



104.D4342681  
GUIDE PLATE:LENGTHWISE:ASSY

107.D4342731  
TRANSPORT ROLLER:DUPLX STACK:UPPER

106.D4342721  
DRIVEN ROLLER:DUPLX STACK:UPPER

102.D4342651  
GUIDE PLATE:DUPLX STACK:LOWER

97.D4342621  
GUIDE PLATE:TURN:REAR

96.D4342615  
TENSION SPRING:TURN:6.3N



98.D4342625  
DISCHARGE BRUSH:H:TURN:REAR



105.D4342711  
TRANSPORT ROLLER:TURN



95.D4342613 (x2)  
DISCHARGE BRUSH:H:TURN



100.D4342635  
TENSION SPRING:POLARIZATION POSITION:PRESSURE



# U002 TRANSPORT SECTION

114.D4347710  
DECAL:GUIDE PLATE:GATE:OPEN AND CLOSE:RB3

123.D4342222  
TRANSPORT ROLLER:REGISTRATION:DRIVE  
201210-01 X/O

119.D4347735  
DECAL:PRE STACK:UPPER:RB8

121.GW010007  
(x3)  
PHOTO REFLECTION SENSOR:EXIT

122.D4342483  
GUIDE PLATE:EXIT:LOWER:ASS'Y  
1109-01 X/O

120.G1594627  
DISCHARGE BRUSH:REVERSE ROLLER

D4342479  
[A]  
SHAFT:EXIT ROLLER  
201302-02 X/O

U001	U002	U003	U004	U005	U006	U007	U008
------	------	------	------	------	------	------	------

U002\_S001  
DRIVEN ROLLER:REGISTRATION:ASS'Y

11.07200040E  
(x8)  
RETAINING RING -  
M4

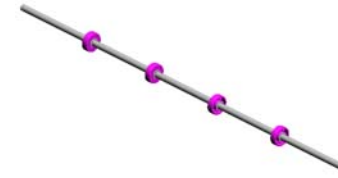

62.D4342240  
DRIVEN ROLLER:R  
EGISTRATION:ASS  
Y

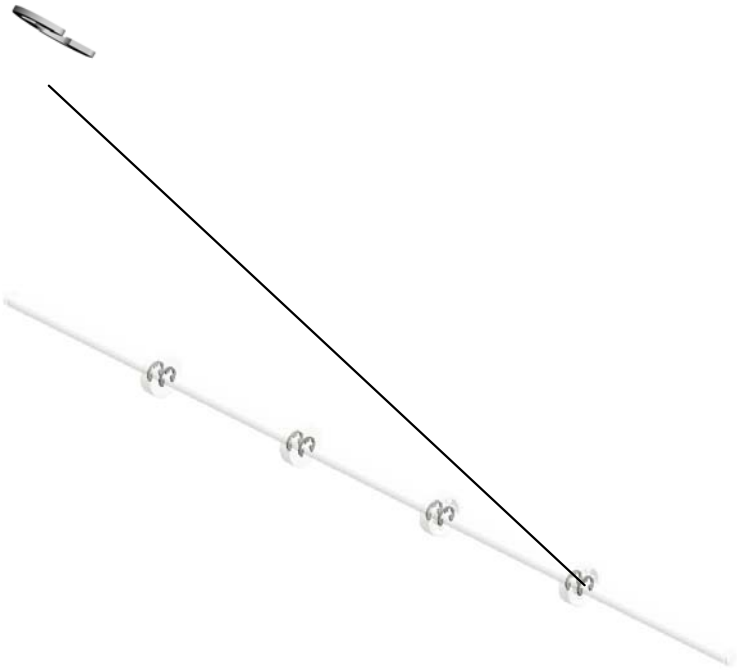

U001	U002	U003	U004	U005	U006	U007	U008
------	------	------	------	------	------	------	------

U002\_S002

GUIDE PLATE:PROOF TRAY:OPEN AND CLOSE:SUB-ASS'Y

32.AG070514  
(x2)  
MAGNET CATCH

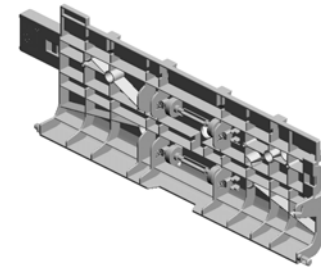

83.D4342531  
GUIDE PLATE:PRO  
OF TRAY:OPEN AN  
D CLOSE:SUB-ASS  
'Y

115.D4347715  
DECAL:GUIDE PLA  
TE:PROOF TRAY:O  
PEN AND CLOSE:R  
B4



29.AF022147  
(x2)  
DRIVEN ROLLER



73.D4342437  
(x4)  
COMPRESSION SP  
RING:2.5N

U001	<b>U002</b>	U003	U004	U005	U006	U007	U008
------	-------------	------	------	------	------	------	------

U002\_S003  
EXIT ROLLER:DRIVEN:PROOF TRAY:ASS'Y

11.07200040E  
(x4)  
RETAINING RING -  
M4



86.D4342551  
EXIT ROLLER:DRIV  
EN:PROOF TRAY:A  
SS'Y

U002\_S004  
EXIT ROLLER:DRIVEN:PROOF TRAY:ASS'Y

11.07200040E  
(x4)  
RETAINING RING -  
M4



86.D4342551  
EXIT ROLLER:DRIV  
EN:PROOF TRAY:A  
SS'Y

U002\_S005  
EXIT ROLLER:PROOF TRAY:ASS'Y

10.06330120G  
(x4)  
PARALLEL PIN - 3X  
12

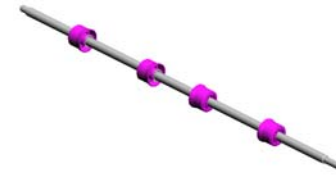

90.D4342576  
EXIT ROLLER:PRO  
OF TRAY:ASS'Y

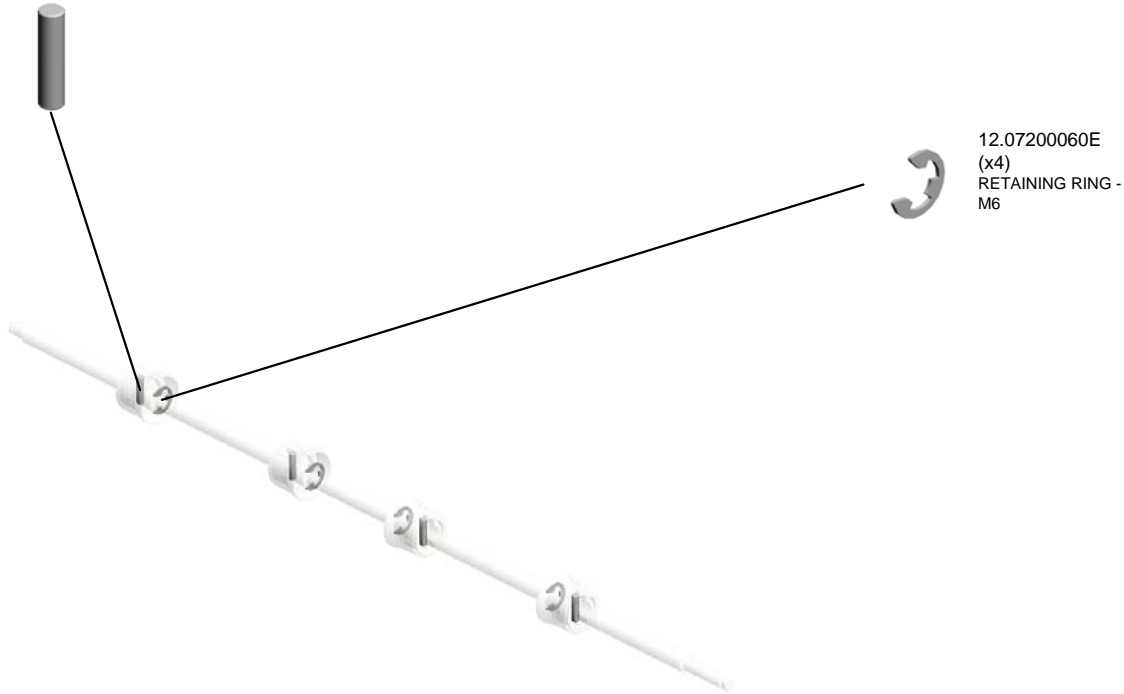

12.07200060E  
(x4)  
RETAINING RING -  
M6

U001	U002	U003	U004	U005	U006	U007	U008
------	------	------	------	------	------	------	------

U002\_S006  
POLARIZATION POWL:PRE STACK

24.A4582251  
CUSHION - BIN SO  
LENOID LEVER



99.D4342630  
POLARIZATION PO  
WL:PRE STACK

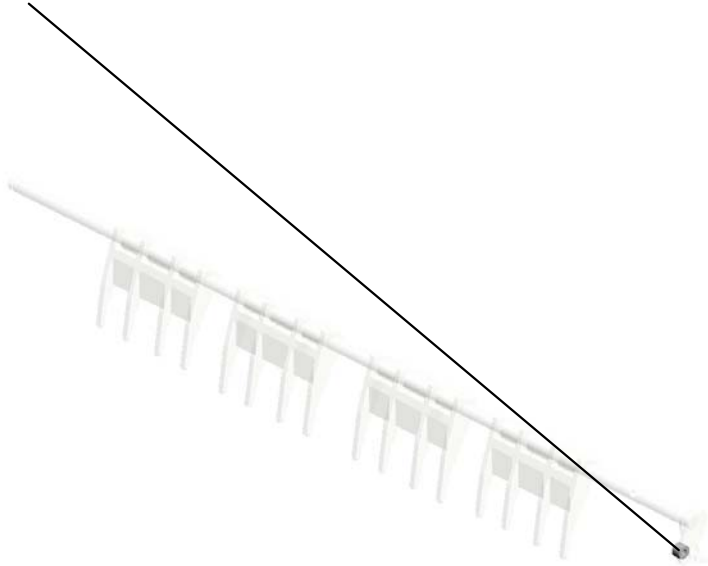

U001	U002	U003	U004	U005	U006	U007	U008
------	------	------	------	------	------	------	------



U002\_S007  
GUIDE PLATE:LENGTHWISE UPPER:OPEN AND CLOSE:ASS'Y

32.AG070514  
MAGNET CATCH



91.D4342606  
GUIDE PLATE:LEN  
GTHWISE UPPER:  
OPEN AND CLOSE:  
ASS'Y

117.D4347725  
DECAL:GUIDE PLA  
TE:LENGTHWISE  
UPPER:OPEN AND  
CLOSE:RB6

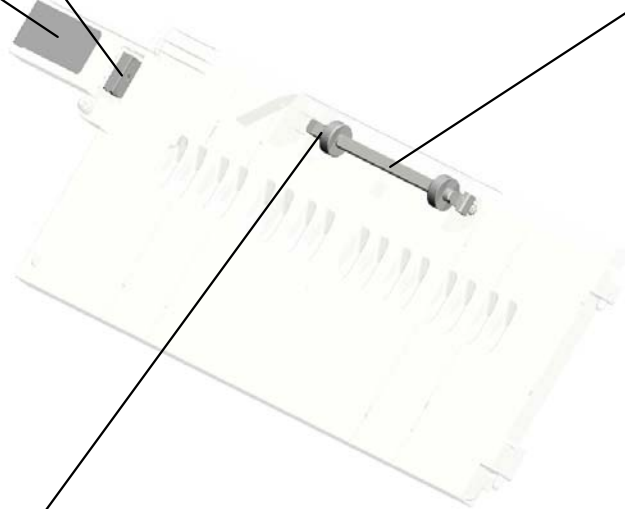

30.AF022148  
ROLLER:DRIVEN:L  
=125



103.D4342665  
(x2)  
COMPRESSION SP  
RING:6N

U001	U002	U003	U004	U005	U006	U007	U008
------	------	------	------	------	------	------	------

U002\_S008

GUIDE PLATE:LENGTHWISE LOWER:OPEN AND CLOSE:ASS'Y

118.D4347730  
DECAL:GUIDE PLATE:LENGTHWISE LOWER:OPEN AND CLOSE:RB7



32.AG070514  
MAGNET CATCH



30.AF022148  
(x2)  
ROLLER:DRIVEN:L  
=125



103.D4342665  
(x4)  
COMPRESSION SPRING:RING:6N

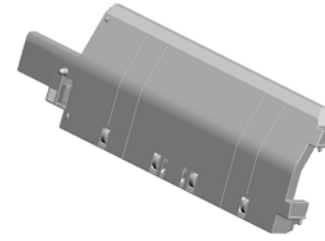

92.D4342607  
GUIDE PLATE:LENGTHWISE LOWER:OPEN AND CLOSE:ASS'Y

U001	U002	U003	U004	U005	U006	U007	U008
------	------	------	------	------	------	------	------

U002\_S009  
LINK:PRESSURE RELEASE

13.07403506  
BALL BEARING - 6  
X12X4 MM



110.D4342739  
LINK:PRESSURE R  
ELEASE



U001	U002	U003	U004	U005	U006	U007	U008
------	------	------	------	------	------	------	------

U002\_S010  
LINK:PRESSURE RELEASE

13.07403506  
BALL BEARING - 6  
X12X4 MM



110.D4342739  
LINK:PRESSURE R  
ELEASE



U001	<b>U002</b>	U003	U004	U005	U006	U007	U008
------	-------------	------	------	------	------	------	------

U002\_S011  
GUIDE PLATE:SHIFT TRAY:OPEN AND CLOSE:SUB-ASS'Y

32.AG070514  
(x2)  
MAGNET CATCH



71.D4342431  
GUIDE PLATE:SHIF  
T TRAY:OPEN AND  
CLOSE:SUB-ASS'Y

116.D4347720  
DECAL:GUIDE PLA  
TE:SHIFT TRAY:OP  
EN AND CLOSE:RB  
5

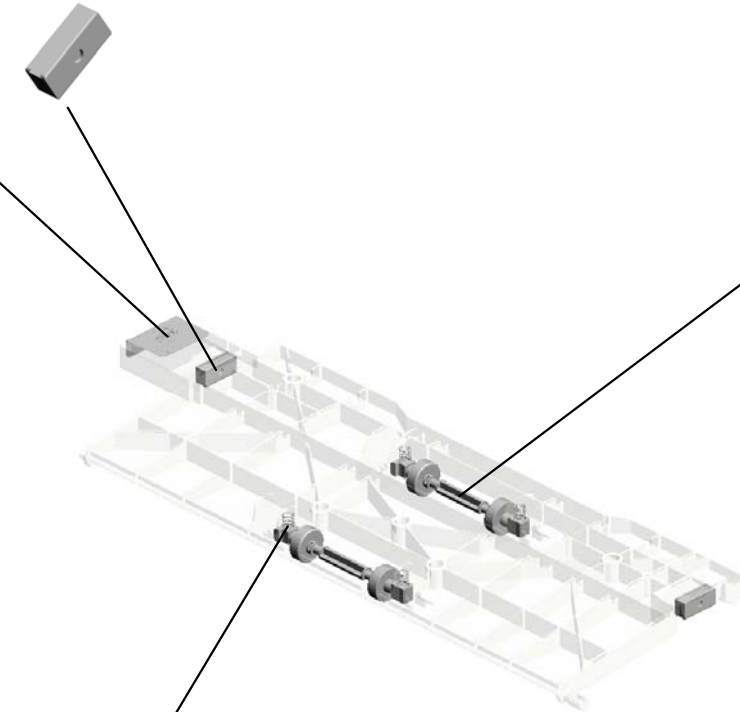

29.AF022147  
(x2)  
DRIVEN ROLLER

73.D4342437  
(x4)  
COMPRESSION SP  
RING:2.5N

U001	U002	U003	U004	U005	U006	U007	U008
------	------	------	------	------	------	------	------

U002\_S012  
EXIT ROLLER:DRIVEN:SHIFT TRAY:ASS'Y

11.07200040E  
(x4)  
RETAINING RING -  
M4

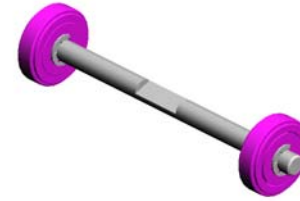

76.D4342458  
EXIT ROLLER:DRIV  
EN:SHIFT TRAY:AS  
SY

# U003.STAPLER SECTION

U003\_S001  
D4344470  
JOGGER FENCE:FRONT:AS  
S'Y

U003\_S008  
D5120113  
DC STEPPER MOTOR:2.26W  
:ASS'Y

U003\_S003  
D4344561  
BRACKET:SHAFT:EXIT:UPPE  
R:ASS'Y

U003\_S007  
D5120113  
DC STEPPER MOTOR:2.26W  
:ASS'Y

U003\_S002  
D4344490  
JOGGER FENCE:REAR:ASS'  
Y

U003\_S011  
D5120110  
DC STEPPER MOTOR:PLATE  
:1.79W:ASS'Y

U003\_S004  
D4344246  
GRIP:SLIDER:ASS'Y

U003\_S009  
D5120110  
DC STEPPER MOTOR:PLATE  
:1.79W:ASS'Y

U003\_S006  
D5120111  
DC STEPPER MOTOR:2.26W  
:ASS'Y

U003\_S010  
D5120110  
DC STEPPER MOTOR:PLATE  
:1.79W:ASS'Y

U003\_S005  
B8304275  
KNOB

U001	U002	U003	U004	U005	U006	U007	U008
------	------	------	------	------	------	------	------

# U003 STAPLER SECTION



- 22.07423808 (x4) BALL BEARING - 8 X16X5
- 6.04513008N (x20) TAPPING SCREW - M3X8
- 14.06320100G PIN - 2X10MM
- 21.07413706 (x4) BALL BEARING - 6 X10X3
- 5.04513006N (x55) TAPPING SCREW - 3X6

10.04543006Q (x108) TAPPING SCREW - M3X6

16.07200040E (x43) RETAINING RING - M4

20.07413506 (x8) BALL BEARING - 6 X12X4 MM

9.04514010N TAPPING SCREW: 4X10

7.04513014N TAPPING SCREW: 3X14

17.07200060E (x12) RETAINING RING - M6

13.04544008Q (x4) TAPPING SCREW - M4X8

4.04503008N (x28) TAPPING SCREW - M3X8

2.03530040N (x6) SCREW - M3X4

18.07403506 (x2) BALL BEARING - 6 X12X4 MM

15.06330160G (x2) PARALLEL PIN - 3X 16MM

11.04543008Q (x9) TAPPING SCREW: 3X8

1.03130080N PAN HEAD SCREW :M3X8

8.04514006N (x8) TAPPING SCREW - 4X6

12.04544006Q (x2) TAPPING SCREW: 4X6



# U003 STAPLER SECTION

42.A3003634 (x2) SPRING PLATE - TILING BELT  
 41.59192132 POSITIONING ROLLER BELT  
 40.59192127 POSITIONING ROLLER PULLEY  
 23.08046123 (x2) HEXAGONAL BOLT :W/WASHER:M3X8  
 38.52152621 (x4) SNAP RING - M6



25.08050089 (x21) RETAINING RING - M4

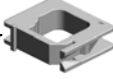

37.52062686 SNAP RING

28.11050489 (x3) HARNESS CLAMP - LWS 1316

32.11050518 (x2) EDGE SADDLE - L ES-1010

33.11050521 CLAMP - LES-1017

31.11050516 (x24) CLAMP

29.11050508 (x19) HARNESS CLAMP - LWS-0711

30.11050514 (x2) EDGE SADDLE - E DS-0607L

36.52012722 (x3) BUSHING - M6X5

26.08050092 RETAINING RING - 3M

27.11050487 (x4) HARNESS CLAMP

# U003 STAPLER SECTION



- 56.AA082101 (x2) BUSHING - 6X10X6
- 52.A8594141 PULLEY IDLER
- 51.A8592230 (x4) BALL BEARING - 6 X13X5
- 53.AA043593 TIMING BELT - 40S 3M324
- 58.AA143790 (x6) SCREW:CONTACT POINT

62.AG070514 (x2) MAGNET CATCH

60.AB030609 PULLEY - 20T

61.AF022148 ROLLER:DRIVEN:L=125

59.AB030278 (x4) IDLER - 20Z

54.AA043962 (x3) TIMING BELT - B40 S2M214

45.A6663180 (x9) TIMING PULLEY - Z32

44.A3774741 (x2) ROLLER - M14

46.A6812742 DRIVEN EXIT ROLLER

43.A3761343 ORIGINAL PRESSURE ROLLER

47.A6972102 DAMPER - JUNCTION GATE SOLENOID

55.AA062334 (x3) TENSION SPRING: 4.9N

50.A6972260 (x2) PULLEY - 17T

57.AA120097 ANTISTATIC BRUSH

49.A6972138 (x2) BRUSH ROLLER

48.A6972132 (x2) JOINT - BRUSH ROLLER

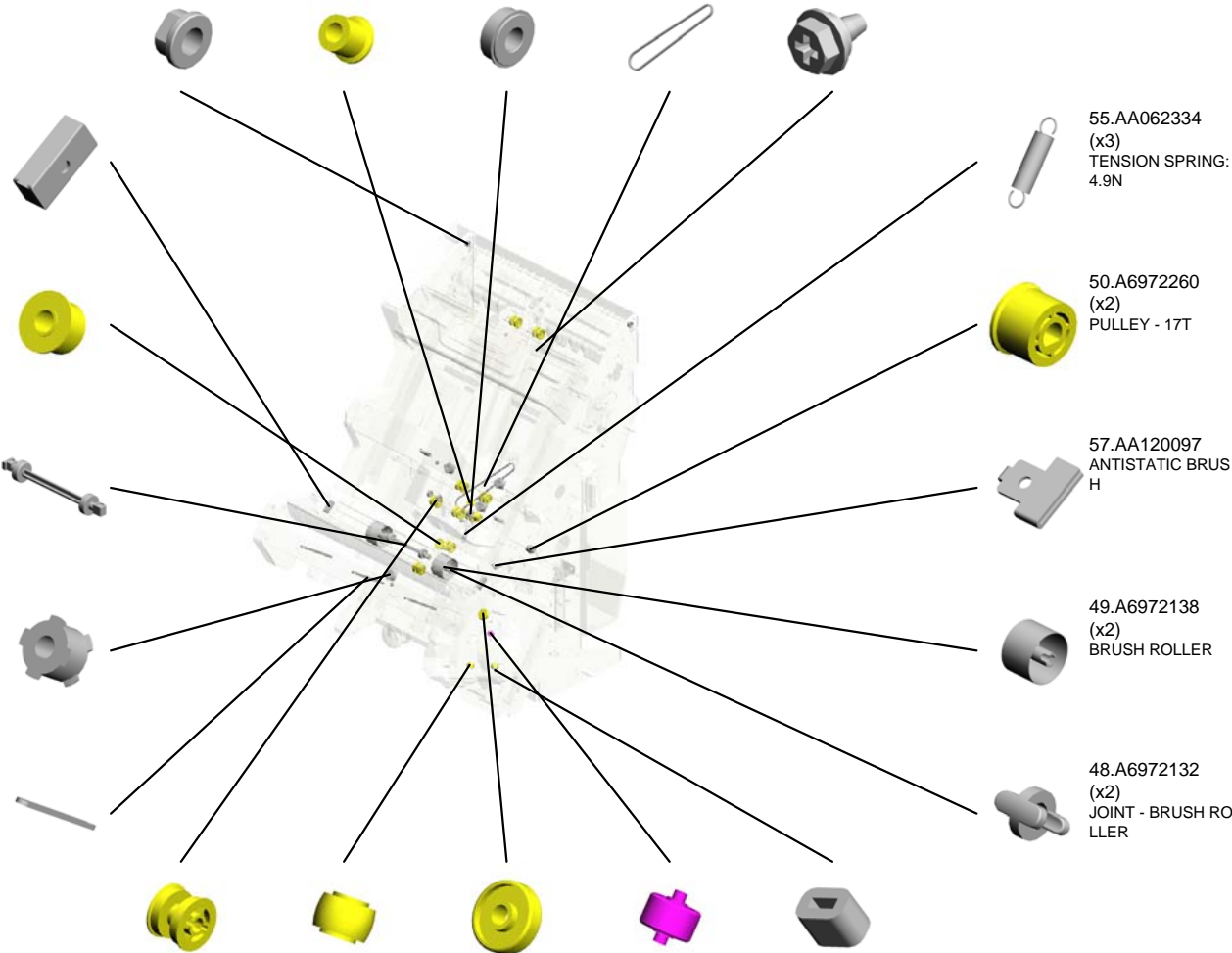

# U003 STAPLER SECTION

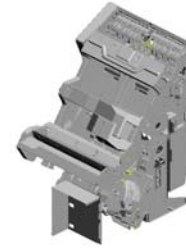

69.B3022413  
(x2)  
BRUSH ROLLER

74.B3024731  
LOWER EXIT SHAF  
T

78.B4782116  
REVERSE ROLLER  
- STAPLER TRAY

67.AW020156  
(x10)  
PHOTOINTERRUP  
TOR:EE-SX4235A-  
P2

68.AW020182  
(x2)  
PHOTOINTERRUP  
TOR

72.B3024517  
(x2)  
MYLAR GUIDE

65.AW010109  
PHOTO REFLECTIO  
N SENSOR:PS117E  
D1

70.B3024113  
BUSHING - 6X9MM

80.B4784135  
(x3)  
TIMING PULLEY:18  
T

77.B4684766  
TIGHTENER

63.AH012050  
[A]  
CASTER:STOPPER  
:NO  
201302-01 O/O

82.B4784257  
TENSION SPRING:  
TIGHTENER

79.B4784132  
(x2)  
SLIDER:VIBRATIN  
G PLATE

64.AJ011023  
STAPLER:EH-1200  
R

75.B3024756  
TIMING BELT - 753  
P3M6

66.AW010124  
PHOTO REFLECTIO  
N SENSOR:GP2A2  
00LCS0F

76.B3521607  
TIMING PULLEY - T  
20-S3M

83.B4784291  
BRACKET:STAY:TI  
MING BELT

71.B3024292  
BELT HOLDER

81.B4784256  
TIMING PULLEY:20  
T-30T

# U003 STAPLER SECTION

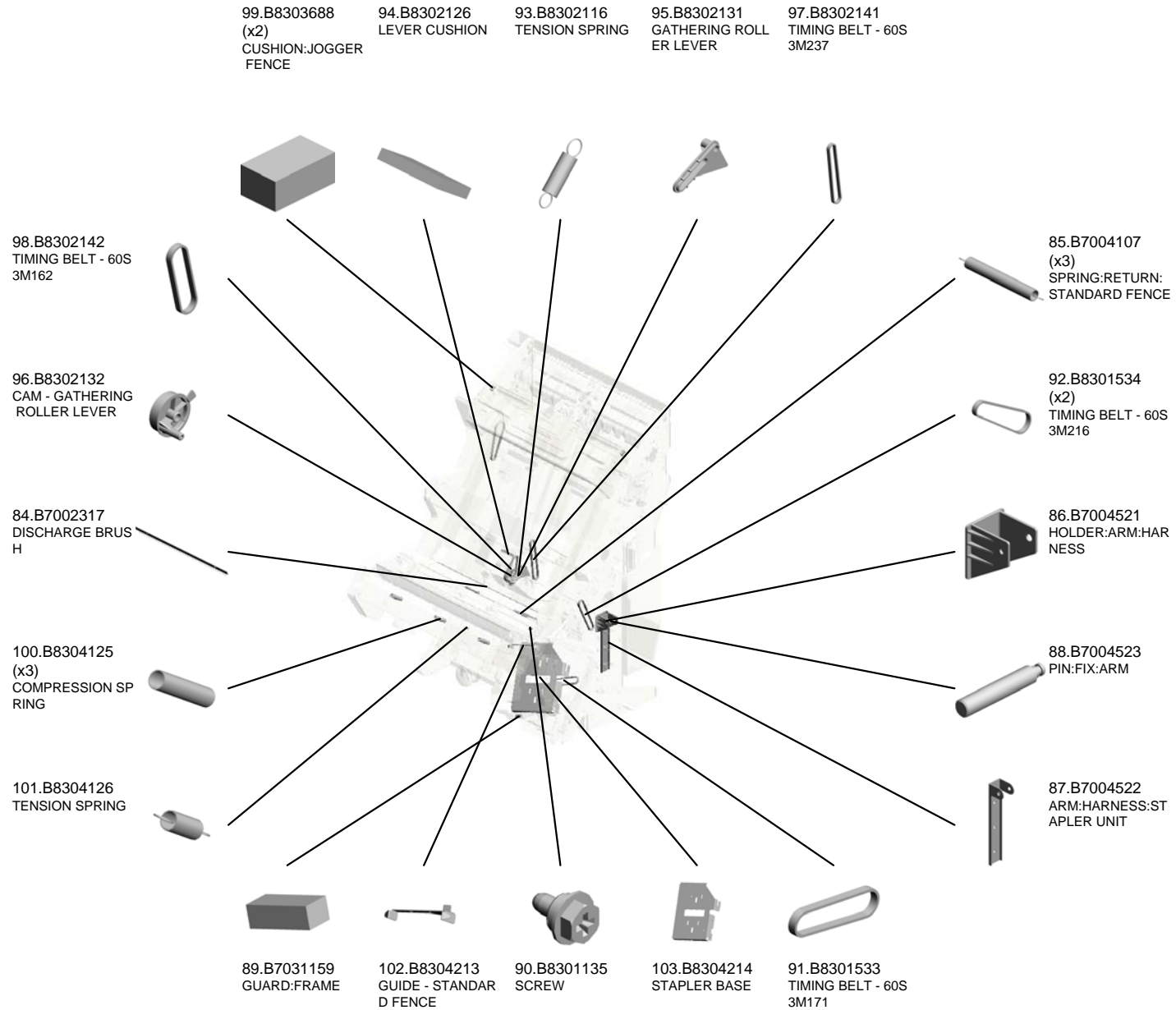
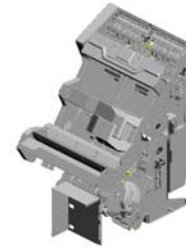

# U003 STAPLER SECTION



109.B8304245  
(x2)  
BALL BEARING

114.B8304271  
GEAR - 166Z

124.B8304884  
TIMING BELT - 60S  
3M204

126.B8305564  
(x2)  
STEPPER MOTOR  
DC1.35V 4W

125.B8305562  
(x2)  
STEPPER MOTOR  
DC1.56V 3.7W

121.B8304518  
SLIDER HOOK SHAFT

120.B8304517  
SLIDER HOOK BRACKET

106.B8304221  
STAPLER HOLDER

110.B8304249  
SENSOR BRACKET

104.B8304215  
STAPLER COVER - FRONT

111.B8304261  
WORM GEAR

105.B8304216  
COVER - STAPLER  
HARNESS

118.B8304285  
TENSION SPRING

107.B8304231  
STAPLER HOLDER  
- MIDDLE

117.B8304284  
STAPLER LEVER

108.B8304236  
SLIDER:BASE:STAPLER:ASSY

119.B8304286  
DC SOLENOID 24V

116.B8304281  
LEVER BRACKET

112.B8304262  
PULLEY - 19T

113.B8304263  
TIMING BELT - 60S  
2M140

# U003 STAPLER SECTION



130.B8722614  
(x2)  
BUSHING:R1

139.D4344171  
STAY:GUIDE PLAT  
E:EXIT:STAPLE

141.D4344181  
EXIT ROLLER:LOW  
ER:SUB-ASS'Y

144.D4344231  
STAPLER TRAY:FR  
ONT

146.D4344250  
STAPLER TRAY:MI  
DDLE:ASS'Y

131.D4342665  
(x2)  
COMPRESSION SP  
RING:6N

138.D4344166  
GUIDE PLATE:EXIT  
:STAPLE

136.D4344157  
GUIDE PLATE:CON  
NECTING

135.D4344151  
GUIDE PLATE:EXIT  
:LOWER:STAPLER  
TRAY

129.B8722515  
CUSHION:BRACKE  
T:FEED

134.D4344126  
BRACKET:CASTER

147.D4344261  
STANDARD FENCE  
:MOVEABLE

137.D4344162  
BRACKET:PAPER  
FEED SENSOR:ST  
APLER TRAY

142.D4344211  
COVER:STAPLER:  
REAR

127.B8305574  
STEPPER MOTOR  
DC2.2V 5.7W

143.D4344221  
STAPLER TRAY:RE  
AR

133.D4344116  
BRACKET:CONNE  
CTOR:STAPLER T  
RAY:MOVEABLE

132.D4344106  
STOPPER:STAPLE  
R UNIT

148.D4344262  
SLIDER:STANDAR  
D FENCE:MOVEAB  
LE

140.D4344172  
TORSION SPRING:  
STAPLE:EXIT

# U003 STAPLER SECTION



151.D4344265 TIMING BELT:40S3 M237  
 150.D4344264 PULLEY:T18:T28  
 166.D4344414 STAY:STAPLER TRAY:MIDDLE:ASS'Y  
 152.D4344270 BRACKET:MOTOR:STANDARD FENCE  
 168.D4344419 (x2) TIMING BELT:60S3 M552

154.D4344315 SHAFT:STANDARD FENCE:SLIDE:FRONT

149.D4344263 (x2) SHAFT:GUIDE:STANDARD FENCE:MOVEABLE

158.D4344325 SLIDER:STANDARD FENCE:FRONT

159.D4344327 STANDARD FENCE:FRONT:ASS'Y

156.D4344317 BRACKET:SENSOR:EXIT BELT

153.D4344310 STAY:STANDARD FENCE

165.D4344377 STANDARD FENCE:REAR:ASS'Y

163.D4344356 SHAFT:STAPLER:MOVE

160.D4344335 SLIDER:STANDARD FENCE:REAR

162.D4344347 STANDARD FENCE:REAR:AUXILIARY:ASS'Y

167.D4344415 (x2) TENSIONER:JOGGER FENCE:ASS'Y

157.D4344318 BRACKET:SENSOR:PAWL:STOPPER

155.D4344316 SHAFT:STANDARD FENCE:SLIDE:REAR

161.D4344345 SLIDER:STANDARD FENCE:AUXILIARY

164.D4344361 HOOK:SLIDER:STANDARD FENCE:REAR

# U003 STAPLER SECTION



178.D4344530 TENSIONER:STOP  
PER:LEADING EDG  
E:REAR

189.D4344569 TIMING PULLEY:EX  
IT BELT:T56

183.D4344555 SHAFT:EXIT BELT:  
UPPER:ASS'Y

180.D4344539 (x2)  
TENSION SPRING:  
STOPPER:LEADIN  
G EDGE

184.D4344557 (x2)  
TIMING PULLEY:T1  
9:S3M

179.D4344535  
TENSIONER:STOP  
PER:LEADING EDG  
E:FRONT

188.D4344568  
TIMING PULLEY:T3  
0:S3M

187.D4344567  
TIMING BELT:60S3  
M324

182.D4344553  
SHAFT:EXIT:DRIVE

195.D4344653  
(x4)  
SHAFT:VIBRATING  
PLATE:BOTH END  
S

169.D4344451  
(x2)  
SHAFT:JOGGER F  
ENCE:SLIDE

192.D4344622  
ARM:POSITIONING  
ROLLER:ASS'Y

191.D4344621  
BRACKET:POSITIO  
NING ROLLER

193.D4344625  
SHAFT:POSITIONI  
NG ROLLER:DRIVE

186.D4344565  
TENSIONER:EXIT:  
ASS'Y

176.D4344510  
(x2)  
PAWL:STOPPER:A  
SS'Y

181.D4344550  
EXIT BELT:ASS'Y

190.D4344606  
GUIDE:LEADING E  
DGE:FIX

194.D4344641  
INNER COVER:PO  
SITIONING ROLLE  
R UNIT

177.D4344511  
SHAFT:STOPPER:L  
EADING EDGE:DRI  
VE:ASS'Y



# U003 STAPLER SECTION

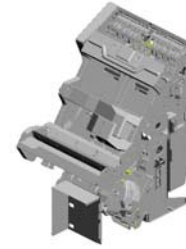

- 210.D4344857 (x2) TENSION SPRING: 1.60N
- 203.D4344730 GUIDE PLATE:PRE SSURE:TRANSPOR T
- 205.D4344756 TRANSPORT ROLL ER:PRESSURE:INN ER
- 209.D4344856 GUIDE:TURN:MOV EABLE
- 206.D4344757 GEAR:DRIVE:TRAN SPORT ROLLER:P RESSURE

204.D4344731 (x2) TENSION SPRING: 1.02N

208.D4344806 SHAFT:CAM:PRES SURE SUB-UNIT:O PEN AND CLOSE

213.D4347755 DECAL:STAPLER U NIT:PULL OUT:RB1 2

214.D4347760 DECAL:GUIDE PLA TE:STAPLE:OPEN AND CLOSE:RB13

218.D4347830 DECAL:H-TEMP W ARNING:MOTOR:T RAILING EDGE:PL ATE

200.D4344663 SLIDER:VIBRATIN G PLATE:MIDDLE

197.D4344656 (x2) SHAFT:VIBRATING PLATE:MIDDLE:LO WER

199.D4344662 VIBRATING PLATE: MIDDLE:LOWER

196.D4344655 (x2) SHAFT:VIBRATING PLATE:MIDDLE:UP PER

217.D4347795 DECAL:STAPLER:S 1

211.D4344861 (x2) SHAFT:GUIDE:ROL LER:TURN

212.D4344862 (x8) GUIDE:ROLLER:TU RN

207.D4344801 (x2) LINK:PRESSURE S UB-UNIT:OPEN AN D CLOSE

198.D4344660 VIBRATING PLATE: MIDDLE:UPPER:AS S'Y

201.D4344671 (x2) VIBRATING PLATE: BOTH ENDS

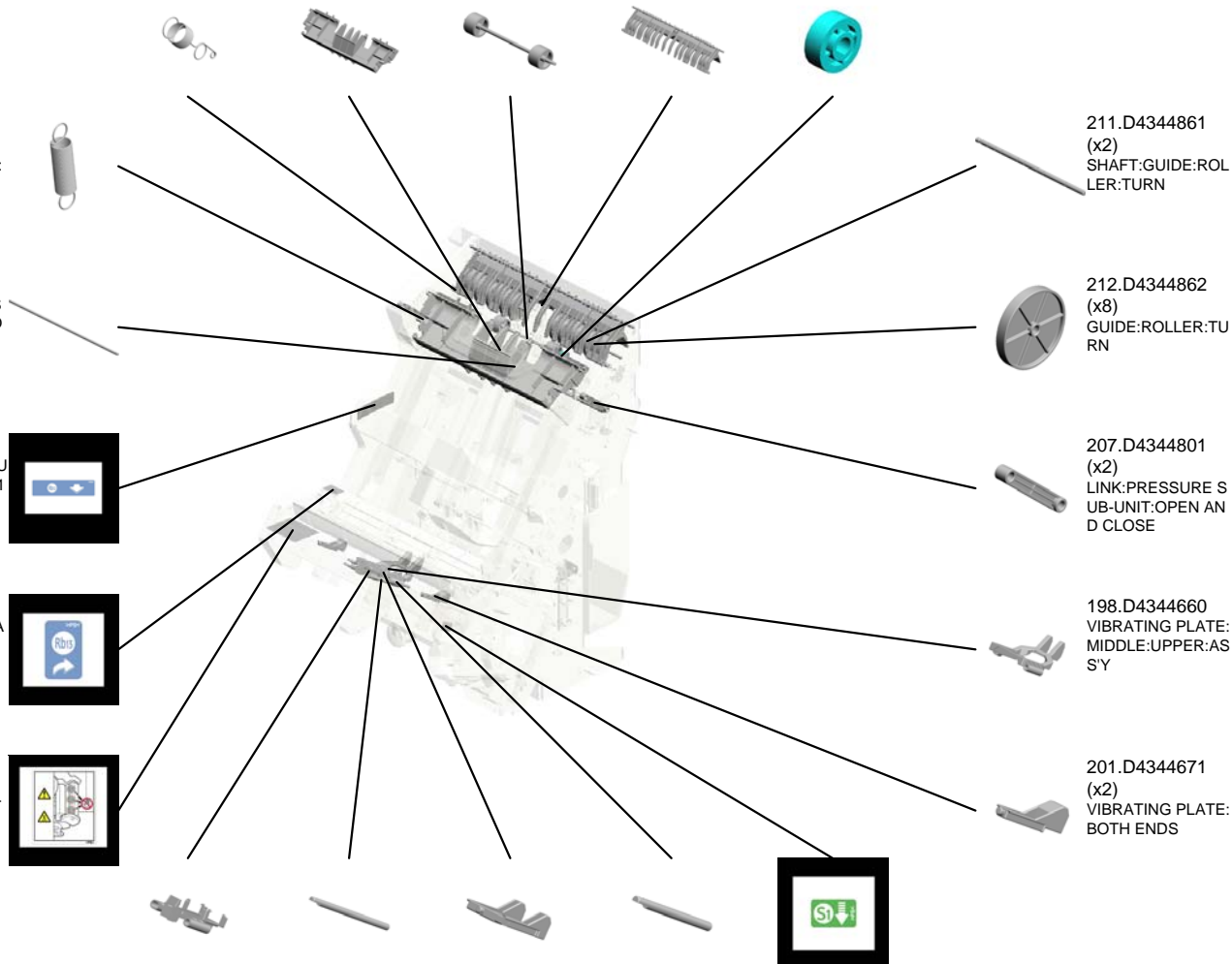

# U003 STAPLER SECTION

235.D5137805  
DECAL:COVER:ST  
APLER UNIT:TURN

228.D5134732  
(x2)  
PLAIN SHAFT BEA  
RING:PRESSURE

234.D5137800  
DECAL:COVER:ST  
APLER UNIT:VERTI  
CAL TRANSPORT

233.D5134876  
(x2)  
CAM:GUIDE:TURN:  
BIND:NO

229.D5134741  
SHAFT:DRIVE:TRA  
NSPORT ROLLER:  
PRESSURE



224.D5124372  
(x2)  
GUIDE:FILM:STAN  
DARD FENCE

225.D5124373  
FILM:GUIDE:FRON  
T

236.D5124691  
INNER COVER:SWI  
NG UNIT  
1109-02 X/O

226.D5124374  
FILM:GUIDE:REAR

227.D5134091  
COVER:SADDLE S  
TAPLER UNIT:BIND  
:NO

222.D5120112  
(x2)  
DC STEPPER MOT  
OR:JOGGER:7.92  
W:ASSY

230.D5134807  
(x2)  
CAM:PRESSURE S  
UB-UNIT:OPEN AN  
D CLOSE

232.D5134811  
TENSION SPRING:  
12N

231.D5134810  
BRACKET:STOPPE  
R:CAM:DRIVE:PRE  
SSURE

219.D4347835  
DECAL:H-TEMP W  
ARNING:MOTOR:SI  
DE PLATE:REAR

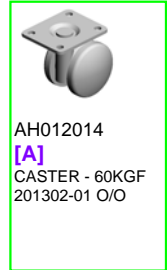

U003\_S001  
 JOGGER FENCE:FRONT:ASS'Y

173.D4344473 36.52012722  
 FILM:GUIDE:JOGG BUSHING - M6X5  
 ER:UPPER

171.D4344470  
 JOGGER FENCE:F  
 RONT:ASS'Y

16.07200040E  
 RETAINING RING -  
 M4

172.D4344472  
 GUIDE:PLATE:JOG  
 GER:UPPER

10.04543006Q  
 (x2)  
 TAPPING SCREW -  
 M3X6

73.B3024617  
 JOGGER FENCE S  
 LIDER

122.B8304613  
 COVER - FRONT J  
 OGGER FENCE

170.D4344467  
 GUIDE:SPRING PL  
 ATE:FRONT

U001	U002	U003	U004	U005	U006	U007	U008
------	------	------	------	------	------	------	------

U003\_S002  
 JOGGER FENCE:REAR:ASS'Y

173.D4344473 36.52012722  
 FILM:GUIDE:JOGG BUSHING - M6X5  
 ER:UPPER

175.D4344490  
 JOGGER FENCE:R  
 EAR:ASS'Y

16.07200040E  
 RETAINING RING -  
 M4

172.D4344472  
 GUIDE:PLATE:JOG  
 GER:UPPER

10.04543006Q  
 (x2)  
 TAPPING SCREW -  
 M3X6

73.B3024617  
 JOGGER FENCE S  
 LIDER

174.D4344487  
 GUIDE:SPRING PL  
 ATE:REAR

123.B8304623  
 COVER - REAR JO  
 GGER FENCE

U001	U002	U003	U004	U005	U006	U007	U008
------	------	------	------	------	------	------	------

U003\_S003  
BRACKET:SHAFT:EXIT:UPPER:ASS'Y

19.07403906  
BALL BEARING - 6  
X15X5



185.D4344561  
BRACKET:SHAFT:  
EXIT:UPPER:ASS'Y

U001	U002	U003	U004	U005	U006	U007	U008
------	------	------	------	------	------	------	------

U003\_S004  
GRIP:SLIDER:ASS'Y

215.D4347785  
DECAL:STAPLER U  
NIT:18RB



216.D4347790  
DECAL:KNOB:STA  
PLER UNIT:RB19

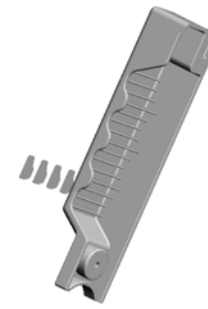
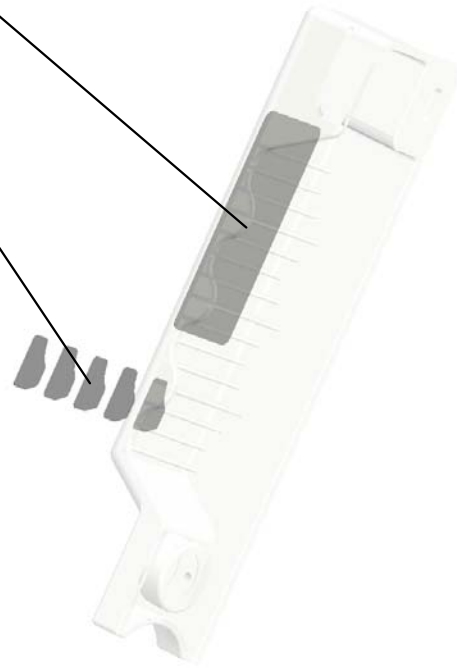

145.D4344246  
GRIP:SLIDER:ASS'  
Y

U001	U002	U003	U004	U005	U006	U007	U008
------	------	------	------	------	------	------	------

U003\_S005  
KNOB

128.B8307709  
DECAL - STAPLER  
UNIT (R10)

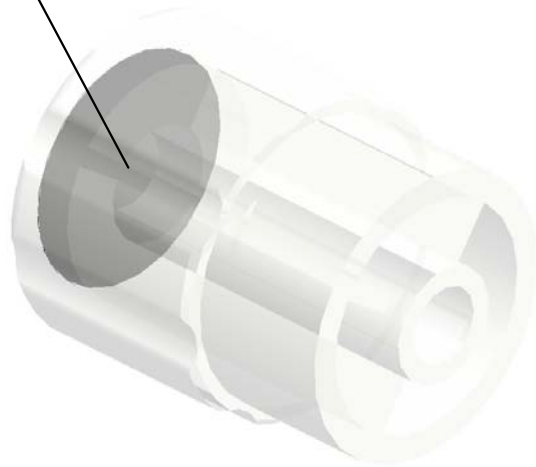

115.B8304275  
KNOB

U003\_S006  
DC STEPPER MOTOR:2.26W:ASS'Y

3.03530060N  
(x2)  
BIND SCREW - M3  
X6



221.D5120111  
DC STEPPER MOT  
OR:2.26W:ASS'Y

U001	U002	U003	U004	U005	U006	U007	U008
------	------	------	------	------	------	------	------



U003\_S007  
DC STEPPER MOTOR:2.26W:ASS'Y

3.03530060N  
(x2)  
BIND SCREW - M3  
X6



223.D5120113  
DC STEPPER MOT  
OR:2.26W:ASS'Y



U001	U002	U003	U004	U005	U006	U007	U008
------	------	------	------	------	------	------	------

U003\_S008  
DC STEPPER MOTOR:2.26W:ASS'Y

3.03530060N  
(x2)  
BIND SCREW - M3  
X6



223.D5120113  
DC STEPPER MOT  
OR:2.26W:ASS'Y



U001	U002	U003	U004	U005	U006	U007	U008
------	------	------	------	------	------	------	------

U003\_S009  
DC STEPPER MOTOR:PLATE:1.79W:ASS'Y

3.03530060N  
(x2)  
BIND SCREW - M3  
X6



220.D5120110  
DC STEPPER MOT  
OR:PLATE:1.79W:A  
SS'Y



U001	U002	U003	U004	U005	U006	U007	U008
------	------	------	------	------	------	------	------

U003\_S010  
DC STEPPER MOTOR:PLATE:1.79W:ASS'Y

3.03530060N  
(x2)  
BIND SCREW - M3  
X6



220.D5120110  
DC STEPPER MOT  
OR:PLATE:1.79W:A  
SS'Y



U001	U002	U003	U004	U005	U006	U007	U008
------	------	------	------	------	------	------	------

U003\_S011  
DC STEPPER MOTOR:PLATE:1.79W:ASS'Y

3.03530060N  
(x2)  
BIND SCREW - M3  
X6



220.D5120110  
DC STEPPER MOT  
OR:PLATE:1.79W:A  
SS'Y



U001	U002	U003	U004	U005	U006	U007	U008
------	------	------	------	------	------	------	------

# U004 UNIFORM UNIT:EXIT:SIDE

2.04513006N (x11) TAPPING SCREW - 3X6  
 10.B5131154 (x2) PULLEY:T30:S2M  
 6.A3003634 (x2) SPRING PLATE - TIMING BELT  
 15.B8303646 (x2) JOGGER FENCE HOLDER - REAR  
 11.B7031165 TIMING BELT:B40S 2M390



9.B4783569 (x4) SPACER

4.07200040E (x3) RETAINING RING - M4

20.B8303697 STEPPER MOTOR BRACKET

5.50530447 (x2) BUSHING - 6MM

1.03130040N (x4) SCREW:M3X4

16.B8303651 GEAR - 35Z

7.AW020156 (x2) PHOTOINTERRUPTOR:EE-SX4235A-P2

19.B8303692 JOGGER FENCE:EXIT:GUIDE:INNER BACK

13.B8303631 SLIDE SHAFT

8.B3523572 BUSHING - 6MM

14.B8303641 JOGGER FENCE HOLDER - FRONT

18.B8303691 JOGGER FENCE:EXIT:GUIDE:FRONT

12.B8303611 FRAME - JOGGER UNIFORM

17.B8303688 (x2) CUSHION:JOGGER FENCE

3.04513008N TAPPING SCREW - M3X8

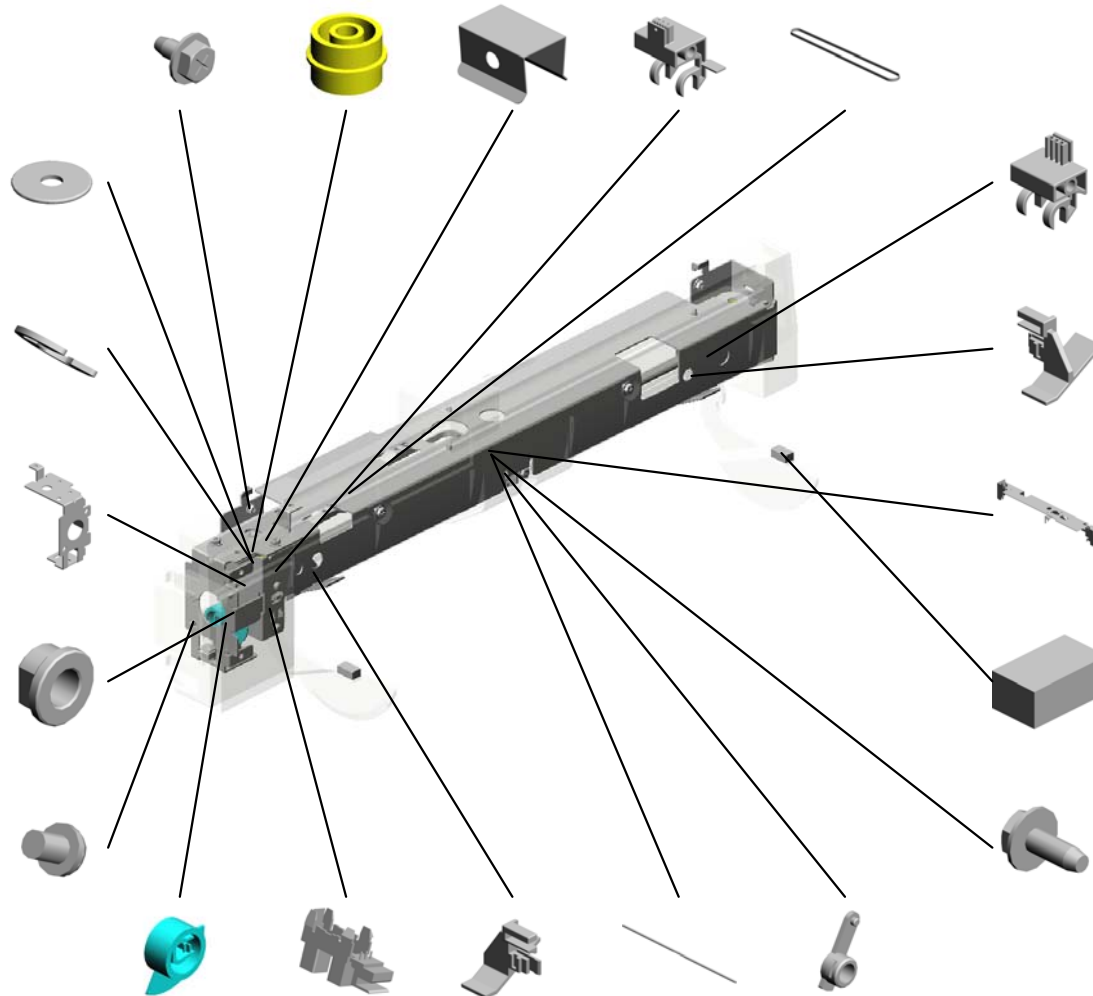

U004  
UNIFORM UNIT:EXIT:SIDE

28.D5123676 (x2) LEVER:DRIVE:JOGGER FENCE  
 25.B8305569 STEPPER MOTOR DC3.3V 3.9W  
 31.D5123731 COVER:UNIFORM UNIT:PAPER EXIT SUB-UNIT  
 22.B8303726 TIMING BELT - 40S 2M848



26.B8305570 STEPPER MOTOR DC3.1V 7.4W



24.B8305120 PCB JOGGER

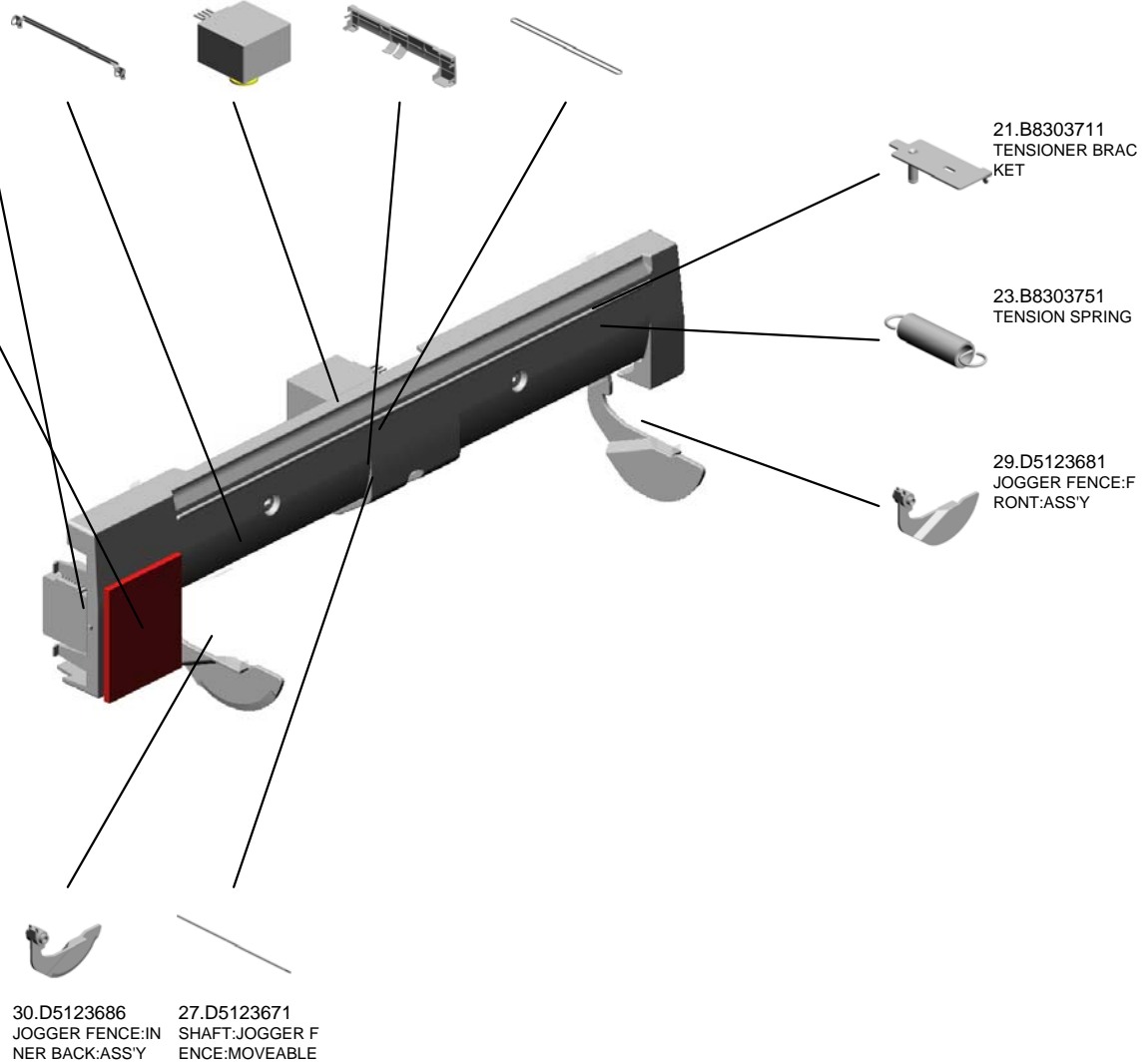
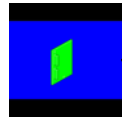

U001	U002	U003	U004	U005	U006	U007	U008
------	------	------	------	------	------	------	------

# U005.SHIFT TRAY SECTION

U005\_S001  
D4343310  
BASE:SHIFT TRAY:ASS'Y

U005\_S002  
D4343320  
SIDE PLATE:SHIFT TRAY:FR  
ONT:ASS'Y

U005\_S003  
D4343330  
SIDE PLATE:SHIFT TRAY:RE  
AR:ASS'Y

U005\_S004  
D5120111  
DC STEPPER MOTOR:2.26W  
:ASS'Y

U001	U002	U003	U004	U005	U006	U007	U008
------	------	------	------	------	------	------	------



# U005 SHIFT TRAY SECTION



- 17.08075056 (x2) WASHER - 8.1MM
- 12.07200060E (x6) RETAINING RING - M6
- 20.11050488 (x3) HARNESS CLAMP
- 14.07413506 (x2) BALL BEARING - 6 X12X4 MM
- 8.05740040E HEXAGON HEADL ESS SET SCREW - M4X4

9.06340200G  
PARALLEL PIN - 4X  
20



7.04544008Q  
(x2)  
TAPPING SCREW -  
M4X8



2.03530060N  
(x4)  
BIND SCREW - M3  
X6



5.04514006N  
(x6)  
TAPPING SCREW -  
4X6



15.07413706  
(x2)  
BALL BEARING - 6  
X10X3



4.04513008N  
(x6)  
TAPPING SCREW -  
M3X8



16.08050089  
(x6)  
RETAINING RING -  
M4



1.03530040N  
(x4)  
SCREW - M3X4



6.04543006Q  
(x16)  
TAPPING SCREW -  
M3X6



19.11050487  
(x2)  
HARNESS CLAMP



11.07200040E  
(x5)  
RETAINING RING -  
M4



10.07200030E  
(x2)  
RETAINING RING -  
M3



13.07403906  
(x8)  
BALL BEARING - 6  
X15X5



18.11050328  
(x2)  
HARNESS CLAMP -  
ES-0505



3.04513006N  
(x19)  
TAPPING SCREW -  
3X6



# U005 SHIFT TRAY SECTION

32.A6973170 GEAR - 42Z    28.A6973135 GEAR - 18Z    29.A6973140 GEAR - 30Z    30.A6973145 GEAR - 36Z/18Z    25.A3002736 WORM GEAR

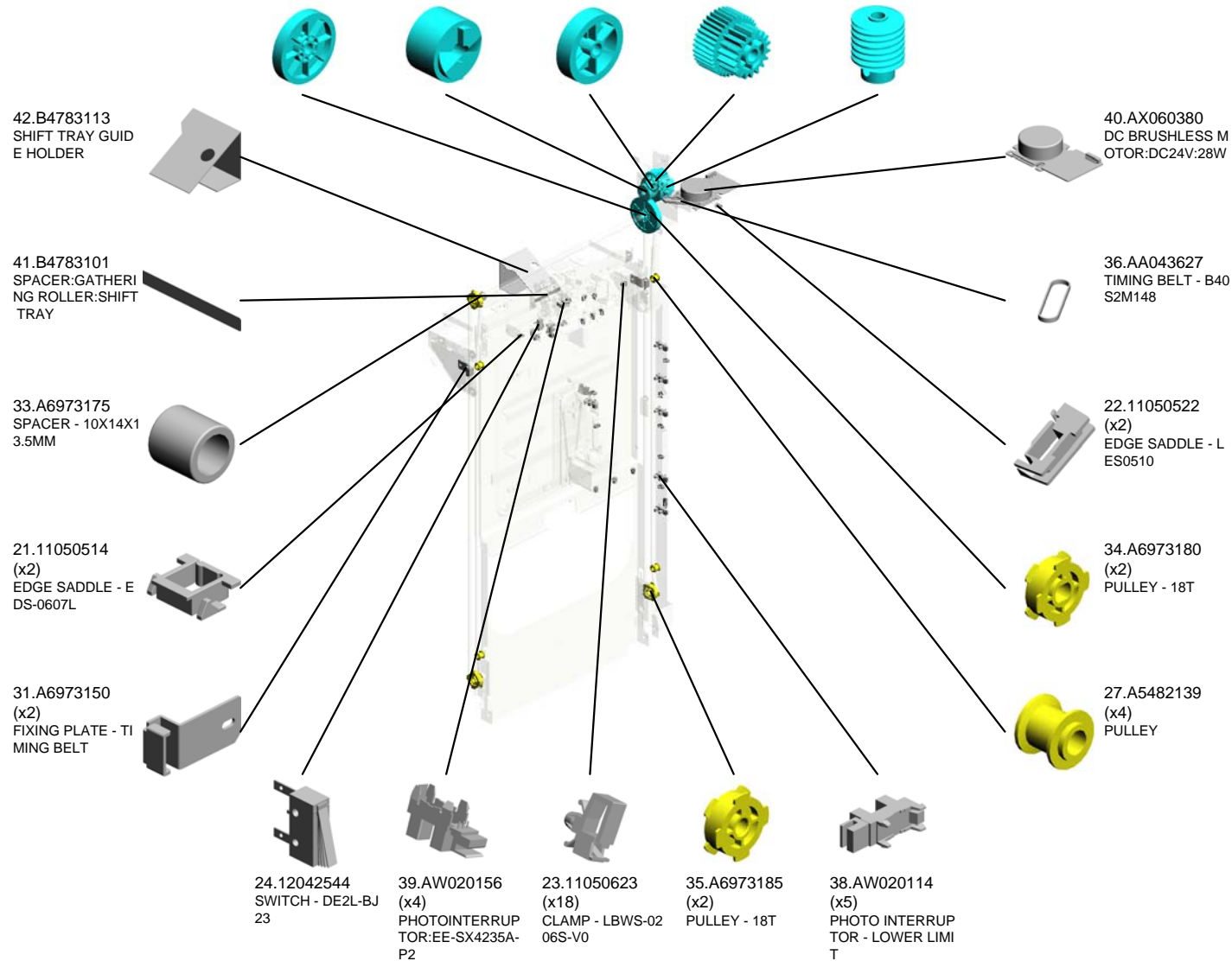

# U005 SHIFT TRAY SECTION

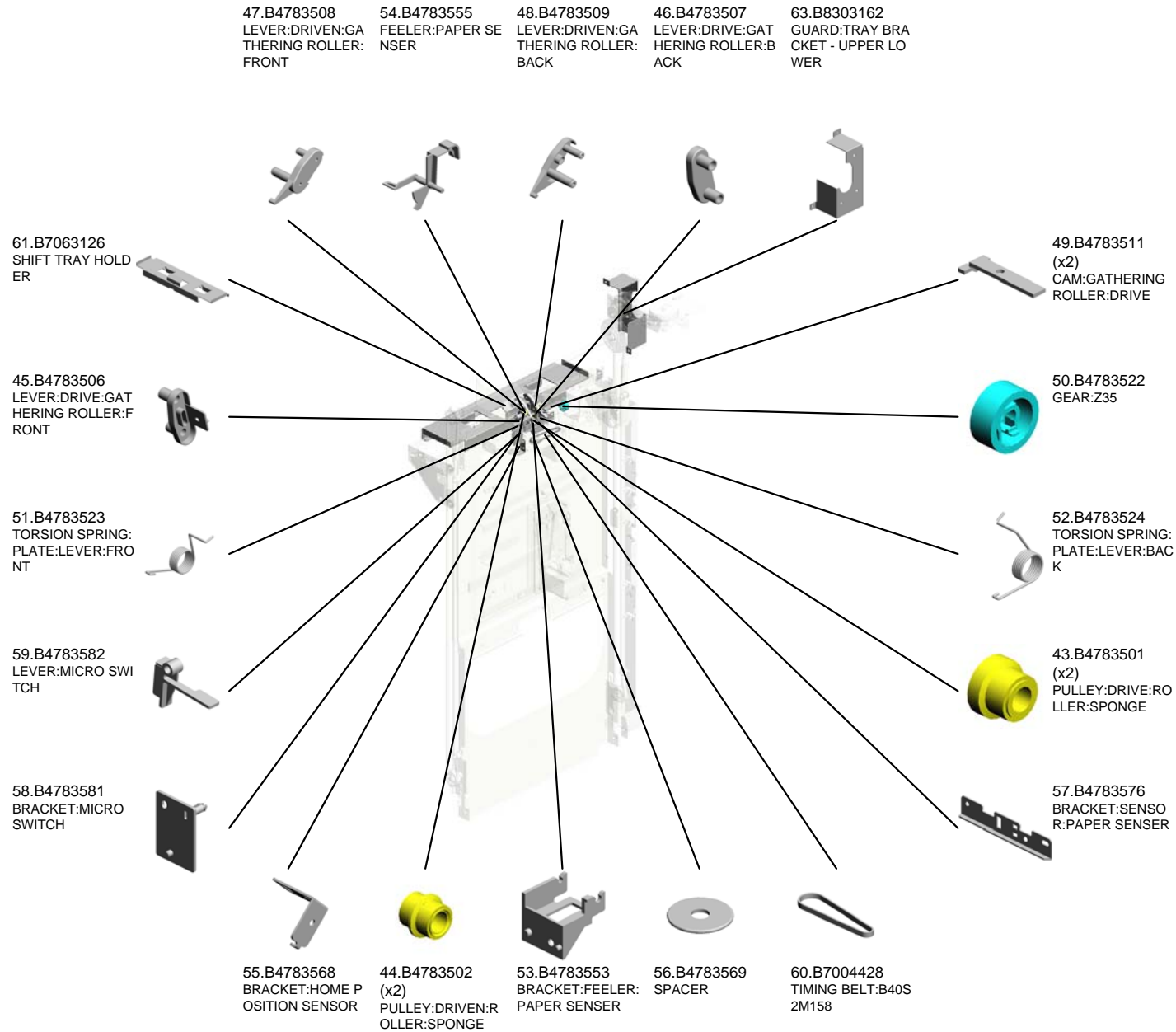

# U005 SHIFT TRAY SECTION

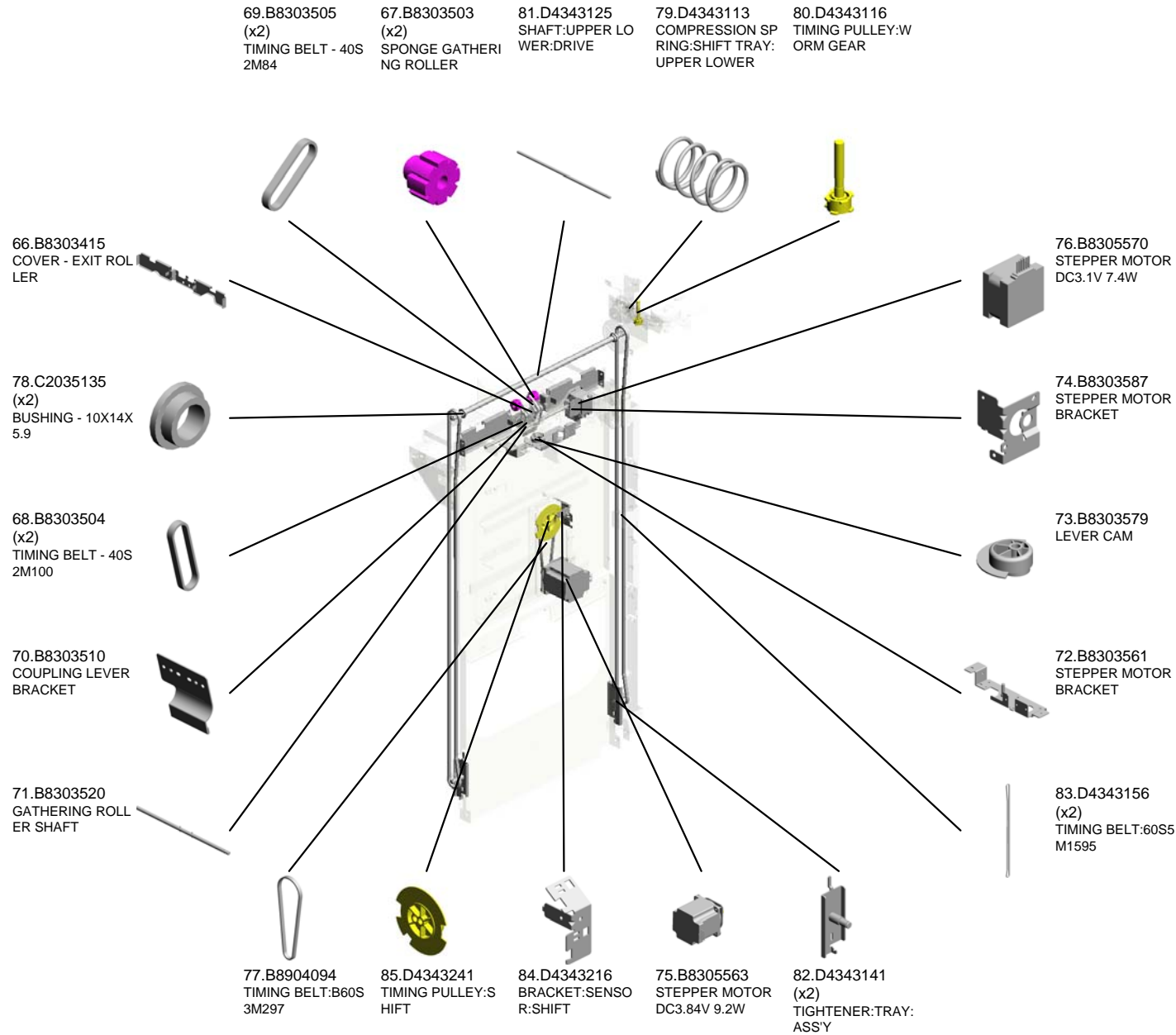

# U005 SHIFT TRAY SECTION

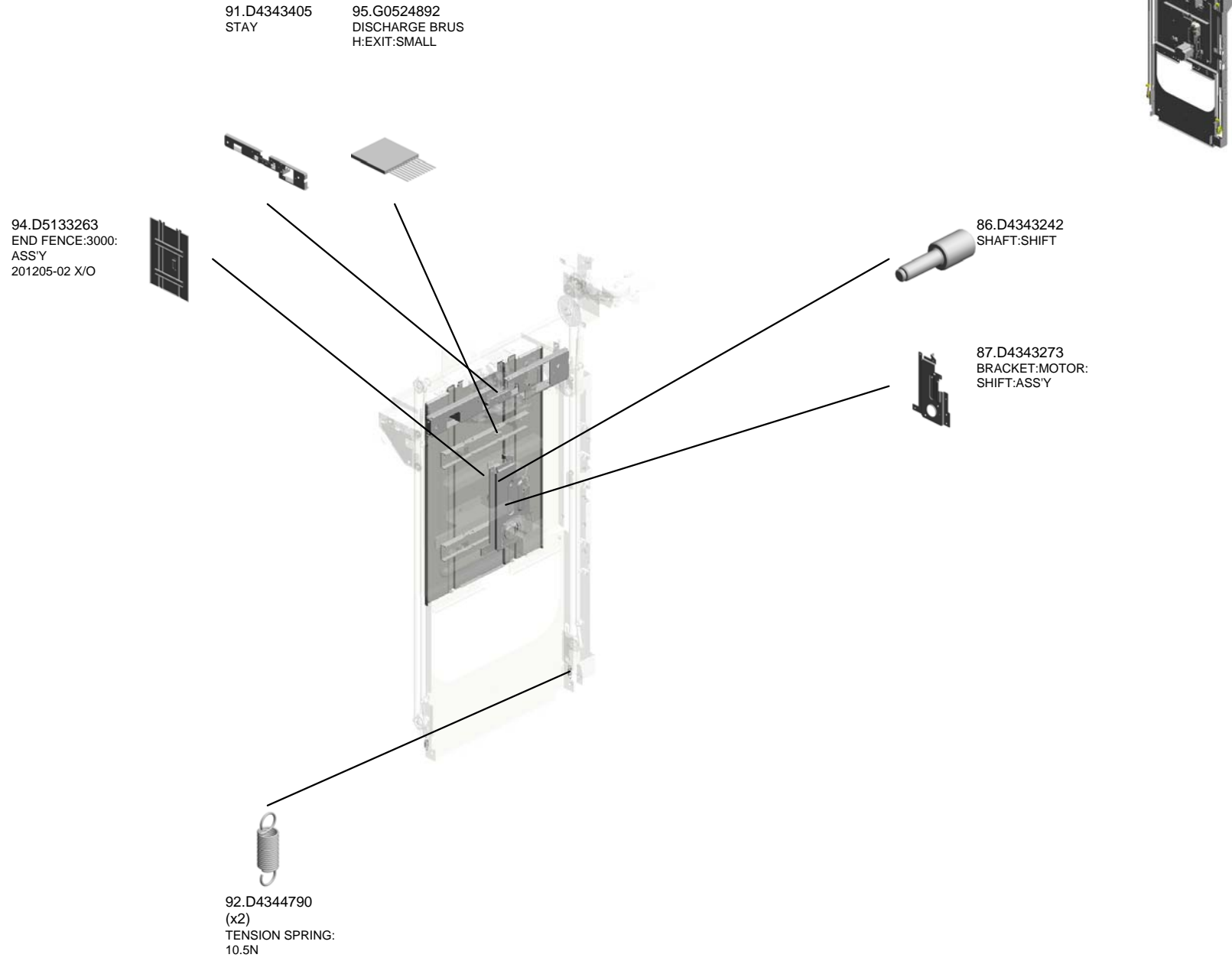

U001	U002	U003	U004	<b>U005</b>	U006	U007	U008
------	------	------	------	-------------	------	------	------

U005\_S001  
BASE:SHIFT TRAY:ASS'Y

62.B7063271 37.AA132024  
(x2) (x4)  
TRAY SHIFT SHAF SPACER - M6  
T

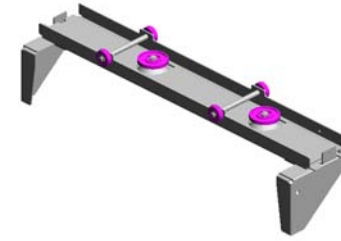

88.D4343310  
BASE:SHIFT TRAY:  
ASS'Y

64.B8303315  
(x2)  
ROLLER

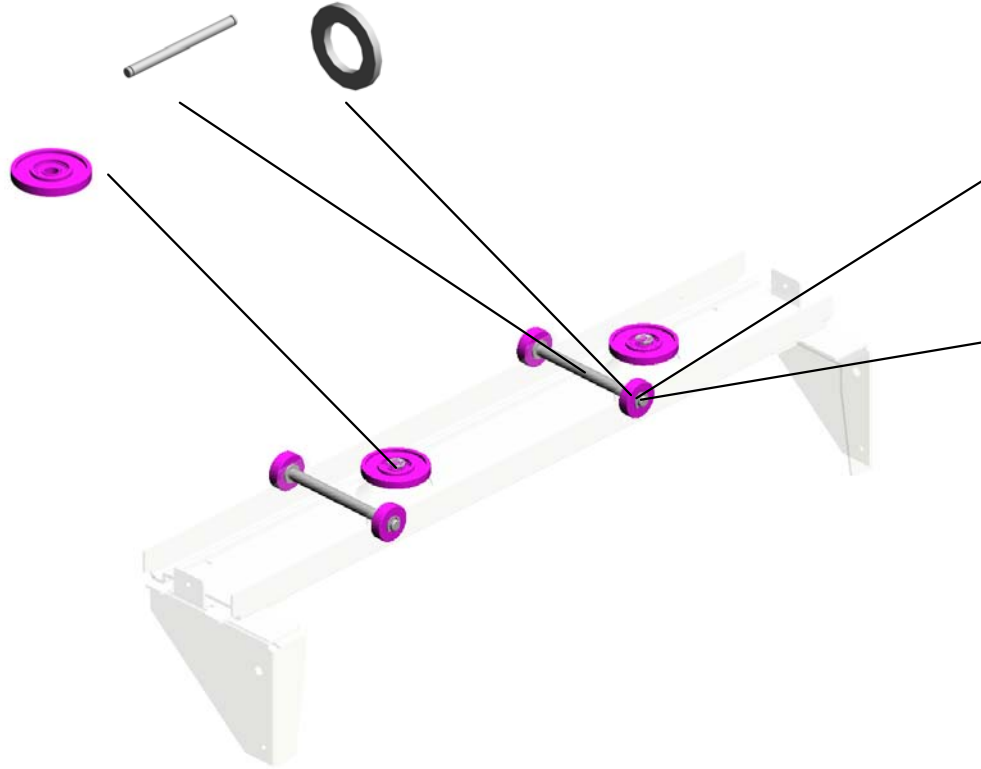

26.A3533272  
(x4)  
GUIDE ROLLER

11.07200040E  
(x6)  
RETAINING RING -  
M4

U001	U002	U003	U004	U005	U006	U007	U008
------	------	------	------	------	------	------	------

U005\_S002

SIDE PLATE:SHIFT TRAY:FRONT:ASS'Y

65.B8303322  
(x2)  
GUIDE:SHIFT TRA  
Y:UPPER LOWER

13.07403906  
(x2)  
BALL BEARING - 6  
X15X5

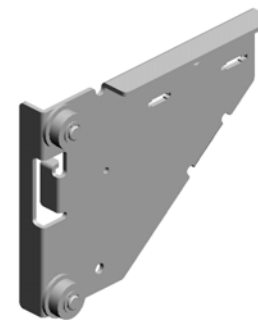

89.D4343320  
SIDE PLATE:SHIFT  
TRAY:FRONT:ASS'  
Y

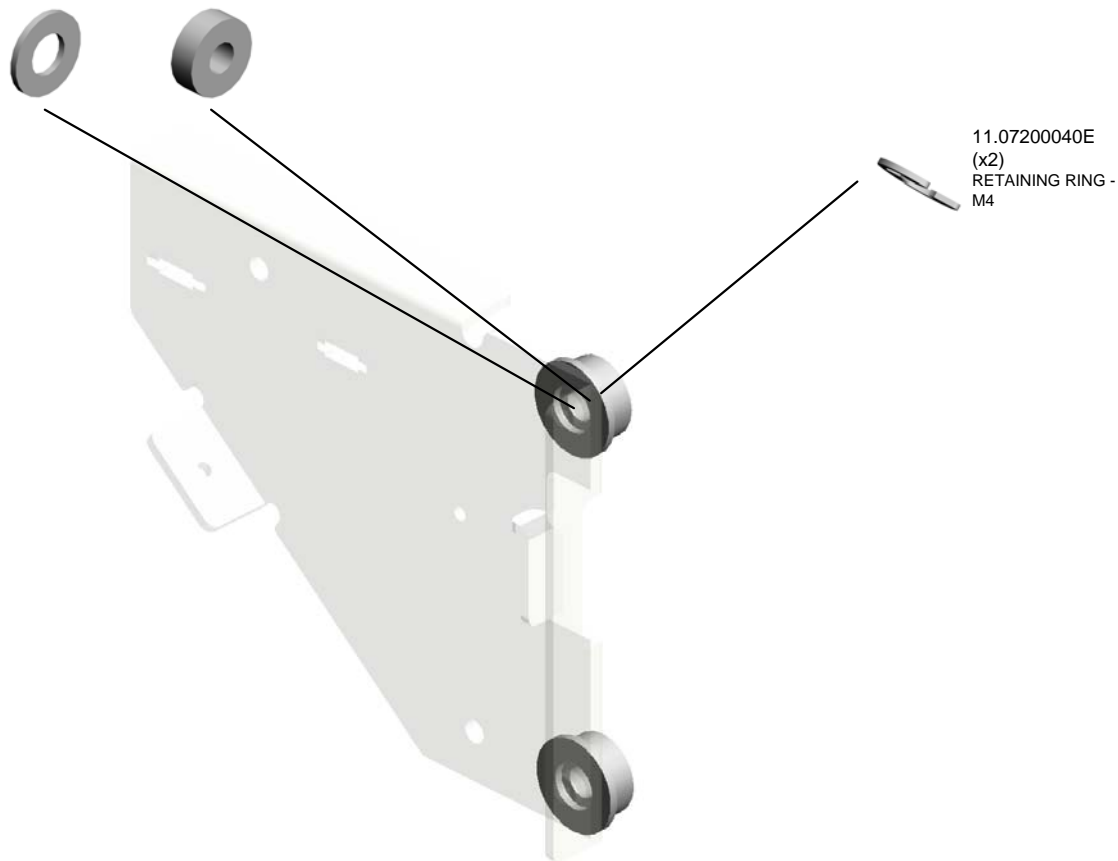

11.07200040E  
(x2)  
RETAINING RING -  
M4

U001	U002	U003	U004	U005	U006	U007	U008
------	------	------	------	------	------	------	------

U005\_S003  
SIDE PLATE:SHIFT TRAY:REAR:ASS'Y

11.07200040E 13.07403906  
(x2) (x2)  
RETAINING RING - BALL BEARING - 6  
M4 X15X5

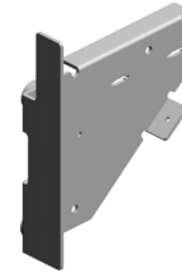

90.D4343330  
SIDE PLATE:SHIFT  
TRAY:REAR:ASS'Y



65.B8303322  
(x2)  
GUIDE:SHIFT TRA  
Y:UPPER LOWER

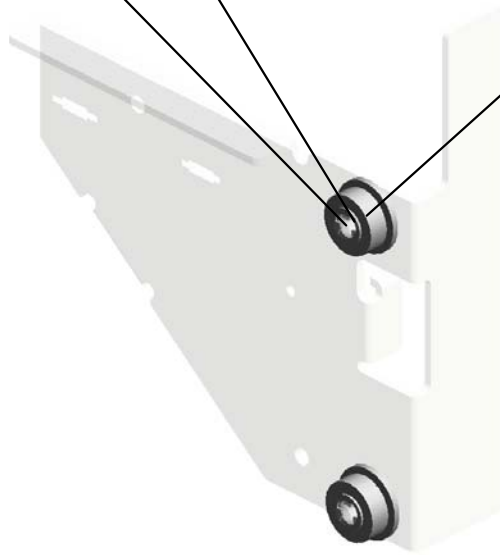



U005\_S004  
DC STEPPER MOTOR:2.26W:ASS'Y

2.03530060N  
(x2)  
BIND SCREW - M3  
X6

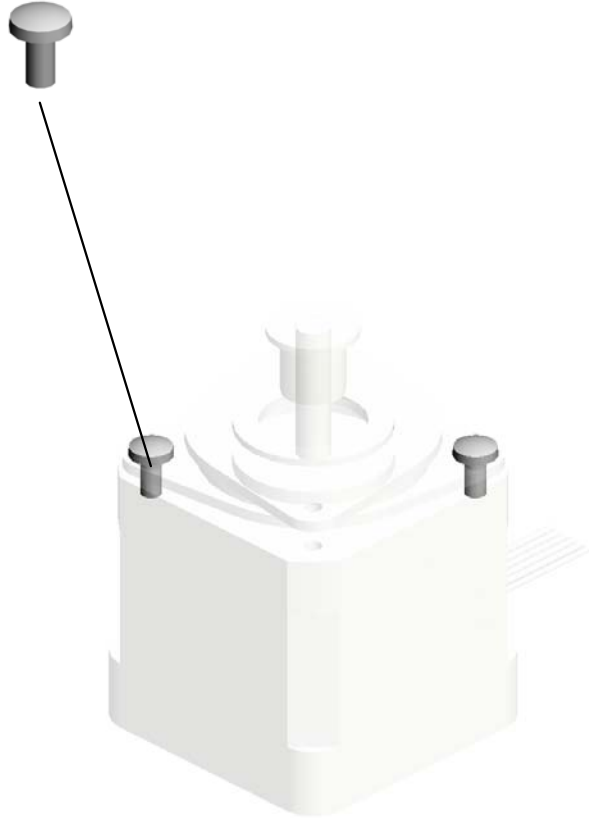

93.D5120111  
DC STEPPER MOT  
OR:2.26W:ASS'Y

U001	U002	U003	U004	U005	U006	U007	U008
------	------	------	------	------	------	------	------

# U006 MECHANICAL DRIVE SECTION

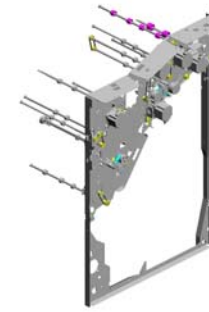

- 8.11050488 HARNESS CLAMP
- 10.A4583281 IDLER ROLLER
- 7.07200060E RETAINING RING - M6
- 15.AW020156 (x3) PHOTOINTERRUPTOR:EE-SX4235A-P2
- 4.04533006N (x4) TAPPING SCREW - M3X6

11.A6972260  
PULLEY - 17T



12.AA080072  
(x2)  
BUSHING - 6X10X3



9.11050623  
(x6)  
CLAMP - LBWS-02  
06S-V0



18.B7001645  
(x4)  
TIMING PULLEY:20  
T



14.AB030722  
PULLEY - 13MM



13.AA082101  
(x2)  
BUSHING - 6X10X6



19.B7003115  
WORM GEAR:37T



20.B7003535  
TIMING BELT:B40S  
2M116



17.B4783568  
BRACKET:HOME P  
OSITION SENSOR



2.04513006N  
TAPPING SCREW -  
3X6



5.04543006Q  
(x21)  
TAPPING SCREW -  
M3X6



16.B3521607  
(x9)  
TIMING PULLEY - T  
20-S3M



6.07200040E  
(x6)  
RETAINING RING -  
M4



3.04514006N  
(x14)  
TAPPING SCREW -  
4X6



1.03530040N  
(x2)  
SCREW - M3X4



# U006 MECHANICAL DRIVE SECTION

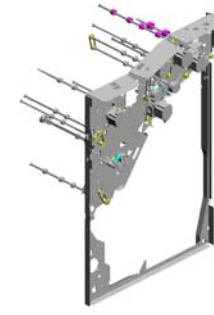

- 23.B7061555 BRACKET:TIGHTENER
- 24.B8301135 SCREW
- 31.B8302522 (x2) SENSOR BRACKET
- 30.B8302519 (x2) GEAR - 91Z
- 32.B8304884 TIMING BELT - 60S 3M204

25.B8301531  
STEPPER MOTOR  
BRACKET



28.B8301534  
TIMING BELT - 60S  
3M216



26.B8301532  
TIMING PULLEY - 2  
6T/17T



34.B8891432  
TIMING BELT:B60S  
3M771



29.B8302142  
TIMING BELT - 60S  
3M162



37.D4341956  
CAM:ECCENTRIC:  
FRONT



39.D4341958  
SHAFT:PRESSURE  
RELEASE



38.D4341957  
CAM:ECCENTRIC:  
REAR



35.D4341911  
TIMING BELT:60S3  
M402



36.D4341952  
BRACKET:WORM  
GEAR:PRESSURE  
RELEASE:ASSY



21.B7005804  
(x2)  
STEPPER MOTOR:  
DIA42:Z17:ASSY



27.B8301533  
(x5)  
TIMING BELT - 60S  
3M171



40.D4344736  
TIMING BELT:60S3  
M192



33.B8305562  
(x7)  
STEPPER MOTOR  
DC1.56V 3.7W



22.B7005811  
STEPPER MOTOR:  
DC 25W



# U006 MECHANICAL DRIVE SECTION

41.D4344790  
(x2)  
TENSION SPRING:  
10.5N

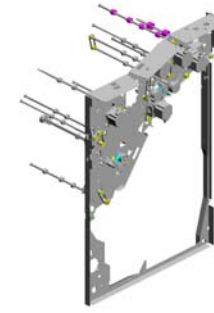
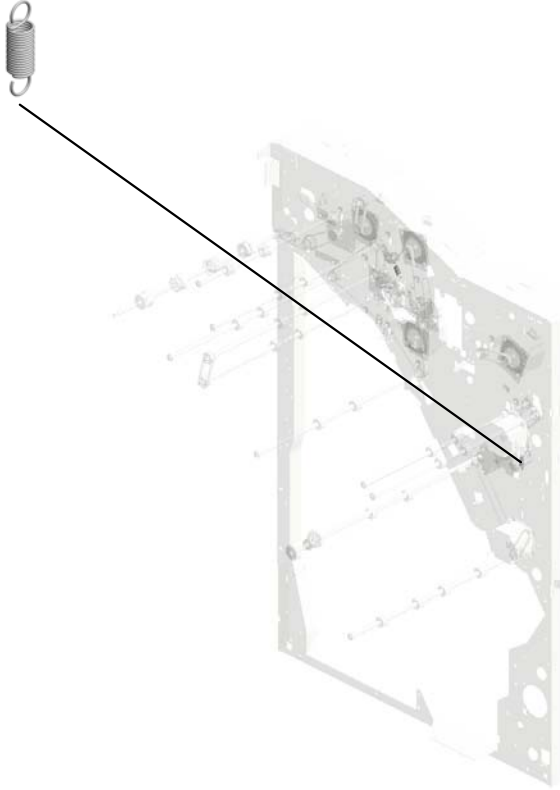

U001	U002	U003	U004	U005	<b>U006</b>	U007	U008
------	------	------	------	------	-------------	------	------

# U007 ELECTRICAL COMPONENTS

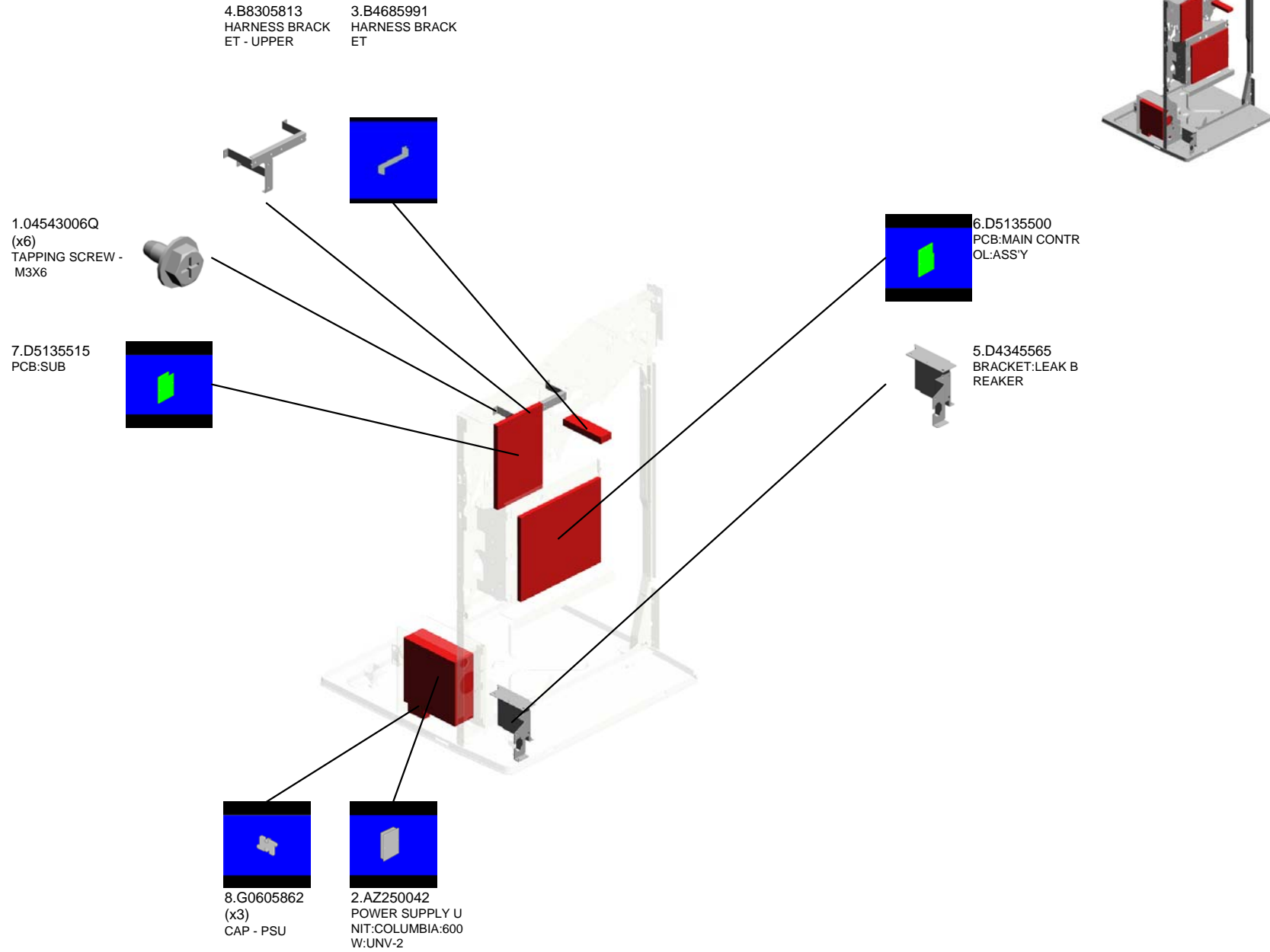

U001	U002	U003	U004	U005	U006	U007	U008
------	------	------	------	------	------	------	------

# U008.FRAME SECTION

U008\_S001  
B8307010  
TONER HOPPER

U008\_S002  
D5120114  
DC STEPPER MOTOR:DRIVE  
:2.26W

U008\_S003  
D4341450  
BRACKET:GROUND PLATE:A  
SS'Y

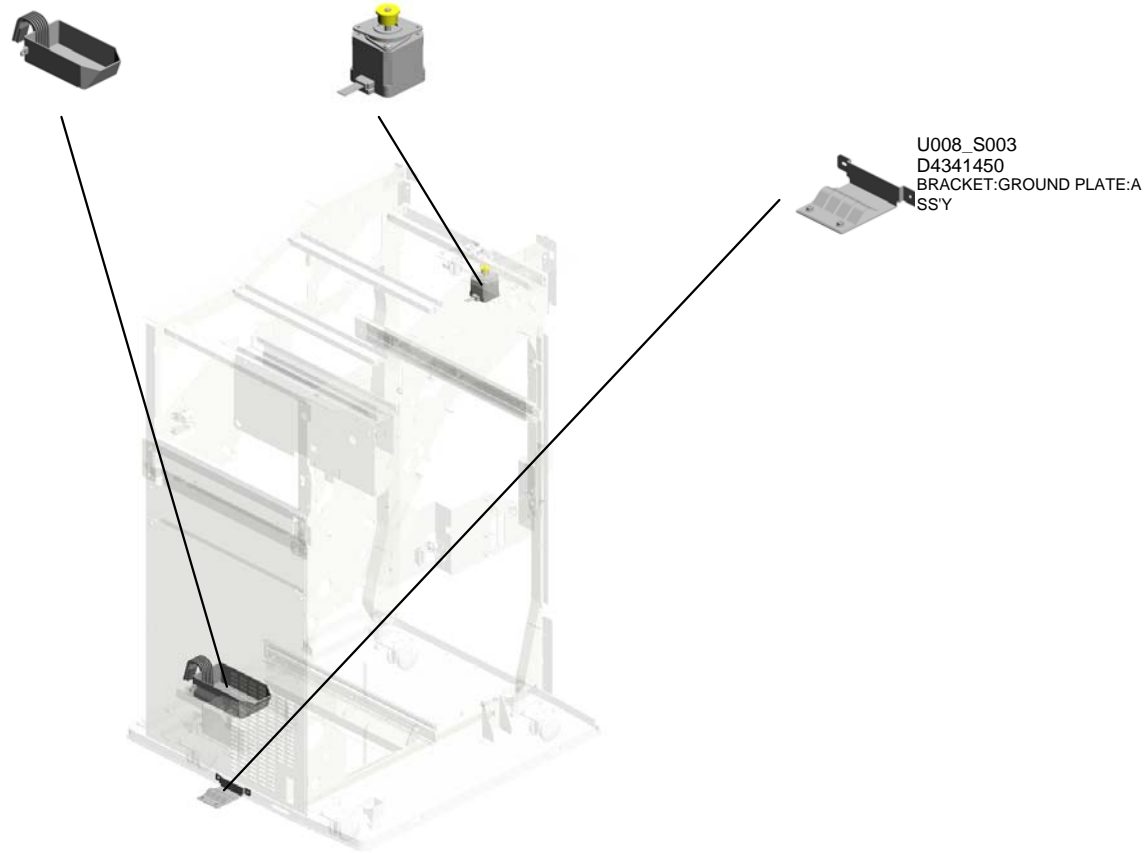

U001	U002	U003	U004	U005	U006	U007	U008
------	------	------	------	------	------	------	------

# U008 FRAME SECTION

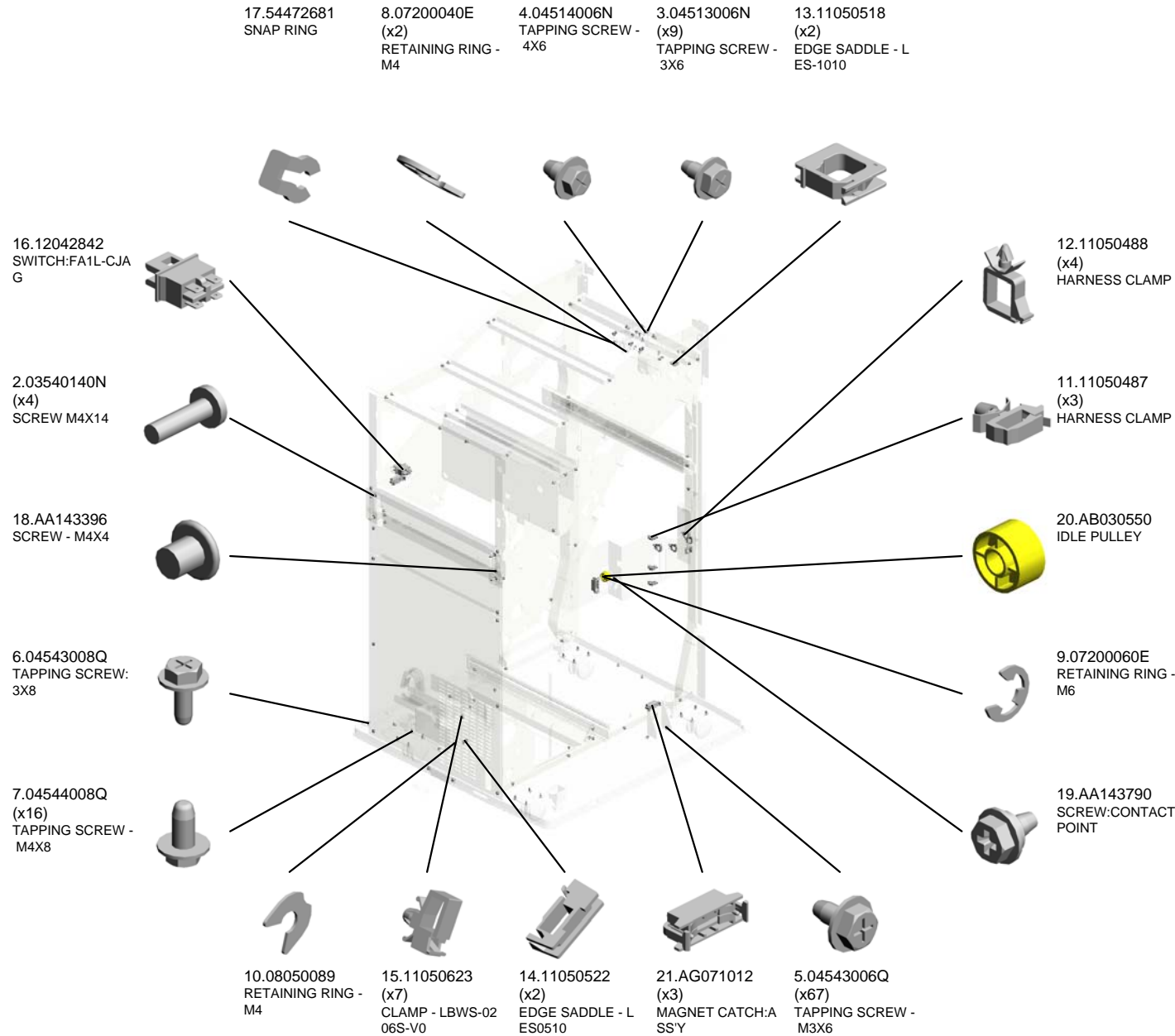
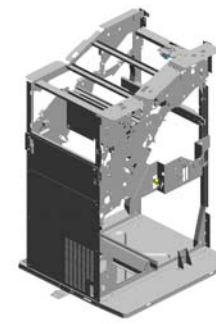

# U008 FRAME SECTION

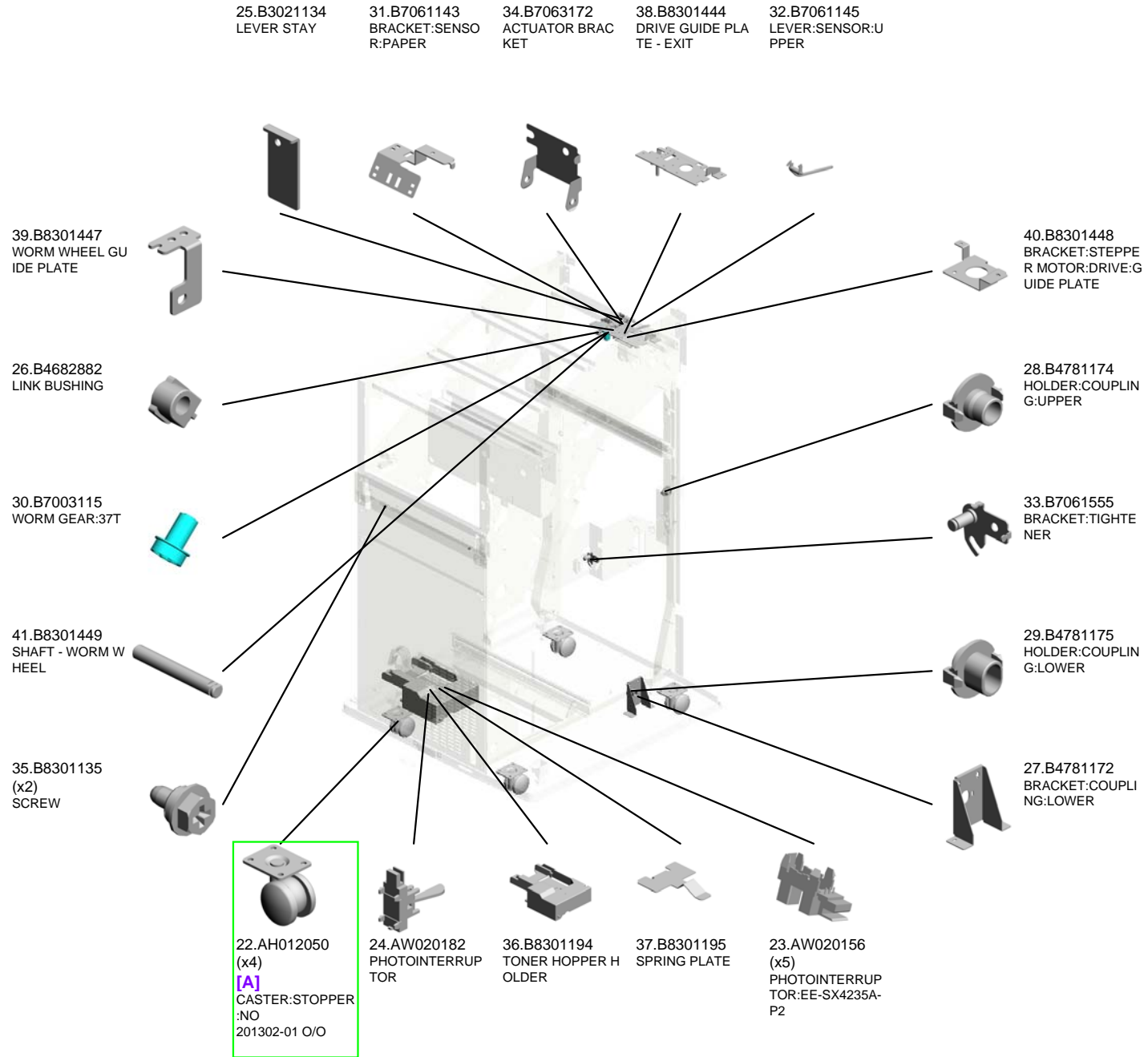
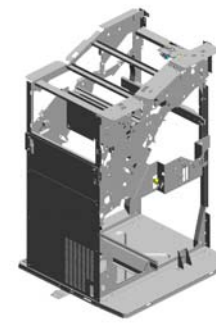

U001	U002	U003	U004	U005	U006	U007	U008
------	------	------	------	------	------	------	------



# U008 FRAME SECTION

- 45.B8301458 LINK - EXIT ROLLER DRIVEN
- 46.B8301459 COMPRESSION SPRING
- 42.B8301451 WORM WHEEL - 16Z
- 43.B8301455 BRACKET - HOME POSITION SENSOR
- 44.B8301456 TIMING BELT - 40S2M190

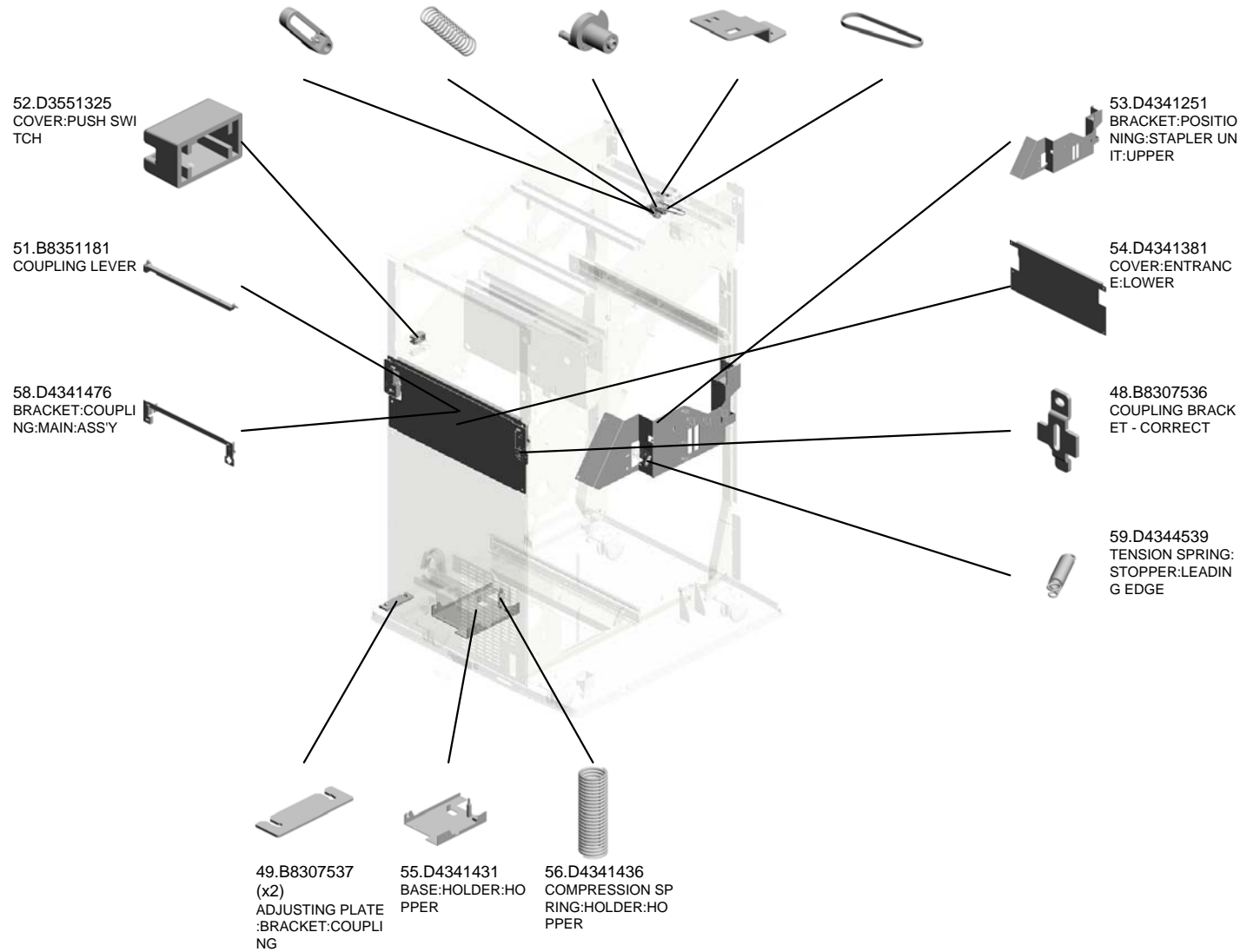
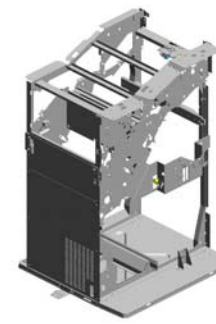

U008\_S001  
TONER HOPPER

50.B8307712  
DECAL - TONER H  
OPPER STAPLE

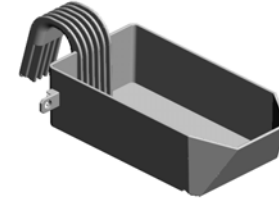
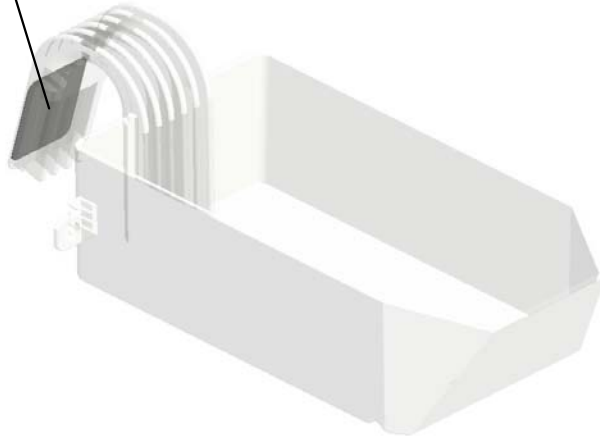

47.B8307010  
TONER HOPPER

U001	U002	U003	U004	U005	U006	U007	U008
------	------	------	------	------	------	------	------

U008\_S002  
DC STEPPER MOTOR:DRIVE:2.26W

1.03530060N  
(x2)  
BIND SCREW - M3  
X6



60.D5120114  
DC STEPPER MOT  
OR:DRIVE:2.26W

U001	U002	U003	U004	U005	U006	U007	U008
------	------	------	------	------	------	------	------

U008\_S003  
BRACKET:GROUND PLATE:ASS'Y

3.04513006N  
(x2)  
TAPPING SCREW -  
3X6

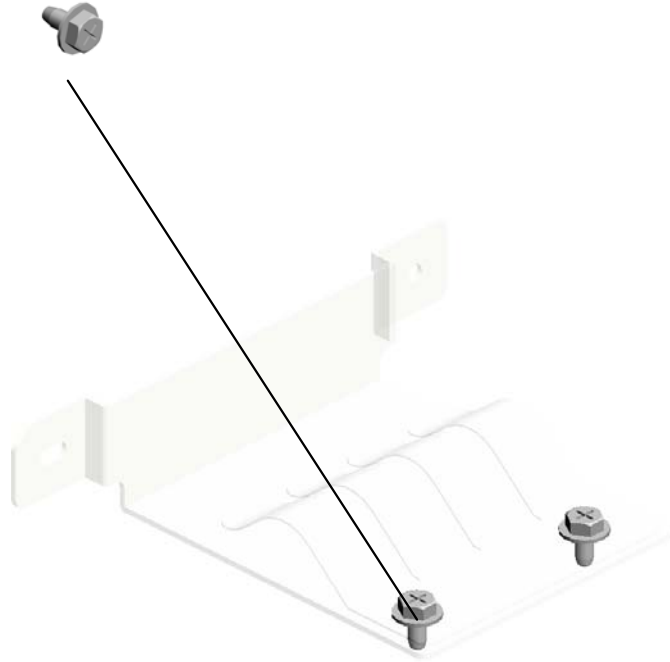
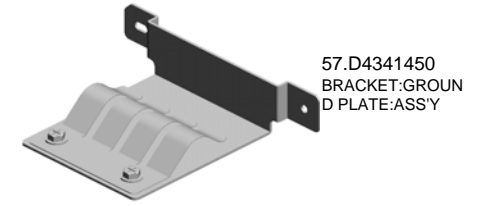

U001	U002	U003	U004	U005	U006	U007	U008
------	------	------	------	------	------	------	------

# ACCESSORIES



1.11500377  
POWER SUPPLY CODE:250V:10A:EU



2.B1321226  
(x4)  
HOLDER:STAND

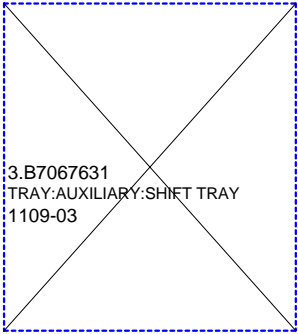

3.B7067631  
TRAY:AUXILIARY:SHIFT TRAY  
1109-03

## Exclusive Parts

Number	Part Name	Group	ID
50530447	BUSHING - 6MM	U004	5
52012722	BUSHING - M6X5	U003	36
		U003_S001	36
		U003_S002	36
52062686	SNAP RING	U003	37
52152621	SNAP RING - M6	U003	38
54472681	SNAP RING	U001_S001	10
		U003	39
		U008	17
59192127	POSITIONING ROLLER PULLEY	U003	40
59192132	POSITIONING ROLLER BELT	U003	41
A2596590	BUSHING	U002	20
A3002736	WORM GEAR	U005	25
A3003634	SPRING PLATE - TIMING BELT	U003	42
		U004	6
A3533272	GUIDE ROLLER	U005_S001	26
A3533354	DRIVEN ROLLER HOLDER	U002	21
A3761343	ORIGINAL PRESSURE ROLLER	U003	43
A3774741	ROLLER - M14	U003	44
A3792215	EXIT MYLAR	U002	22
A4221063	SEAL - 0.7X13X20	U002	23
A4582251	CUSHION - BIN SOLENOID LEVER	U002_S006	24
A4583281	IDLER ROLLER	U006	10
A5482139	PULLEY	U005	27
A6663180	TIMING PULLEY - Z32	U003	45
A6812742	DRIVEN EXIT ROLLER	U003	46
A6972102	DAMPER - JUNCTION GATE SOLENOID	U003	47
A6972132	JOINT - BRUSH ROLLER	U003	48
A6972138	BRUSH ROLLER	U003	49
A6972260	PULLEY - 17T	U003	50
		U006	11
A6973135	GEAR - 18Z	U005	28
A6973140	GEAR - 30Z	U005	29
A6973145	GEAR - 36Z/18Z	U005	30
A6973150	FIXING PLATE - TIMING BELT	U005	31
A6973170	GEAR - 42Z	U005	32
A6973175	SPACER - 10X14X13.5MM	U005	33

Number	Part Name	Group	ID
A6973180	PULLEY - 18T	U005	34
A6973185	PULLEY - 18T	U005	35
A8592230	BALL BEARING - 6X13X5	U003	51
A8594141	PULLEY IDLER	U003	52
AA043593	TIMING BELT - 40S3M324	U003	53
AA043627	TIMING BELT - B40S2M148	U005	36
AA043962	TIMING BELT - B40S2M214	U003	54
AA062334	TENSION SPRING:4.9N	U003	55
AA063529	PRESSURE SPRING - 14.5MM	U002	25
AA080072	BUSHING - 6X10X3	U006	12
AA080237	BUSHING - 4X5X7	U002	26
AA082101	BUSHING - 6X10X6	U002	27
		U003	56
		U006	13
AA120097	ANTISTATIC BRUSH	U002	28
		U003	57
AA132024	SPACER - M6	U005_S001	37
AA143396	SCREW - M4X4	U008	18
AA143790	SCREW:CONTACT POINT	U003	58
		U008	19
AB030278	IDLER - 20Z	U003	59
AB030550	IDLE PULLEY	U008	20
AB030609	PULLEY - 20T	U003	60
AB030722	PULLEY - 13MM	U006	14
AF022147	DRIVEN ROLLER	U002	29
		U002_S002	29
		U002_S011	29
AF022148	ROLLER:DRIVEN:L=125	U002	30
		U002_S007	30
		U002_S008	30
		U003	61
AG070513	MAGNET CATCH	U002	31
AG070514	MAGNET CATCH	U002	32
		U002_S002	32
		U002_S007	32
		U002_S008	32
		U002_S011	32
		U003	62

## Exclusive Parts

Number	Part Name	Group	ID
AG071012	MAGNET CATCH:ASS'Y	U008	21
<b>AH012050</b>	<b>CASTER:STOPPER:NO</b>	<b>U003</b>	<b>63</b>
		<b>U008</b>	<b>22</b>
AJ011023	STAPLER:EH-1200R	U003	64
AW010089	PHOTOSENSOR - GP2A28C	U002	33
AW010091	PHOTO REFLECTION SENSOR	U002	34
AW010109	PHOTO REFLECTION SENSOR:PS1 17ED1	U003	65
AW010124	PHOTO REFLECTION SENSOR:GP 2A200LCS0F	U003	66
AW020114	PHOTO INTERRUPTOR - LOWER L IMIT	U005	38
AW020156	PHOTOINTERRUPTOR:EE-SX4235 A-P2	U003	67
		U004	7
		U005	39
		U006	15
		U008	23
AW020182	PHOTOINTERRUPTOR	U003	68
		U008	24
AX060380	DC BRUSHLESS MOTOR:DC24V:2 8W	U005	40
AZ250042	POWER SUPPLY UNIT:COLUMBIA: 600W:UNV-2	U007	2
B1321226	HOLDER:STAND	ACCESSORIES	2
B2341293	LEVER - SAFETY SWITCH	U001	11
B3021134	LEVER STAY	U008	25
B3022216	EXIT GUIDE - UPPER EXIT GUIDE	U002	22
B3022305	MIDDLE EXIT ROLLER	U002	35
B3022413	BRUSH ROLLER	U003	69
B3022513	SUPPORT PLATE - EXIT GATE	U002	36
B3024113	BUSHING - 6X9MM	U003	70
B3024292	BELT HOLDER	U003	71
B3024517	MYLAR GUIDE	U003	72
B3024617	JOGGER FENCE SLIDER	U003_S001	73
		U003_S002	73
B3024731	LOWER EXIT SHAFT	U003	74
B3024756	TIMING BELT - 753P3M6	U003	75
B3521607	TIMING PULLEY - T20-S3M	U003	76

Number	Part Name	Group	ID
		U006	16
B3523572	BUSHING - 6MM	U004	8
B4082281	KNOB - TRANSFER ROLLER	U002	37
B4682882	LINK BUSHING	U008	26
B4684766	TIGHTENER	U003	77
B4685991	HARNESS BRACKET	U007	3
B4781172	BRACKET:COUPLING:LOWER	U008	27
B4781174	HOLDER:COUPLING:UPPER	U008	28
B4781175	HOLDER:COUPLING:LOWER	U008	29
B4782116	REVERSE ROLLER - STAPLER TR AY	U003	78
B4782231	ROLLER:EXIT:AUXILIARY:ASS'Y	U002	38
B4782332	SPRING PLATE:SHIFT:EXIT	U002	39
B4783101	SPACER:GATHERING ROLLER:SHI FT TRAY	U005	41
B4783113	SHIFT TRAY GUIDE HOLDER	U005	42
B4783501	PULLEY:DRIVE:ROLLER:SPONGE	U005	43
B4783502	PULLEY:DRIVEN:ROLLER:SPONG E	U005	44
B4783506	LEVER:DRIVE:GATHERING ROLLE R:FRONT	U005	45
B4783507	LEVER:DRIVE:GATHERING ROLLE R:BACK	U005	46
B4783508	LEVER:DRIVEN:GATHERING ROLL ER:FRONT	U005	47
B4783509	LEVER:DRIVEN:GATHERING ROLL ER:BACK	U005	48
B4783511	CAM:GATHERING ROLLER:DRIVE	U005	49
B4783522	GEAR:Z35	U005	50
B4783523	TORSION SPRING:PLATE:LEVER:F RONT	U005	51
B4783524	TORSION SPRING:PLATE:LEVER: BACK	U005	52
B4783553	BRACKET:FEELER:PAPER SENSE R	U005	53
B4783555	FEELER:PAPER SENSER	U005	54
B4783568	BRACKET:HOME POSITION SENS OR	U005	55
		U006	17

## Exclusive Parts

Number	Part Name	Group	ID
B4783569	SPACER	U004	9
		U005	56
B4783576	BRACKET:SENSOR:PAPER SENSE R	U005	57
B4783581	BRACKET:MICRO SWITCH	U005	58
B4783582	LEVER:MICRO SWITCH	U005	59
B4784132	SLIDER:VIBRATING PLATE	U003	79
B4784135	TIMING PULLEY:18T	U003	80
B4784256	TIMING PULLEY:20T-30T	U003	81
B4784257	TENSION SPRING:TIGHTENER	U003	82
B4784291	BRACKET:STAY:TIMING BELT	U003	83
B4786264	KEYTOP:PRINTING	U001	12
B5131154	PULLEY:T30:S2M	U004	10
B7001645	TIMING PULLEY:20T	U006	18
B7002145	BRACKET:ENTRANCE SENSOR	U002	40
B7002317	DISCHARGE BRUSH	U002	41
		U003	84
B7002476	COMPRESSION SPRING:EXIT:DRIVEN	U002	42
B7002520	CUSHION:GATE PAWL	U002	43
B7003115	WORM GEAR:37T	U006	19
		U008	30
B7003535	TIMING BELT:B40S2M116	U006	20
B7004107	SPRING:RETURN:STANDARD FENCE	U003	85
B7004428	TIMING BELT:B40S2M158	U005	60
B7004521	HOLDER:ARM:HARNESS	U003	86
B7004522	ARM:HARNESS:STAPLER UNIT	U003	87
B7004523	PIN:FIX:ARM	U003	88
B7005804	STEPPER MOTOR:DIA42:Z17:ASSY	U006	21
B7005811	STEPPER MOTOR:DC 25W	U006	22
B7031159	GUARD:FRAME	U003	89
B7031165	TIMING BELT:B40S2M390	U004	11
B7061143	BRACKET:SENSOR:PAPER	U008	31
B7061145	LEVER:SENSOR:UPPER	U008	32
B7061555	BRACKET:TIGHTENER	U006	23
		U008	33

Number	Part Name	Group	ID
B7062323	DISCHARGE BRUSH:L=320:MM3	U002	44
B7063035	GUIDE:MICRO SWITCH:SHIFT TRAY	U001	13
B7063126	SHIFT TRAY HOLDER	U005	61
B7063172	ACTUATOR BRACKET	U008	34
B7063271	TRAY SHIFT SHAFT	U005_S001	62
B7065600	PCB:SWITCH:STOP	U001	14
B7932154	RELEASE KNOB	U002	45
B8023756	DISCHARGE BRUSH:EXIT	U002	46
B8301135	SCREW	U002	47
		U003	90
		U006	24
		U008	35
B8301194	TONER HOPPER HOLDER	U008	36
B8301195	SPRING PLATE	U008	37
B8301444	DRIVE GUIDE PLATE - EXIT	U008	38
B8301447	WORM WHEEL GUIDE PLATE	U008	39
B8301448	BRACKET:STEPPER MOTOR:DRIVE:GUIDE PLATE	U008	40
B8301449	SHAFT - WORM WHEEL	U008	41
B8301451	WORM WHEEL - 16Z	U008	42
B8301455	BRACKET - HOME POSITION SENSOR	U008	43
B8301456	TIMING BELT - 40S2M190	U008	44
B8301458	LINK - EXIT ROLLER DRIVEN	U008	45
B8301459	COMPRESSION SPRING	U008	46
B8301531	STEPPER MOTOR BRACKET	U006	25
B8301532	TIMING PULLEY - 26T/17T	U006	26
B8301533	TIMING BELT - 60S3M171	U003	91
		U006	27
B8301534	TIMING BELT - 60S3M216	U003	92
		U006	28
B8302116	TENSION SPRING	U003	93
B8302126	LEVER CUSHION	U003	94
B8302131	GATHERING ROLLER LEVER	U003	95
B8302132	CAM - GATHERING ROLLER LEVER	U003	96
B8302141	TIMING BELT - 60S3M237	U003	97



## Exclusive Parts

Number	Part Name	Group	ID
B8302142	TIMING BELT - 60S3M162	U003	98
		U006	29
B8302327	EXIT GUIDE BRACKET	U002	48
B8302519	GEAR - 91Z	U006	30
B8302522	SENSOR BRACKET	U006	31
B8303162	GUARD:TRAY BRACKET - UPPER LOWER	U005	63
B8303315	ROLLER	U005_S001	64
B8303322	GUIDE:SHIFT TRAY:UPPER LOWE R	U005_S002	65
		U005_S003	65
B8303415	COVER - EXIT ROLLER	U005	66
B8303503	SPONGE GATHERING ROLLER	U005	67
B8303504	TIMING BELT - 40S2M100	U005	68
B8303505	TIMING BELT - 40S2M84	U005	69
B8303510	COUPLING LEVER BRACKET	U005	70
B8303520	GATHERING ROLLER SHAFT	U005	71
B8303561	STEPPER MOTOR BRACKET	U005	72
B8303579	LEVER CAM	U005	73
B8303587	STEPPER MOTOR BRACKET	U005	74
B8303611	FRAME - JOGGER UNIFORM	U004	12
B8303631	SLIDE SHAFT	U004	13
B8303641	JOGGER FENCE HOLDER - FRON T	U004	14
B8303646	JOGGER FENCE HOLDER - REAR	U004	15
B8303651	GEAR - 35Z	U004	16
B8303688	CUSHION:JOGGER FENCE	U003	99
		U004	17
B8303691	JOGGER FENCE:EXIT:GUIDE:FRO NT	U004	18
B8303692	JOGGER FENCE:EXIT:GUIDE:INNE R BACK	U004	19
B8303697	STEPPER MOTOR BRACKET	U004	20
B8303711	TENSIONER BRACKET	U004	21
B8303726	TIMING BELT - 40S2M848	U004	22
B8303751	TENSION SPRING	U004	23
B8304125	COMPRESSION SPRING	U003	100
B8304126	TENSION SPRING	U003	101
B8304213	GUIDE - STANDARD FENCE	U003	102

Number	Part Name	Group	ID
B8304214	STAPLER BASE	U003	103
B8304215	STAPLER COVER - FRONT	U003	104
B8304216	COVER - STAPLER HARNESS	U003	105
B8304221	STAPLER HOLDER	U003	106
B8304231	STAPLER HOLDER - MIDDLE	U003	107
B8304236	SLIDER:BASE:STAPLER:ASS'Y	U003	108
B8304245	BALL BEARING	U003	109
B8304249	SENSOR BRACKET	U003	110
B8304261	WORM GEAR	U003	111
B8304262	PULLEY - 19T	U003	112
B8304263	TIMING BELT - 60S2M140	U003	113
B8304271	GEAR - 166Z	U003	114
B8304275	KNOB	U003_S005	115
B8304281	LEVER BRACKET	U003	116
B8304284	STAPLER LEVER	U003	117
B8304285	TENSION SPRING	U003	118
B8304286	DC SOLENOID 24V	U003	119
B8304517	SLIDER HOOK BRACKET	U003	120
B8304518	SLIDER HOOK SHAFT	U003	121
B8304613	COVER - FRONT JOGGER FENCE	U003_S001	122
B8304623	COVER - REAR JOGGER FENCE	U003_S002	123
B8304884	TIMING BELT - 60S3M204	U003	124
		U006	32
B8305120	PCB OGGER	U004	24
B8305562	STEPPER MOTOR DC1.56V 3.7W	U003	125
		U006	33
B8305563	STEPPER MOTOR DC3.84V 9.2W	U005	75
B8305564	STEPPER MOTOR DC1.35V 4W	U003	126
B8305569	STEPPER MOTOR DC3.3V 3.9W	U004	25
B8305570	STEPPER MOTOR DC3.1V 7.4W	U004	26
		U005	76
B8305574	STEPPER MOTOR DC2.2V 5.7W	U003	127
B8305813	HARNESS BRACKET - UPPER	U007	4
B8307010	TONER HOPPER	U008_S001	47
B8307511	CONNECTING GUIDE PLATE - LO WER	U002	49
B8307516	GUIDE PLATE:CONNECTING:UPP ER	U002	50

## Exclusive Parts

Number	Part Name	Group	ID
B8307536	COUPLING BRACKET - CORRECT	U008	48
B8307537	ADJUSTING PLATE:BRACKET:COUPLING	U008	49
B8307709	DECAL - STAPLER UNIT (R10)	U003_S005	128
B8307712	DECAL - TONER HOPPER STAPLE	U008_S001	50
B8351181	COUPLING LEVER	U008	51
B8722515	CUSHION:BRACKET:FEED	U003	129
B8722614	BUSHING:R1	U003	130
B8891432	TIMING BELT:B60S3M771	U006	34
B8904094	TIMING BELT:B60S3M297	U005	77
C1012360	SNAP RING	U002	51
C2035135	BUSHING - 10X14X5.9	U005	78
D0747828	CAP:CONNECTOR	U001	15
D3551325	COVER:PUSH SWITCH	U008	52
D4341251	BRACKET:POSITIONING:STAPLER UNIT:UPPER	U008	53
D4341381	COVER:ENTRANCE:LOWER	U008	54
D4341431	BASE:HOLDER:HOPPER	U008	55
D4341436	COMPRESSION SPRING:HOLDER:HOPPER	U008	56
D4341450	BRACKET:GROUND PLATE:ASS'Y	U008_S003	57
D4341476	BRACKET:COUPLING:MAIN:ASS'Y	U008	58
D4341911	TIMING BELT:60S3M402	U006	35
D4341952	BRACKET:WORM GEAR:PRESSURE RELEASE:ASS'Y	U006	36
D4341956	CAM:ECCENTRIC:FRONT	U006	37
D4341957	CAM:ECCENTRIC:REAR	U006	38
D4341958	SHAFT:PRESSURE RELEASE	U006	39
D4342111	GUIDE PLATE:ENTRANCE:UPPER	U002	52
D4342115	TENSION SPRING:ENTRANCE:2N	U002	53
D4342121	GUIDE PLATE:REGISTRATION:OPEN AND CLOSE	U002	54
D4342125	SEAL:0.188MM:GUIDE PLATE:REGISTRATION	U002	55
D4342127	SUPPORTING PLATE:GUIDE PLATE:OPEN AND CLOSE	U002	56
D4342129	SUPPORTING PLATE:GUIDE PLATE:OPEN AND CLOSE	U002	56

Number	Part Name	Group	ID
D4342131	GUIDE PLATE:ENTRANCE:LOWER:ASS'Y	U002	57
D4342135	SEAL:0.1MM:GUIDE PLATE:ENTRANCE:LOWER	U002	58
D4342136	DISCHARGE BRUSH:EXIT	U002	46
D4342141	TRANSPORT ROLLER:380MM:ENTRANCE	U002	59
D4342211	GUIDE PLATE:HORIZONTAL:ASS'Y	U002	60
D4342222	TRANSPORT ROLLER:REGISTRATION:DRIVE	U002	123
D4342240	DRIVEN ROLLER:REGISTRATION:ASS'Y	U002_S001	62
D4342251	ARM:PRESSURE:DRIVEN ROLLER	U002	63
D4342261	HOLDER:DRIVEN ROLLER:REGISTRATION	U002	64
D4342266	BUSHING:DRIVEN ROLLER:REGISTRATION	U002	65
D4342311	GUIDE PLATE:GATE:FRONT:ASS'Y	U002	66
D4342326	GUIDE PLATE:GATE:UPPER:OPEN AND CLOSE	U002	67
D4342327	COMPRESSION SPRING:1.5N	U002	68
D4342331	GATE PAWL:STAPLE	U002	69
D4342341	GATE PAWL:PROOF TRAY	U002	70
D4342431	GUIDE PLATE:SHIFT TRAY:OPEN AND CLOSE:SUB-ASS'Y	U002_S011	71
D4342433	GUIDE PLATE:SHIFT TRAY:LOWER:FIX	U002	72
D4342437	COMPRESSION SPRING:2.5N	U002_S002 U002_S011	73 73
D4342451	SHAFT:GUIDE PLATE:EXIT:UPPER	U002	74
D4342456	GUIDE PLATE:EXIT:UPPER	U002	75
D4342458	EXIT ROLLER:DRIVEN:SHIFT TRAY:ASS'Y	U002_S012	76
D4342465	GUIDE PLATE:EXIT:STAPLE:ASS'Y	U002	77
D4342474	ROLLER:EXIT ROLLER:SHIFT	U002	78
D4342483	GUIDE PLATE:EXIT:LOWER:ASS'Y	U002	122
<b>D4342493</b>	<b>SHAFT:EXIT ROLLER</b>	<b>U002</b>	<b>79</b>
D4342511	TRANSPORT ROLLER:PROOF TRAY	U002	81

## Exclusive Parts

Number	Part Name	Group	ID
	Y:DRIVE		
D4342521	TRANSPORT ROLLER:PROOF TRAY:DRIVE:REAR	U002	82
D4342531	GUIDE PLATE:PROOF TRAY:OPEN AND CLOSE:SUB-ASS'Y	U002_S002	83
D4342535	TORSION SPRING:PROOF TRAY	U002	84
D4342547	GUIDE PLATE:PROOF TRAY:ASS'Y	U002	85
D4342551	EXIT ROLLER:DRIVEN:PROOF TRAY:ASS'Y	U002_S003	86
		U002_S004	86
D4342554	GUIDE PLATE:EXIT:PROOF TRAY	U002	87
D4342556	COMPRESSION SPRING:2N	U002	88
D4342561	BRACKET:PAPER FEED SENSOR:PROOF TRAY	U002	89
D4342576	EXIT ROLLER:PROOF TRAY:ASS'Y	U002_S005	90
D4342606	GUIDE PLATE:LENGTHWISE UPPER:OPEN AND CLOSE:ASS'Y	U002_S007	91
D4342607	GUIDE PLATE:LENGTHWISE LOWER:OPEN AND CLOSE:ASS'Y	U002_S008	92
D4342611	GUIDE PLATE:TURN:UPPER:OPEN AND CLOSE	U002	93
D4342612	MYLAR:GUIDE PLATE:TURN	U002	94
D4342613	DISCHARGE BRUSH:TURN	U002	95
D4342615	TENSION SPRING:TURN:6.3N	U002	96
D4342621	GUIDE PLATE:TURN:REAR	U002	97
D4342625	DISCHARGE BRUSH:TURN:REAR	U002	98
D4342630	POLARIZATION POWL:PRE STACK	U002_S006	99
D4342635	TENSION SPRING:POLARIZATION POWL:PRESSURE	U002	100
D4342641	GUIDE PLATE:DUPLEX STACK:UPPER	U002	101
D4342651	GUIDE PLATE:DUPLEX STACK:LOWER	U002	102
D4342665	COMPRESSION SPRING:6N	U002_S007	103
		U002_S008	103
		U003	131
D4342681	GUIDE PLATE:LENGTHWISE:ASS'Y	U002	104
D4342711	TRANSPORT ROLLER:TURN	U002	105

Number	Part Name	Group	ID
D4342721	DRIVEN ROLLER:DUPLEX STACK:UPPER	U002	106
D4342731	TRANSPORT ROLLER:DUPLEX STACK:UPPER	U002	107
D4342733	ARM:PRESSURE:TRANSPORT ROLLER	U002	108
D4342735	COMPRESSION SPRING:8N	U002	109
D4342739	LINK:PRESSURE RELEASE	U002_S009	110
		U002_S010	110
D4342741	TRANSPORT ROLLER:PRE STACK:LOWER	U002	111
D4343113	COMPRESSION SPRING:SHIFT TRAY:UPPER LOWER	U005	79
D4343116	TIMING PULLEY:WORM GEAR	U005	80
D4343125	SHAFT:UPPER LOWER:DRIVE	U005	81
D4343141	TIGHTENER:TRAY:ASS'Y	U005	82
D4343156	TIMING BELT:60S5M1595	U005	83
D4343216	BRACKET:SENSOR:SHIFT	U005	84
D4343241	TIMING PULLEY:SHIFT	U005	85
D4343242	SHAFT:SHIFT	U005	86
D4343273	BRACKET:MOTOR:SHIFT:ASS'Y	U005	87
D4343310	BASE:SHIFT TRAY:ASS'Y	U005_S001	88
D4343320	SIDE PLATE:SHIFT TRAY:FRONT:ASS'Y	U005_S002	89
D4343330	SIDE PLATE:SHIFT TRAY:REAR:ASS'Y	U005_S003	90
D4343405	STAY	U005	91
D4344106	STOPPER:STAPLER UNIT	U003	132
D4344116	BRACKET:CONNECTOR:STAPLER TRAY:MOVEABLE	U003	133
D4344126	BRACKET:CASTER	U003	134
D4344151	GUIDE PLATE:EXIT:LOWER:STAPLER TRAY	U003	135
D4344157	GUIDE PLATE:CONNECTING	U003	136
D4344162	BRACKET:PAPER FEED SENSOR:STAPLER TRAY	U003	137
D4344166	GUIDE PLATE:EXIT:STAPLE	U003	138
D4344171	STAY:GUIDE PLATE:EXIT:STAPLE	U003	139

## Exclusive Parts

Number	Part Name	Group	ID
D4344172	TORSION SPRING:STAPLE:EXIT	U003	140
D4344181	EXIT ROLLER:LOWER:SUB-ASS'Y	U003	141
D4344211	COVER:STAPLER:REAR	U003	142
D4344221	STAPLER TRAY:REAR	U003	143
D4344231	STAPLER TRAY:FRONT	U003	144
D4344246	GRIP:SLIDER:ASS'Y	U003_S004	145
D4344250	STAPLER TRAY:MIDDLE:ASS'Y	U003	146
D4344261	STANDARD FENCE:MOVEABLE	U003	147
D4344262	SLIDER:STANDARD FENCE:MOVEABLE	U003	148
D4344263	SHAFT:GUIDE:STANDARD FENCE:MOVEABLE	U003	149
D4344264	PULLEY:T18:T28	U003	150
D4344265	TIMING BELT:40S3M237	U003	151
D4344270	BRACKET:MOTOR:STANDARD FENCE	U003	152
D4344310	STAY:STANDARD FENCE	U003	153
D4344315	SHAFT:STANDARD FENCE:SLIDE:FRONT	U003	154
D4344316	SHAFT:STANDARD FENCE:SLIDE:REAR	U003	155
D4344317	BRACKET:SENSOR:EXIT BELT	U003	156
D4344318	BRACKET:SENSOR:PAWL:STOPPER	U003	157
D4344325	SLIDER:STANDARD FENCE:FRONT	U003	158
D4344327	STANDARD FENCE:FRONT:ASS'Y	U003	159
D4344335	SLIDER:STANDARD FENCE:REAR	U003	160
D4344345	SLIDER:STANDARD FENCE:AUXILIARY	U003	161
D4344347	STANDARD FENCE:REAR:AUXILIARY:ASS'Y	U003	162
D4344356	SHAFT:STAPLER:MOVE	U003	163
D4344361	HOOK:SLIDER:STANDARD FENCE:REAR	U003	164
D4344377	STANDARD FENCE:REAR:ASS'Y	U003	165
D4344414	STAY:STAPLER TRAY:MIDDLE:ASS'Y	U003	166

Number	Part Name	Group	ID
D4344415	TENSIONER:JOGGER FENCE:ASS'Y	U003	167
D4344419	TIMING BELT:60S3M552	U003	168
D4344451	SHAFT:JOGGER FENCE:SLIDE	U003	169
D4344467	GUIDE:SPRING PLATE:FRONT	U003_S001	170
D4344470	JOGGER FENCE:FRONT:ASS'Y	U003_S001	171
D4344472	GUIDE:PLATE:JOGGER:UPPER	U003_S001 U003_S002	172 172
D4344473	FILM:GUIDE:JOGGER:UPPER	U003_S001 U003_S002	173 173
D4344487	GUIDE:SPRING PLATE:REAR	U003_S002	174
D4344490	JOGGER FENCE:REAR:ASS'Y	U003_S002	175
D4344510	PAWL:STOPPER:ASS'Y	U003	176
D4344511	SHAFT:STOPPER:LEADING EDGE:DRIVE:ASS'Y	U003	177
D4344530	TENSIONER:STOPPER:LEADING EDGE:REAR	U003	178
D4344535	TENSIONER:STOPPER:LEADING EDGE:FRONT	U003	179
D4344539	TENSION SPRING:STOPPER:LEADING EDGE	U003 U008	180 59
D4344550	EXIT BELT:ASS'Y	U003	181
D4344553	SHAFT:EXIT:DRIVE	U003	182
D4344555	SHAFT:EXIT BELT:UPPER:ASS'Y	U003	183
D4344557	TIMING PULLEY:T19:S3M	U003	184
D4344561	BRACKET:SHAFT:EXIT:UPPER:ASS'Y	U003_S003	185
D4344565	TENSIONER:EXIT:ASS'Y	U003	186
D4344567	TIMING BELT:60S3M324	U003	187
D4344568	TIMING PULLEY:T30:S3M	U003	188
D4344569	TIMING PULLEY:EXIT BELT:T56	U003	189
D4344606	GUIDE:LEADING EDGE:FIX	U003	190
D4344621	BRACKET:POSITIONING ROLLER	U003	191
D4344622	ARM:POSITIONING ROLLER:ASS'Y	U003	192
D4344625	SHAFT:POSITIONING ROLLER:DRIVE	U003	193
D4344641	INNER COVER:POSITIONING ROLLER UNIT	U003	194

## Exclusive Parts

Number	Part Name	Group	ID
D4344653	SHAFT:VIBRATING PLATE:BOTH ENDS	U003	195
D4344655	SHAFT:VIBRATING PLATE:MIDDLE:UPPER	U003	196
D4344656	SHAFT:VIBRATING PLATE:MIDDLE:LOWER	U003	197
D4344660	VIBRATING PLATE:MIDDLE:UPPER:ASS'Y	U003	198
D4344662	VIBRATING PLATE:MIDDLE:LOWER	U003	199
D4344663	SLIDER:VIBRATING PLATE:MIDDLE	U003	200
D4344671	VIBRATING PLATE:BOTH ENDS	U003	201
D4344730	GUIDE PLATE:PRESSURE:TRANSPORT	U003	203
D4344731	TENSION SPRING:1.02N	U003	204
D4344736	TIMING BELT:60S3M192	U006	40
D4344756	TRANSPORT ROLLER:PRESSURE:INNER	U003	205
D4344757	GEAR:DRIVE:TRANSPORT ROLLER:PRESSURE	U003	206
D4344790	TENSION SPRING:10.5N	U005 U006	92 41
D4344801	LINK:PRESSURE SUB-UNIT:OPEN AND CLOSE	U003	207
D4344806	SHAFT:CAM:PRESSURE SUB-UNIT:OPEN AND CLOSE	U003	208
D4344856	GUIDE:TURN:MOVEABLE	U003	209
D4344857	TENSION SPRING:1.60N	U003	210
D4344861	SHAFT:GUIDE:ROLLER:TURN	U003	211
D4344862	GUIDE:ROLLER:TURN	U003	212
D4345565	BRACKET:LEAK BREAKER	U007	5
D4346102	INNER COVER:FRONT:UPPER	U001	16
D4346151	INNER COVER:FRONT:LOWER	U001	17
D4347700	DECAL:GUIDE PLATE:REGISTRATION:OPEN AND CLOSE:RB1	U002	112
D4347705	DECAL:REGISTRATION ROLLER:RB2	U002	113

Number	Part Name	Group	ID
D4347710	DECAL:GUIDE PLATE:GATE:OPEN AND CLOSE:RB3	U002	114
D4347715	DECAL:GUIDE PLATE:PROOF TRAY:OPEN AND CLOSE:RB4	U002_S002	115
D4347720	DECAL:GUIDE PLATE:SHIFT TRAY:OPEN AND CLOSE:RB5	U002_S011	116
D4347725	DECAL:GUIDE PLATE:LENGTHWISE UPPER:OPEN AND CLOSE:RB6	U002_S007	117
D4347730	DECAL:GUIDE PLATE:LENGTHWISE LOWER:OPEN AND CLOSE:RB7	U002_S008	118
D4347735	DECAL:PRE STACK:UPPER:RB8	U002	119
D4347740	DECAL:GUIDE PLATE:TURN:OPEN AND CLOSE:RB9	U001	18
D4347755	DECAL:STAPLER UNIT:PULL OUT:RB12	U003	213
D4347760	DECAL:GUIDE PLATE:STAPLE:OPEN AND CLOSE:RB13	U003	214
D4347785	DECAL:STAPLER UNIT:18RB	U003_S004	215
D4347790	DECAL:KNOB:STAPLER UNIT:RB19	U003_S004	216
D4347795	DECAL:STAPLER:S1	U003	217
D4347830	DECAL:H-TEMP WARNING:MOTOR:TRAILING EDGE:PLATE	U003	218
D4347835	DECAL:H-TEMP WARNING:MOTOR:SIDE PLATE:REAR	U003	219
D4477591	CUSHION:SPACER:440MM	U001	19
D5120110	DC STEPPER MOTOR:PLATE:1.79W:ASS'Y	U003_S009 U003_S010 U003_S011	220 220 220
D5120111	DC STEPPER MOTOR:2.26W:ASS'Y	U003_S006 U005_S004	221 93
D5120112	DC STEPPER MOTOR:JOGGER:7.92W:ASS'Y	U003	222
D5120113	DC STEPPER MOTOR:2.26W:ASS'Y	U003_S007 U003_S008	223 223
D5120114	DC STEPPER MOTOR:DRIVE:2.26W	U008_S002	60
D5123671	SHAFT:JOGGER FENCE:MOVEABLE	U004	27

## Exclusive Parts

Number	Part Name	Group	ID
	E		
D5123676	LEVER:DRIVE:JOGGER FENCE	U004	28
D5123681	JOGGER FENCE:FRONT:ASS'Y	U004	29
D5123686	JOGGER FENCE:INNER BACK:ASS'Y	U004	30
D5123731	COVER:UNIFORM UNIT:PAPER EXIT SUB-UNIT	U004	31
D5124372	GUIDE:FILM:STANDARD FENCE	U003	224
D5124373	FILM:GUIDE:FRONT	U003	225
D5124374	FILM:GUIDE:REAR	U003	226
D5124691	INNER COVER:SWING UNIT	U003	236
D5126068	STAY:REAR UPPER	U001	55
D5126220	DOOR:FRONT:ASS'Y	U001_S001	20
D5126223	SHAFT:PLATE:MAGNET CATCH	U001	21
D5126226	COVER:GRIP	U001	22
D5126227	LEVER:GRIP	U001	23
D5126228	PLATE:MAGNET CATCH	U001	24
D5126229	TENSION SPRING:GRIP	U001	25
D5126232	DOOR:FRONT:SMALL:RIGHT	U001	26
D5126240	HINGE:DOOR:UPPER:ASS'Y	U001_S002	27
D5126246	SHAFT:HINGE:DOOR	U001_S001	28
D5126247	HINGE:DOOR	U001_S001	29
D5126251	DOOR:FRONT:SMALL	U001	30
D5126260	HINGE:DOOR:LOWER:ASS'Y	U001_S003	31
D5126301	COVER:LEFT FRONT	U001	32
D5126351	COVER:LEFT UPPER	U001	33
D5126411	COVER:REAR UPPER:RIGHT	U001	34
D5126412	COVER:REAR UPPER:LEFT	U001	35
D5126421	COVER:REAR LOWER:RIGHT	U001	36
D5126422	COVER:REAR LOWER:LEFT	U001	37
D5126622	COVER:UPPER RIGHT	U001	38
D5126624	COVER:PROOF TRAY:ASS'Y	U001	39
D5126627	COVER:TRAY:LOWER	U001	40
		U001_S004	40
D5126629	COVER:UPPER REAR	U001	41
D5126711	COVER:SHIFT TRAY:FRONT	U001	42
D5126761	COVER:SHIFT TRAY:REAR	U001	43
D5127506	SHIFT TRAY:ASS'Y	U001_S004	44

Number	Part Name	Group	ID
D5127514	SHIFT TRAY:AUXILIARY:STACK	U001	45
D5127515	TRAY:AUXILIARY:LEADING EDGE	U001	46
D5127517	TAPE:SHIFT TRAY:MIDDLE	U001	47
D5127518	TAPE:SHIFT TRAY:OUTER	U001	48
D5127519	TAPE:SHIFT TRAY:AUXILIARY	U001	49
D5127522	TRAY:AUXILIARY:SHIFT TRAY	U001	50
D5127800	DECAL:CAUTION:HINGE:DOOR	U001	51
D5133263	END FENCE:3000:ASS'Y	U005	94
D5134091	COVER:SADDLE STAPLER UNIT:BIND:NO	U003	227
D5134732	PLAIN SHAFT BEARING:PRESSURE	U003	228
D5134741	SHAFT:DRIVE:TRANSPORT ROLLER:PRESSURE	U003	229
D5134807	CAM:PRESSURE SUB-UNIT:OPEN AND CLOSE	U003	230
D5134810	BRACKET:STOPPER:CAM:DRIVE:PRESSURE	U003	231
D5134811	TENSION SPRING:12N	U003	232
D5134876	CAM:GUIDE:TURN:BIND:NO	U003	233
D5135500	PCB:MAIN CONTROL:ASS'Y	U007	6
D5135515	PCB:SUB	U007	7
D5136501	COVER:LEFT LOWER	U001	52
D5137800	DECAL:COVER:STAPLER UNIT:VERTICAL TRANSPORT	U003	234
D5137805	DECAL:COVER:STAPLER UNIT:TURN	U003	235
D5137810	DECAL:MISFEED REMOVAL	U001	53
D5137815	DECAL:STAPLE EXCHANGE	U001	54
G0524892	DISCHARGE BRUSH:EXIT:SMALL	U005	95
G0605862	CAP - PSU	U007	8
G1594627	DISCHARGE BRUSH:REVERSE ROLLER	U002	120
GW010007	PHOTO REFLECTION SENSOR:EXIT	U002	121

## Standard Parts



03130040N  
SCREW:M3X4



03130080N  
PAN HEAD SCREW:M3X8



03530040N  
SCREW - M3X4



03530060N  
BIND SCREW - M3X6



03540140N  
SCREW M4X14



04503008N  
TAPPING SCREW - M3X8



04504008N  
TAPPING SCREW - M4X8



04513006N  
TAPPING SCREW - 3X6



04513008N  
TAPPING SCREW - M3X8



04513014N  
TAPPING SCREW:3X14



04514006N  
TAPPING SCREW - 4X6



04514010N  
TAPPING SCREW:4X10



04523008N  
TAPPING SCREW - M3X8



04533006N  
TAPPING SCREW - M3X6



04543006N  
TAPPING SCREW:ROUND P  
OINT:3X6



04543006Q  
TAPPING SCREW - M3X6



04543008Q  
TAPPING SCREW:3X8



04543012Q  
TAPPING SCREW:3X12



04544006Q  
TAPPING SCREW:4X6



04544008Q  
TAPPING SCREW - M4X8

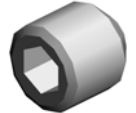

05740040E  
HEXAGON HEADLESS SET S  
CREW - M4X4



06320100G  
PIN - 2X10MM



06330120G  
PARALLEL PIN - 3X12



06330160G  
PARALLEL PIN - 3X16MM



06340200G  
PARALLEL PIN - 4X20

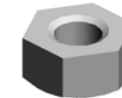

07100060N  
HEXAGONAL NUT - M6



07200030E  
RETAINING RING - M3



07200040E  
RETAINING RING - M4

## Standard Parts



07200060E  
RETAINING RING - M6



07403506  
BALL BEARING - 6X12X4 MM



07403906  
BALL BEARING - 6X15X5



07413506  
BALL BEARING - 6X12X4 MM



07413706  
BALL BEARING - 6X10X3



07423808  
BALL BEARING - 8X16X5



08046123  
HEXAGONAL BOLT:W/WASHER:M3X8



08050088  
RETAINING RING - M6



08050089  
RETAINING RING - M4



08050092  
RETAINING RING - 3M



08075056  
WASHER - 8.1MM



11050328  
HARNESS CLAMP - ES-0505



11050487  
HARNESS CLAMP



11050488  
HARNESS CLAMP



11050489  
HARNESS CLAMP - LWS 1316



11050508  
HARNESS CLAMP - LWS-0711

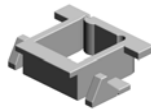

11050514  
EDGE SADDLE - EDS-0607L

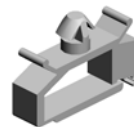

11050516  
CLAMP

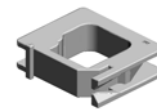

11050518  
EDGE SADDLE - LES-1010



11050521  
CLAMP - LES-1017



11050522  
EDGE SADDLE - LES0510



11050623  
CLAMP - LBWS-0206S-V0



11050717  
CLAMP:JDW-1S



11500377  
POWER SUPPLY CODE:250V :10A:EU



12042544  
SWITCH - DE2L-BJ23



12042842  
SWITCH:FA1L-CJAG



## Design Change List

Number	Title	Set	Old Part		New Part		Index No.		Q'ty	Interchg		Reason	Cut-in S/N
			P/N	Name	P/N	Name	Group	ID		Indiv.	Set		
201302-01	1302 Modification	-	AH012014	CASTER - 60KGF	AH012050	CASTER:STOPPER:NO	U003	63	1	O/O			D51327:
							U008	22	4				
201302-02	1302 Modification	-	D4342479	SHAFT:EXIT ROLLER	D4342493	SHAFT:EXIT ROLLER	U002	79	1	X/O			D51327:
201210-01	1210 Modification	-	D4342221	TRANSPORT ROLLER:REGISTRATION:DRIVE	D4342222	TRANSPORT ROLLER:REGISTRATION:DRIVE	U002	123	1	X/O			D51327:
201205-01	1205 Modification	-			D5126068	STAY:REAR UPPER	U001	55	2				D51327:
201205-02	1205 Modification	-	D5133261	END FENCE:3000:ASS'Y	D5133263	END FENCE:3000:ASS'Y	U005	94	1	X/O			D51327:
1109-01	201109Modification	-	D4342484	GUIDE PLATE:EXIT:LOWER:ASS'Y	D4342483	GUIDE PLATE:EXIT:LOWER:ASS'Y	U002	122	1	X/O			D51327:
1109-02	201109Modification	-	D4344691	INNER COVER:SWING UNIT	D5124691	INNER COVER:SWING UNIT	U003	236	1	X/O			D51327:
1109-03	201109Modification	-	B7067631	TRAY:AUXILIARY:SHIFT TRAY			ACCESSORIES	3	1			Replaced by [D5127522]	D51327:

