

D127/D128 POINT TO POINT DIAGRAM and HARNESS

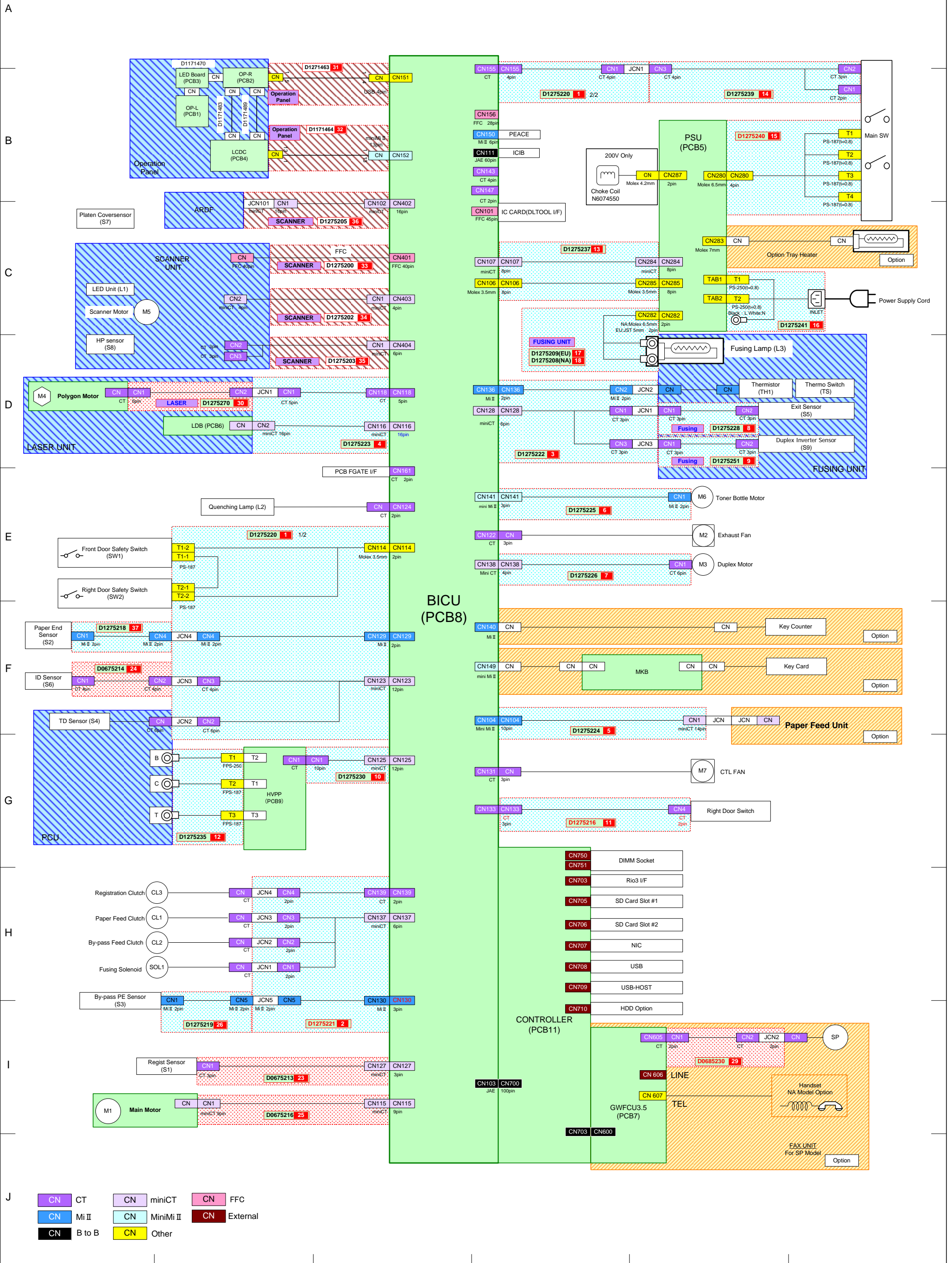

- J**
- | | | | | | |
|----|--------|----|-----------|----|----------|
| CN | CT | CN | miniCT | CN | FFC |
| CN | Mi II | CN | MiniMi II | CN | External |
| CN | B to B | CN | Other | | |

D606 (ARDF) POINT TO POINT DIAGRAM

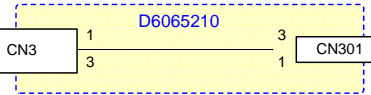
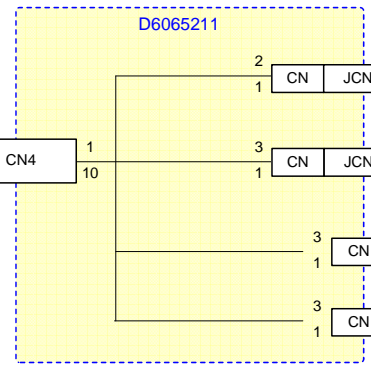
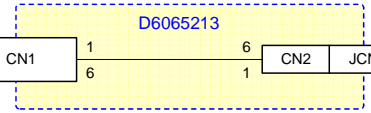
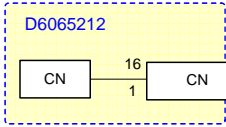
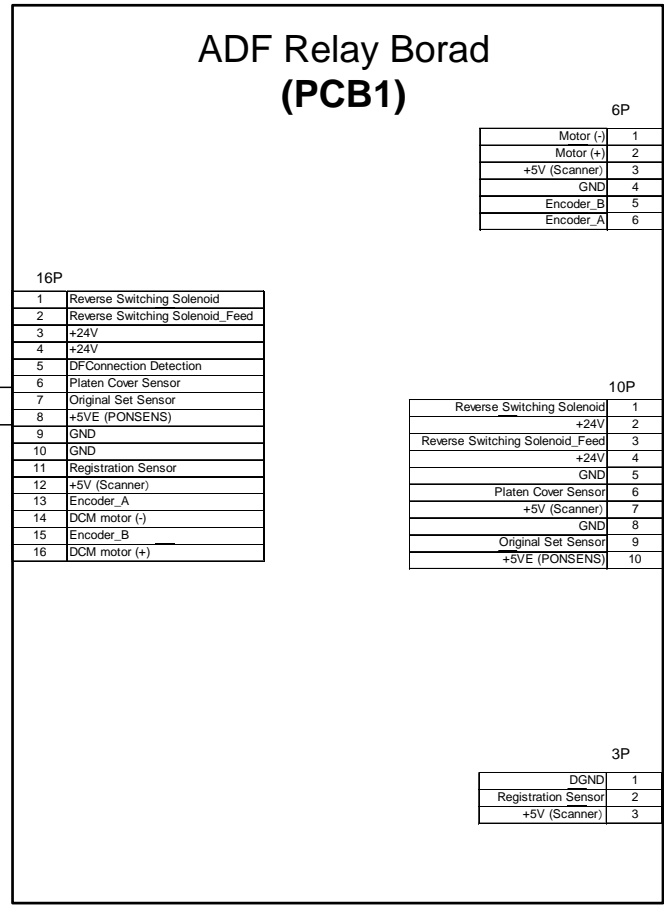

Main Machine

M1 ARDF Drive Motor

SOL1 ARDF Pick-up Solenoid

SOL2 ARDF Reverse Solenoid

S1 ADF Cover Sensor

S2 Original Set Sensor

S3 ARDF Registration Sensor

Harness No	Part No	FROM	J-CN	CN	Pin	Signal	Direction	Pin	CN	J-CN	TO
13	D127 5237	BICU CN107	-	CN107	1	N.C.	-	8	CN284	-	PSU CN284
					2	ZEROX	←	7			
					3	FUHT_ON	→	6			
					4	RY_ON_N	→	5			
					5	PONENG_N_PSU	→	4			
					6	GND	G	3			
					7	+24V_ON	Power	2			
					8	+24VSRLY	Power	1			
	BICU CN106	-	CN106	1	+24V	Power	1	CN285	-	PSU CN285	
				2	+24V	Power	2				
				3	GND	G	3				
				4	GND	G	4				
				5	GND	G	5				
				6	+5V	Power	6				
				7	+5VE	Power	7				
				8	+5VE	Power	8				
14	D127 5239	【1】D1275220 JCN1	-	CN3	1	REON_DC_N	→	2	CN1	-	SDSW (Sub)
					2	+5VE	PO	1			
					3	ACSWON_N	←	3			
					-	N.C.	-	2			
15	D127 5240	PSU CN280	-	CN280	1	AC-L	Power	T1	-	-	SDSW (Main)
					2	AC-N	Power	T2			
					3	AC-L-ON	Power	T3			
					4	AC-N-ON	Power	T4			
16	D127 5241	PSU Tab1	-	-	T1	L	Power	INLET-L	-	-	Power Supply Cord
		PSU Tab2			T2	N	Power	INLET-N			
		Metal Plate			T3	EARTH	G	INLET-E			
17	D127 5209	PSU CN282	-	CN282	1	MHT-L(HT1_L)	Power	T1	-	-	Fusing Lamp
					2	MHT-N(HT1_N)	Power	T2			
18	D127 5208	PSU CN282	-	CN282	1	MHT-L(HT1_L)	Power	T1	-	-	Fusing Lamp
					2	MHT-N(HT1_N)	Power	T2			
23	D067 5213	BICU CN127	-	CN127	1	GND	G	3	CN1	-	Regist Sensor
					2	REG_SNS_N	←	2			
					3	+5V	Power	1			
24	D067 5214	【1】D1275220 JCN3	-	CN2	1	FB_PSNS	←	4	CN1	-	ID Sensor
					2	PSNS_LED	→	3			
					3	GND	G	2			
					4	+5V	Power	1			
25	D067 5216	BICU CN115	-	CN115	1	MT_CLK	→	9	CN1	-	Main Motor
					2	MT_BK	→	8			
					3	MT_DR	→	7			
					4	MT_ST	→	6			
					5	MT_LOCK	←	5			
					6	GND	G	4			
					7	GND	G	3			
					8	+24VS	Power	2			
					9	+24VS	Power	1			
26	D129 5219	【2】D1295221 CN5	JCN5	CN5	1	GND	G	2	CN	-	By-pass Feed PE Sensor
					2	MU_PE	←	1			
29	D068 5230	GWFCU3 CN605	-	CN1	1	MONSP	→	2	CN2	JCN2	SP
					2	GND	G	1			
30	D127 5270	【4】D1275223 JCN1	-	CN2	1	+24V	Power	5	CN1	-	Polygon Motor
					2	GND	G	4			
					3	PMON_N	→	3			
					4	PMRDY_N	←	2			
					5	PMCLK	→	1			
31	D127 1485	BICU CN151	-	-	1	+5VE_LPS	Power	1	CN6	-	Operation Panel
					2	OPE_USB_M	←/→	2			
					3	OPE_USB_P	←/→	3			
					4	GND	G	4			

Harness No	Part No	FROM	J-CN	CN	Pin	Signal	Direction	Pin	CN	J-CN	TO
32	D127 1486	BICU CN152	-	-	1	GND	G	13	CN2	JCN2	Operation Panel
					2	GND	G	12			
					3	POKLVDS	→	11			
					4	LDET_IN_N_OPU	←	10			
					5	ENG_ENABLE_N_OP	→	9			
					6	PONENG_N_OPU	→	8			
					7	PW_SW_N	←	7			
					8	POKUSB	→	6			
					9	OPE_CTLERR_N_OP	→	5			
					10	+5VE_LPS	Power	4			
					11	+5VE_LPS	Power	3			
					12	+5VE_LPS	Power	2			
					33	D127 5200	BICU CN401	-			
2	GND	G	39								
3	+24V	Power	38								
4	+24V	Power	37								
5	+5V_SCN	Power	36								
6	+5V_SCN	Power	35								
7	GND	G	34								
8	VIDEO_R	←	33								
9	GND	G	32								
10	VIDEO_G	←	31								
11	GND	G	30								
12	VIDEO_B	←	29								
13	GND	G	28								
14	+3.3V	Power	27								
15	+3.3V	Power	26								
16	XSW	→	25								
17	GND	G	24								
18	XCP-	→	23								
19	XCP+	→	22								
20	GND	G	21								
21	XRS+	→	20								
22	XRS-	→	19								
23	GND	G	18								
24	XPH2-	→	17								
25	XPH2+	→	16								
26	GND	G	15								
27	XPH1+	→	14								
28	XPH1-	→	13								
29	XCN_SBU	←	12								
30	XSH	→	11								
31	XSHC	→	10								
32	CCD_ON	→	9								
33	+24V	Power	8								
34	+24V	Power	7								
35	LED_CTL5	←	6								
36	LED_CTL4	←	5								
37	LED_CTL3	←	4								
38	LED_CTL2	←	3								
39	LED_CTL1	←	2								
40	GND	G	1								
34	D127 5202	BICU CN403	-	CN1	1	FB_B	←/→	4	CN2	-	Scanner Unit
					2	FB_A	←/→	3			
					3	FB_B	←/→	2			
					4	FB_A	←/→	1			
35	D127 5203	BICU CN404	-	CN1	1	GND	G	3	CN3	-	Scanner Unit
					2	XAKS_SENS	←	2			
					3	+5VE_Z	Power	1			
					4	GND	G	3	CN2	-	Scanner Unit
					5	HPS_SENS	←	2			
					6	+5V_SCN	Power	1			

Harness No	Part No	FROM	J-CN	CN	Pin	Signal	Direction	Pin	CN	J-CN	TO
36	D127 5205	BICU CN402	-	CN102	1	REV_SOL	←	16	CN1	CN10	ARDF
					2	FEED_SOL	←	15			
					3	+24V	Power	14			
					4	+24V	Power	13			
					5	XDF_SET	←	12			
					6	XCOV_SENS	←	11			
					7	XDOC_SENS	←	10			
					8	+5VE_Z	Power	9			
					9	GND	G	8			
					10	GND	G	7			
					11	XREG_SENS	←	6			
					12	+5V_SCN	Power	5			
					13	ENC_A	←	4			
					14	OUT1_B	←/→	3			
					15	ENC_B	←	2			
					16	OUT1_A	←/→	1			
37	D127 5218	【1】D1275220 JCN4	-	CN4	1	GND	G	2	CN1	-	PE Sensor
					2	F1_PE	←	1			

D127/D128 ELECTRICAL COMPONENT LAYOUT

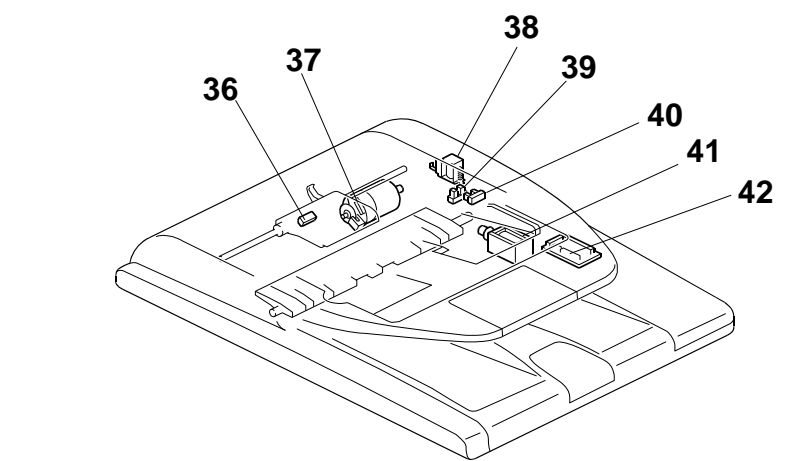
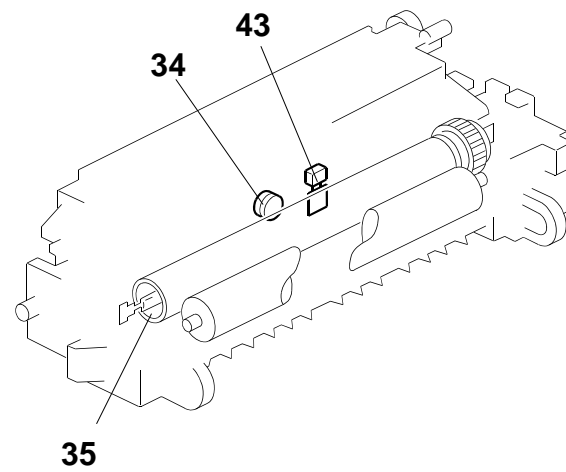
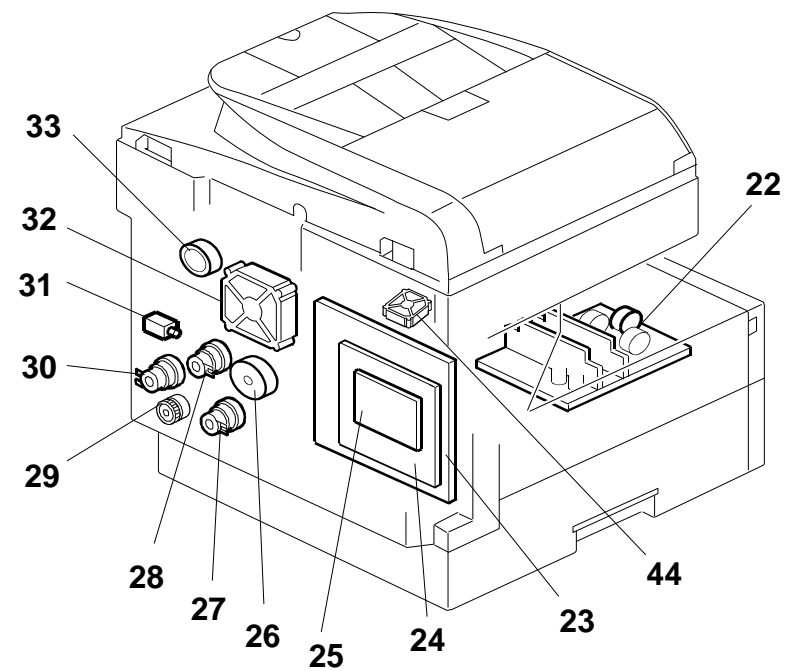
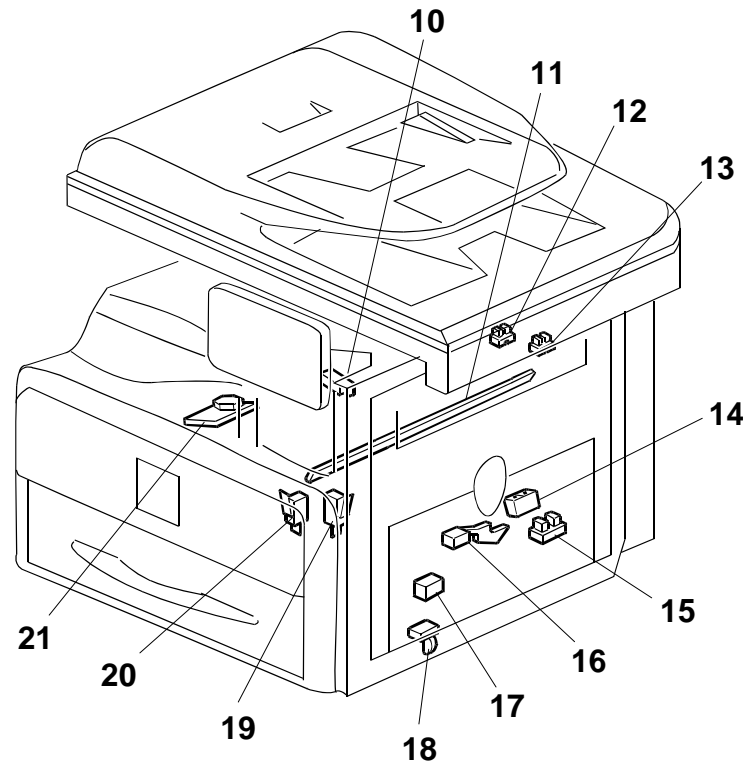
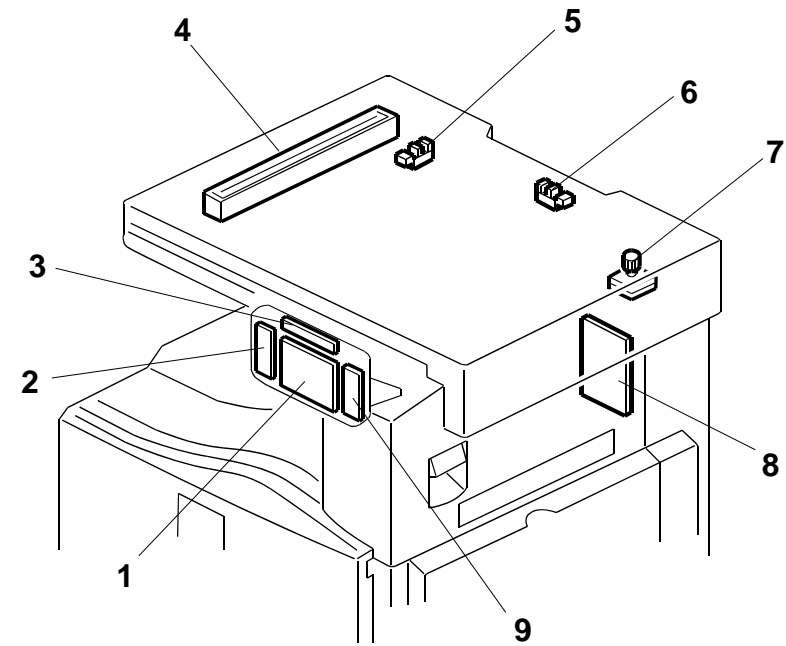

Symbol	Index No.	Name	P-to-P
Sensors			
S1	15	Registration	I-2
S2	16	Paper End	F-1
S3	18	By-pass Paper End	H-1
S4	17	TD (Toner Density)	F-1
S5	12	Paper Exit	D-56
S6	14	ID (Image Density)	F-1
S7	6	Platen Cover	C-1
S8	5	Scanner HP	D-1
S9	13	Duplex Inverter	D-56
Switches			
SW1	20	Front Door Safety	E-1
SW2	19	Right Door Safety	E-1
PCBs			
PCB1	2	Operation Panel L	B-2
PCB2	9	Operation Panel R	B-2
PCB3	3	LED Board	B-2
PCB4	1	LCDC	B-2
PCB5	22	PSU	BC-5
PCB6	10	LD Unit	D-2
PCB7	25	FCU	IJ-45
PCB8	23	BICU	BJ-34
PCB9	8	HVPP	G-2
PCB11	24	Controller	HI-4
Lamps			
L1	4	LED Unit	C-1
L2	11	Quenching (LED)	E-2
L3	35	Fusing	D-5

Symbol	Index No.	Name	P-to-P
Motors			
M1	26	Main	I-1
M2	32	Exhaust Fan	E-5
M3	33	Duplex	E-5
M4	21	Polygon Mirror	D-1
M5	7	Scanner	C-1
M6	29	Toner Bottle Motor	E-5
M7	44	CTL Fan	G-5
Clutches			
CL1	27	Paper Feed	H-1
CL2	30	Bypass Feed	H-1
CL3	28	Registration	H-1
Others			
TH1	43	Thermistor	D-5
SOL1	31	Fusing Solenoid	H-1
TS	34	Thermo Switch	D-5

Symbol	Index No.	Name	P-to-P
ARDF (Option for D127EU)			
S1	40	ARDF Cover	E-8
S2	39	Original Set	E-8
S3	36	ARDF Registration	F-8
SOL1	38	Pick-up Solenoid	D-9
SOL2	41	Reverse Solenoid	D-9
PCB1	42	ARDF Relay	BF-36
M1	37	ARDF Drive	C-9

D661 (PFU) POINT TO POINT DIAGRAM and HARNESS

A

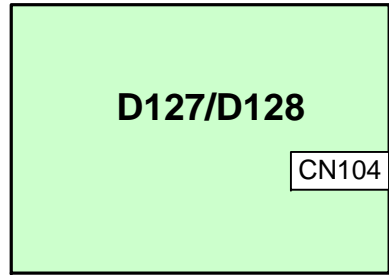

CN104 CN104

CN200

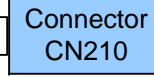

CN200

CN100

CN100

1

D6615300

CN102

CN102

CN220



Paper Feed Motor

3

D6615320

B

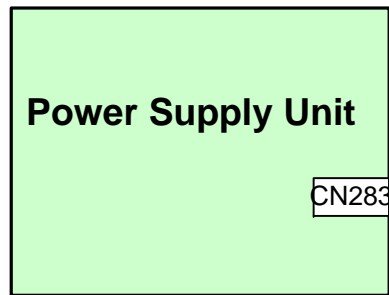

CN283

CN1

CN2

CN3

CN4



Anticondensation Heater (Option)

6

D6615350

7

D6615370

CN103

CN103

CN230

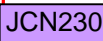

JCN230

CN



Paper Feed Clutch

4

D6615330

C



CN100

CN100

CN200

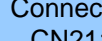

CN201

CN101

CN101

2

D6615310

CN104

CN104



Fan Motor (M2)

D

CN105

CN105

CN250

Paper Feed Sensor (S1)

CN251

Paper End Sensor (S2)

CN252

Door Switch (SW1)

5

D6615340

E

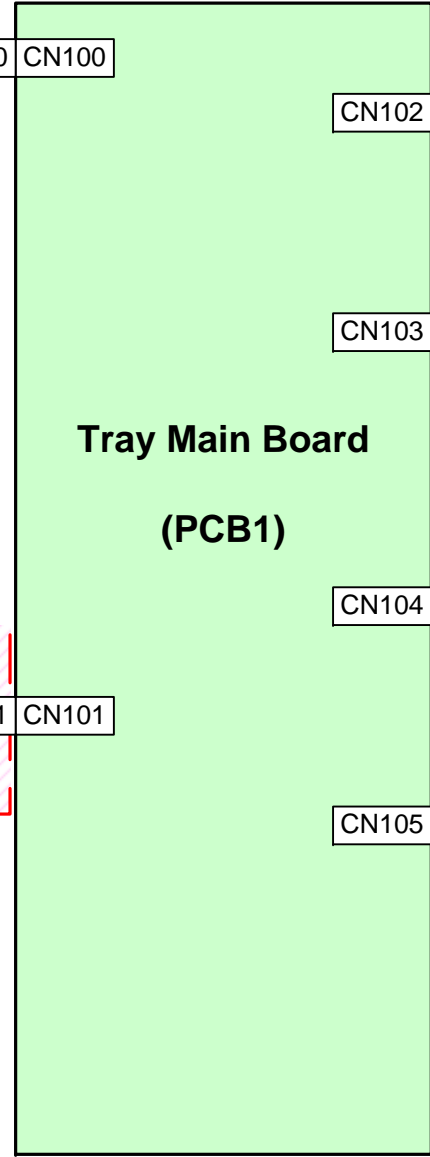

1

2

3

4

D661 Harness Pin Assign

Harness No	Part No	FROM			Signal Direction	TO		
		CN	Unit/CN	Pin No		CN	Unit/CN	Pin No
1	D6615300	CN100	Main PCB CN100	10	TXD2→	CN200	D127/D128 CN104	1
				9	←RXD2			2
				8	S_GND			3
				7	+5V			4
				6	P_GND			5
				5				6
				4				7
				3	+24V			8
				2				9
				1				10
2	D6615310	CN101	Main PCB CN101	1	←LP_RXD3	CN201	Lower Paper Tray Unit CN100	14
				2	LP_TXD3→			13
				3	S_GND			12
				4	+5V			11
				5	P_GND			10
				6				9
				7				8
				8	+24V			7
				9				6
				10				5
3	D6615320	CN102	Main PCB CN102	1	PFM_A	CN220	Paper Feed Motor	5
				2	PFM +24V			4
				3	PFM_AB			3
				4	PFM_B			2
				6	PFM_BB			1
4	D6615330	CN103	Main PCB CN103	1	+24V	CN230	Paper Feed Clutch	2
				2	FEED CL			1
		CN104	Main PCB CN104	1	+24V		Fan Motor	
				2	N.C.			
				3	FAN_M			
5	D6615340	CN105	Main PCB CN105	1	S_GND	CN250	Paper Feed Sensor	3
				2	PF_SIGNAL			2
				3	+5V			1
				4	S_GND	CN251	Paper End Sensor	3
				5	PE_SIGNAL			2
				6	+5V		1	
				7	S_GND	CN252	Door Switch	2
				8	DS_SIGNAL			1
6	D6615350	CN1	PSU CN283	1	HEATER(L)	CN2	Anticondensation Heater (Option)	1
				2	HEATER(N)			2

D661 ELECTRICAL COMPONENT LAYOUT

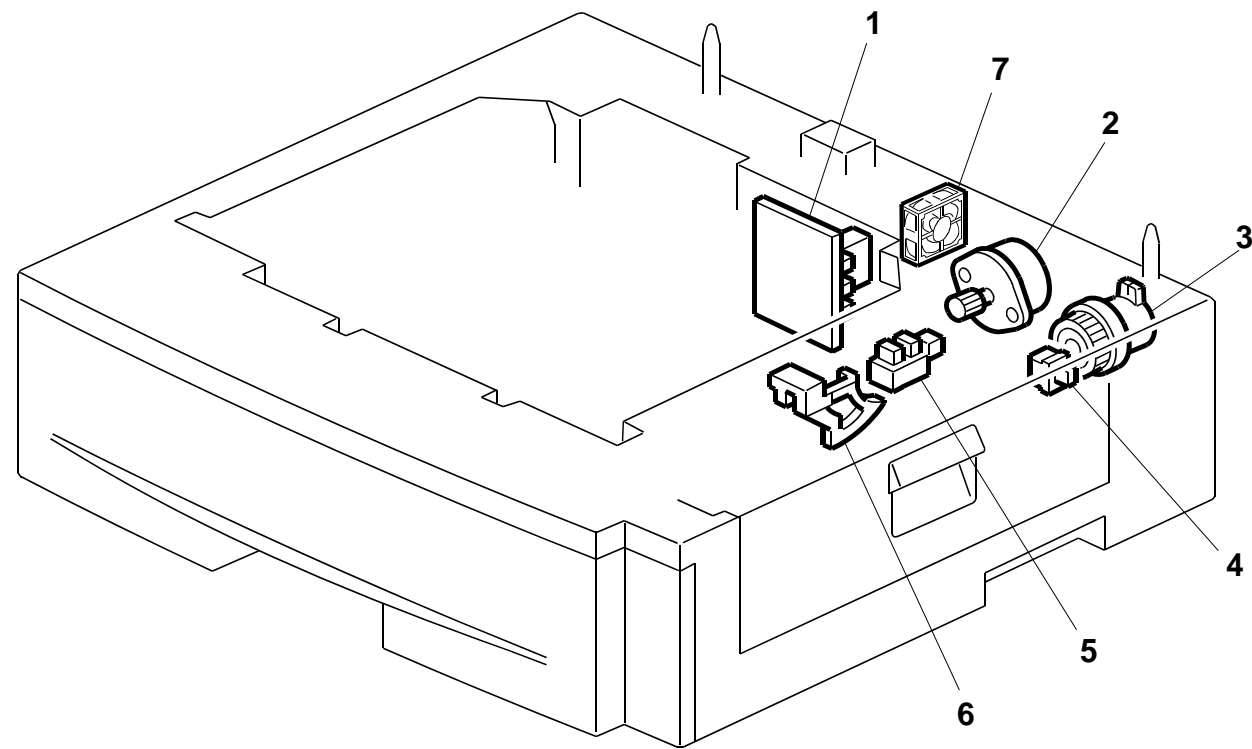

Symbol	Index No.	Name	P-to-P
PFU (Option)			
PCB1	1	Tray Main Board	CDB-3
M1	2	Paper Feed Motor	B-4
M2	7	FAN Motor	C-4
CL1	3	Paper Feed Clutch	B-4
S1	5	Paper Feed Sensor	D-4
S2	6	Paper End Sensor	D-4
SW1	4	Door Switch	D-4